

ACCESORIOS FILPRESS AISI-316L - PERFIL F
 FILPRESS PRESSFITTINGS AISI-316L - PROFILE F
 FILPRESS RACCORDS À SERTIR EN ACIER INOXYDABLE AISI-316L
 FILPRESS PRESSFITTINGS AUS EDELSTAHL 1.4404 FÜR DÜNNWANDIGE EDELSTAHLROHRE - PRESSKONTUR F

ACCESORIOS INSTALPRESS AISI-316L - PERFIL M
 INSTALPRESS PRESSFITTINGS AISI-316L - PROFILE M
 INSTALPRESS RACCORDS À SERTIR EN ACIER INOXYDABLE AISI-316L
 INSTALPRESS PRESSFITTINGS AUS EDELSTAHL 1.4404 FÜR DÜNNWANDIGE EDELSTAHLROHRE - PRESSKONTUR M



ACCESORIOS ACERO AL CARBONO - PERFIL M
 STEEL ZINC PLATED PRESSFITTINGS - M PROFILE
 RACCORDS À SERTIR EN ACIER GALVANISÉ
 C-STAHLE PRESSFITTINGS - PRESSKONTUR M

ACCESORIOS ACERO AL CARBONO FIREPRESS - PERFIL M
 FIREPRESS STEEL ZINC PLATED PRESSFITTINGS - M PROFILE
 FIREPRESS RACCORDS À SERTIR EN ACIER GALVANISÉ
 FIREPRESS C-STAHLE PRESSFITTINGS - PRESSKONTUR M

JUNTAS
 O-RINGS
 JOINTS
 DICHTUNG

MÁQUINAS DE PRENSAR
 PRESS MACHINES
 MACHINES PRESSER
 PRESSMASCHINEN

ACCESORIOS CAPILARES AISI-316
 CAPILLARY FITTINGS AISI-316
 ACCESSOIRES CAPILLAIRES - AISI-316
 LÖTFITTINGS 1.4401

ABRAZADERAS
 PIPE CLAMPS
 COLLIERS DE FIXATION
 ROHRSCHELLEN

VÁLVULAS AISI-316
 VALVES AISI-316
 BOISSEAUX AISI-316
 KUGELHÄHNE EDELSTAHL 1.4401

ACCESORIOS ROSCADOS DIN-2999 AISI-316
 THREADED FITTINGS DIN-2999 AISI-316
 ACCESSOIRES FILETÉS DIN-2999 AISI-316
 GEWINDEFITTINGE DIN-2999 1.4401

ACCESORIOS DE COMPRESIÓN DIN-2353 AISI-316
 COMPRESSION FITTINGS DIN-2353 AISI-316
 RACCORDS À COMPRESSION DIN-2353 AISI-316
 SCHNEIDRINGVERSCHRAUBUNGEN DIN-2353 1.4401

MANUAL TÉCNICO PRESSFITTINGS INSTALPRESS
 PRESSFITTINGS INSTALPRESS TECHNICAL MANUAL

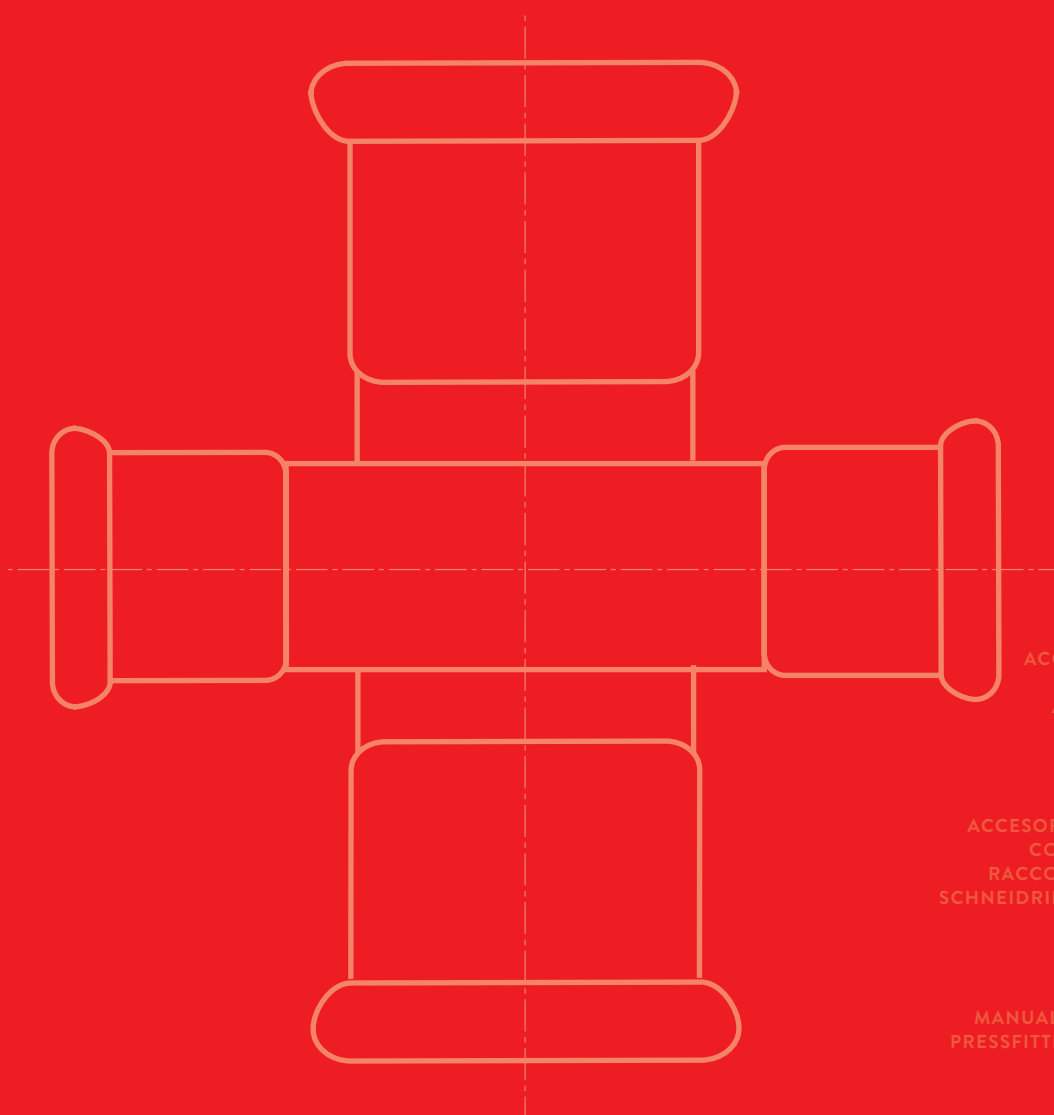

TUBO GALVANIZADO (INT/EXT) EN 10305-3 • GALVANIZED BOTH SIDES CS PIPE EN 10305-3 • TUBE ÉLECTROZINGUÉ INTÉRIEUR - EXTÉRIEUR EN 10305-3 • DÜNNWANDIGES C-STAHLRÖHR - INNEN UND AUSSEN VERZINKT NACH EN 10305-3



Ref.	Ø x Espesor / Thickness / Épaisseur / Dicke	Largo / Length / Longueur / Länge (mm)	Peso / Weight / Poids / Gewicht (+/-) Kg/m	M / Paquete M / Bundle M / Bundle M / Bündel
F03001000	12 x 1,2	6.000	0,416	624
F03001010	15 x 1,2	6.000	0,408	1.290
F03001025	18 x 1,2	6.000	0,497	1.524
F03001030	22 x 1,2	6.000	0,616	1.290
F03001050	28 x 1,5	6.000	0,980	960
F03001070	35 x 1,5	6.000	1,239	762
F03001090	42 x 1,5	6.000	1,498	762
F03001110	54 x 1,5	6.000	1,942	366
F03001150	76,1 x 2,0	6.000	3,655	222
F03001170	88,9 x 2,0	6.000	4,286	198
F03001190	108,0 x 2,0	6.000	5,228	162

TUBO GALVANIZADO (1 CARA EXTERIOR) EN 10305-3 • GALVANIZED OUTSIDE CS PIPE EN 10305-3 • TUBE ÉLECTROZINGUE À L'EXTÉRIEUR EN 10305-3 • DÜNNWANDIGES C-STAHLRÖHR - AUSSEN VERZINKT NACH EN 10305-3



Ref.	Ø x Espesor / Thickness / Épaisseur / Dicke	Largo / Length / Longueur / Länge (mm)	Peso / Weight / Poids / Gewicht (+/-) Kg/m	M / Paquete M / Bundle M / Bundle M / Bündel
03001000	12 x 1,2	6.000	0,360	624
03001010	15 x 1,2	6.000	0,410	1.836
03001025	18 x 1,2	6.000	0,520	1.524
03001030	22 x 1,2	6.000	0,640	1.290
03001050	28 x 1,5	6.000	1,000	960
03001070	35 x 1,5	6.000	1,300	366
03001090	42 x 1,5	6.000	1,520	366
03001110	54 x 1,5	6.000	1,950	366
03001150	76,1 x 2,0	6.000	3,620	222
03001170	88,9 x 2,0	6.000	3,620	222
03001190	108,0 x 2,0	6.000	5,300	114

CURVA 90° HH • BEND 90° PRESS X PRESS • COUDE 90° FF • BOGEN 90° II

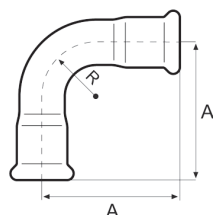

Ref.	Ø	A	Peso / Weight / Poid / Gewicht Kg	U. /
07450297	12 x 12	42	0,040	10
07450300	15 x 15	41	0,047	10
07450302	18 x 18	45	0,058	10
07450305	22 x 22	49	0,078	10
07450310	28 x 28	59	0,112	10
07450315	35 x 35	72	0,175	4
07450320	42 x 42	91	0,246	2
07450325	54 x 54	110	0,395	2
07450330	76,1 x 76,1	150	0,977	1
07450335	88,9 x 88,9	174	1,324	1
07450340	108,0 x 108,0	215	1,991	1

CURVA 90° HM • BEND 90° Ø X PRESS • COUDE 90° FM • BOGEN 90° IA

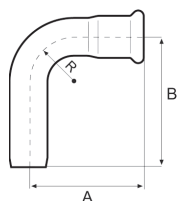

Ref.	Ø	A	B	Peso / Weight / Poid / Gewicht Kg	U. /
07450468	12 x 12	42	48	0,035	10
07450350	15 x 15	41	49	0,047	10
07450470	18 x 18	45	53	0,058	10
07450355	22 x 22	49	59	0,080	10
07450360	28 x 28	59	69	0,113	10
07450365	35 x 35	72	83	0,175	4
07450370	42 x 42	91	96	0,250	2
07450375	54 x 54	110	116	0,392	1
07450476	76,1 x 76,1	150	166	0,991	1
07450477	88,9 x 88,9	174	190	1,329	1
07450478	108,0 x 108,0	215	230	1,988	1

CURVA 45° HH • BEND 45° PRESS X PRESS • COUDE 45° FF • BOGEN 45° II

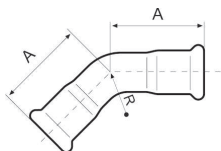

Ref.	Ø	A	Peso / Weight / Poid / Gewicht Kg	U. /
07450520	12 x 12	32	0,034	10
07450525	15 x 15	30	0,039	10
07450527	18 x 18	31	0,047	10
07450530	22 x 22	35	0,063	10
07450535	28 x 28	41	0,090	10
07450540	35 x 35	56	0,150	4
07450545	42 x 42	63	0,201	2
07450550	54 x 54	75	0,304	2
07450555	76,1 x 76,1	98	0,800	1
07450560	88,9 x 88,9	113	1,034	1
07450565	108,0 x 108,0	138	1,550	1

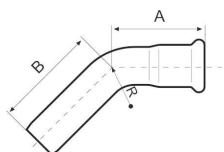
CURVA 45° HM • BEND 45° Ø X PRESS • COUDE 45° FM • BOGEN 45° IA

Ref.	Ø	A	B	Peso / Weight / Poid / Gewicht Kg	U. /
07450570	12 x 12	32	41	0,032	10
07450575	15 x 15	30	42	0,039	10
07450577	18 x 18	31	35	0,047	10
07450580	22 x 22	35	47	0,066	10
07450585	28 x 28	41	47	0,090	10
07450590	35 x 35	36	66	0,153	4
07450595	42 x 42	63	70	0,202	2
07450600	54 x 54	75	82	0,316	2
07450605	76,1 x 76,1	98	119	0,800	1
07450610	88,9 x 88,9	113	130	1,054	1
07450615	108,0 x 108,0	138	160	1,580	1

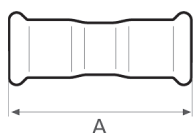
MANGUITO HH • STRAIGHT COUPLING PRESS X PRESS • MANCHON FF • MUFFE II

Ref.	Ø	A	Peso / Weight / Poid / Gewicht Kg	U. /
07450000	12 x 12	42	0,030	10
07450005	15 x 15	52	0,036	10
07450007	18 x 18	52	0,045	10
07450010	22 x 22	59	0,060	10
07450015	28 x 28	61	0,077	10
07450020	35 x 35	72	0,103	4
07450025	42 x 42	79	0,142	2
07450030	54 x 54	90	0,202	2
07450035	76,1 x 76,1	142	0,619	1
07450040	88,9 x 88,9	163	0,817	1
07450045	108,0 x 108,0	192	1,204	1

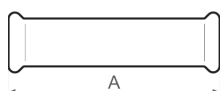
MANGUITO SIN TOPE • SLEEVE COUPLING PRESS X PRESS • MANCHON COULISSANT FF • SCHIEBEMUFFE II

Ref.	Ø	A	Peso / Weight / Poid / Gewicht Kg	U. /
07450220	12 x 12	56	0,040	10
07450225	15 x 15	75	0,051	10
07450227	18 x 18	77	0,060	10
07450230	22 x 22	86	0,081	10
07450235	28 x 28	92	0,112	10
07450240	35 x 35	99	0,136	10
07450245	42 x 42	119	0,203	4
07450250	54 x 54	145	0,280	4
07450255	76,1 x 76,1	230	0,875	1
07450260	88,9 x 88,9	262	1,200	1
07450265	108,0 x 108,0	304	1,705	1

MANGUITO COMPRESIÓN • STRAIGHT ADAPTER PRESS X COMPRESSION • ADAPTATEUR COMPRESSION • ÜBERGANGSMUFFE MIT SCHNEIDRINGVERSCHRAUBUNG

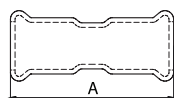

Ref.	Ø	A	Peso / Weight / Poid / Gewicht Kg	U. /
07451150	15 x 15	61	0,068	10
07451155	22 x 22	65	0,099	5
07451160	28 x 28	66	0,120	5

TE IGUAL • T-COUPLING 3 X PRESS • TÉ ÉGAL TARAUDÉ • T-STÜCK

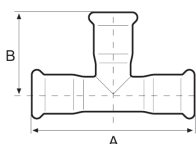

Ref.	Ø	A	B	Peso / Weight / Poid / Gewicht Kg	U. /
07450620	12 x 12 x 12	56	35	0,048	10
07450625	15 x 15 x 15	74	36	0,067	10
07450627	18 x 18 x 18	80	37	0,082	10
07450630	22 x 22 x 22	82	43	0,109	10
07450635	28 x 28 x 28	92	46	0,144	4
07450640	35 x 35 x 35	102	55	0,189	2
07450645	42 x 42 x 42	118	60	0,270	2
07450650	54 x 54 x 54	142	73	0,396	1
07450655	76,1 x 76,1 x 76,1	232	121	1,150	1
07450660	88,9 x 88,9 x 88,9	262	126	1,600	1
07450665	108,0 x 108,0 x 108,0	312	152	2,319	1

TE ROSCADA • T-COUPLING PRESS X FEMALE X PRESS • TÉ TARAUDÉ • T-STÜCK IG

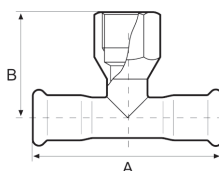

Ref.	Ø	A	B	Peso / Weight / Poid / Gewicht Kg	U. /
07450800	15 x 1/2" x 15	74	38	0,082	10
07450802	18 x 1/2" x 18	80	39	0,095	10
07450806	18 x 3/4" x 18	71	35	0,105	10
07450805	22 x 1/2" x 22	82	42	0,113	10
07450824	22 x 3/4" x 22	82	43	0,120	10
07450826	28 x 3/4" x 28	92	45	0,159	4
07450815	35 x 1/2" x 35	102	48	0,176	4
07450827	35 x 3/4" x 35	102	48	0,191	2
07450820	42 x 1/2" x 42	118	46	0,250	2
07450828	42 x 3/4" x 42	118	51	0,255	1
07450825	54 x 1/2" x 54	142	58	0,333	1
07450841	54 x 2" x 54	142	85	-	1
07450829	54 x 3/4" x 54	142	59	0,350	1
07450830	76,1 x 3/4" x 76,1	232	69	0,950	1
07450842	76,1 x 2" x 76,1	232	98	-	1
07450835	88,9 x 3/4" x 88,9	262	76	1,240	1
07450843	88,9 x 2" x 88,9	262	100	-	1
07450840	108,0 x 3/4" x 108,0	312	86	1,830	1
07450844	108,0 x 2" x 108,0	312	112	-	1

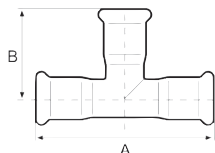
TE REDUCIDA • T-COUPLING REDUCTION 3 X PRESS • TÉ RÉDUIT • T-STÜCK REDUZIERT

Ref.	Ø	A	B	Peso / Weight / Poid / Gewicht Kg	U. /
07450670	12 x 15 x 12	38	38	0,052	10
07450671	15 x 12 x 15	33	33	0,063	10
07450672	15 x 18 x 15	36	36	0,071	10
07450675	15 x 22 x 15	42	42	0,084	10
07450706	18 x 12 x 18	34	34	0,074	10
07450707	18 x 15 x 18	35	35	0,078	4
07450708	18 x 22 x 18	45	45	0,094	4
07450690	22 x 15 x 15	43	43	0,083	2
07450709	22 x 15 x 22	40	40	0,098	2
07450712	22 x 18 x 22	40	40	0,100	1
07450695	22 x 22 x 15	48	48	0,097	1
07450685	22 x 28 x 22	45	45	0,123	1
07450715	28 x 15 x 28	42	42	0,126	1
07450717	28 x 18 x 28	43	43	0,128	1
07450700	28 x 22 x 22	43	43	0,130	1
07450720	28 x 22 x 28	46	46	0,135	1
07450705	28 x 28 x 22	53	53	0,125	1
07450725	35 x 15 x 35	45	45	0,159	1
07450727	35 x 18 x 35	45	45	0,160	1
07450730	35 x 22 x 35	48	48	0,169	10
07450735	35 x 28 x 35	50	50	0,178	10
07450739	42 x 18 x 42	52	52	0,228	10
07450740	42 x 22 x 42	54	54	0,233	10
07450745	42 x 28 x 42	53	53	0,239	10
07450750	42 x 35 x 42	57	57	0,254	4
07450754	54 x 18 x 54	54	54	0,354	4
07450755	54 x 22 x 54	56	56	0,360	2
07450760	54 x 28 x 54	59	59	0,339	2
07450765	54 x 35 x 54	64	64	0,350	1
07450770	54 x 42 x 54	68	68	0,378	1
07450771	76,1 x 22 x 76,1	68	68	0,986	1
07450773	76,1 x 28 x 76,1	71	71	0,956	1
07450776	76,1 x 35 x 76,1	75	75	0,968	1
07450777	76,1 x 42 x 76,1	79	79	0,981	1
07450775	76,1 x 54 x 76,1	80	80	1,050	1
07450781	88,9 x 22 x 88,9	76	76	1,256	1
07450782	88,9 x 28 x 88,9	75,5	75,5	1,244	1
07450783	88,9 x 35 x 88,9	83	83	1,267	1
07450778	88,9 x 42 x 88,9	85	85	1,271	1
07450779	88,9 x 54 x 88,9	93	93	1,297	1
07450780	88,9 x 76,1 x 88,9	128	128	1,500	1
07450784	108,0 x 22 x 108,0	85	85	1,838	1
07450786	108,0 x 28 x 108,0	88	88	1,939	1
07450787	108,0 x 35 x 108,0	94	94	1,955	1
07450797	108,0 x 42 x 108,0	96	96	1,886	1
07450795	108,0 x 54 x 108,0	102	102	1,967	1
07450790	108,0 x 76,1 x 108,0	125	125	2,147	1
07450785	108,0 x 88,9 x 108,0	135	135	2,184	1

BRIDA ADAPTADOR • FLANGE WITH PRESS-JOINT • BRIDE À BOUT LISSE • FLANSCH MIT PRESSMUFFE

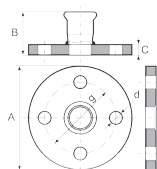

Ref.	Ø	A	B	C	Peso / Weight / Poid / Gewicht Kg	U. /
07450940	22	105	63	16	0,661	1
07450941	28	115	67	16	0,814	1
07450942	35	140	72	18	1,314	1
07450934	42	150	80	18	1,523	1
07450936	54	165	98	18	1,721	1
07450937	76,1	185	125	18	3,593	1
07450938	88,9	200	145	20	4,615	1
07450939	108,0	220	120	20	5,135	1

UNIÓN MACHO • STRAIGHT ADAPTER MALE X PRESS • RACCORD FILETÉ • ÜBERGANG AG

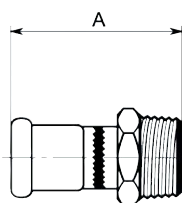

Ref.	Ø	A	Peso / Weight / Poid / Gewicht Kg	U. /
07450050	12 x 3/8"	36	0,038	10
07450055	15 x 3/8"	43	0,041	10
07450060	15 x 1/2"	43	0,055	10
07450057	18 x 1/2"	44	0,065	10
07450065	22 x 1/2"	44	0,075	10
07450070	15 x 3/4"	43	0,087	10
07450072	18 x 3/4"	44	0,079	10
07450075	22 x 3/4"	44	0,095	10
07450080	28 x 3/4"	49	0,101	10
07450085	22 x 1"	44	0,154	10
07450090	28 x 1"	49	0,107	10
07450095	35 x 1"	54	0,149	4
07450100	35 x 1 1/4"	54	0,169	4
07450093	35 x 1 1/2"	54	0,172	4
07450105	42 x 1 1/4"	59	0,241	4
07450110	42 x 1 1/2"	59	0,226	4
07450115	54 x 2"	69	0,368	2
07450120	76,1 x 2 1/2"	123	0,830	1
07450125	88,9 x 3"	134	1,160	1
07450130	108 x 4"	156	2,005	1

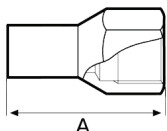
UNIÓN HEMBRA • STRAIGHT ADAPTER FEMALE X PRESS • RACCORD TARAUDÉ • ÜBERGANG IG

Ref.	Ø	A	Peso / Weight / Poid / Gewicht Kg	U. /
07450145	12 x 1/2"	35	0,045	10
07450150	15 x 1/2"	37	0,070	10
07450151	15 x 3/4"	38	0,071	10
07450152	18 x 1/2"	37	0,057	10
07450157	18 x 3/4"	38	0,075	10
07450155	22 x 1/2"	37	0,087	10
07450160	22 x 3/4"	40	0,080	10
07450165	22 x 1"	43	0,114	10
07450168	28 x 3/4"	45	0,139	10
07450170	28 x 1"	43	0,119	10
07450172	35 x 1"	45	0,130	4
07450175	35 x 1 1/4"	73	0,300	4
07450180	42 x 1 1/2"	75	0,270	4
07450185	54 x 2"	85	0,360	2

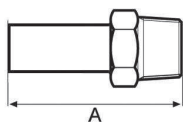
ADAPTADOR MACHO • STRAIGHT ADAPTER MALE X Ø • EMBOUT FILETÉ • ÜBERGANGSVERSCHRAUBUNG A/AG

Ref.	Ø	A	Peso / Weight / Poid / Gewicht Kg	U. /
07450900	15 x 1/2"	57	0,070	10
07450902	18 x 1/2"	57	0,074	10
07450905	15 x 3/4"	57	0,110	10
07450907	18 x 3/4"	59	0,103	10
07450910	22 x 3/4"	59	0,015	10

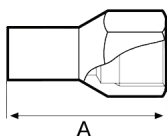
ADAPTADOR HEMBRA • STRAIGHT ADAPTER FEMALE X Ø • EMBOUT TARAUDÉ • ÜBERGANG A/IG

Ref.	Ø	A	Peso / Weight / Poid / Gewicht Kg	U. /
07450870	12 x 1/2"	58	0,060	10
07450875	15 x 1/2"	61	0,060	10
07450877	18 x 1/2"	61	0,062	10
07450882	18 x 3/4"	64	0,091	10
07450880	22 x 1/2"	61	0,065	10
07450885	22 x 3/4"	65	0,093	10

REDUCCIÓN MH • STRAIGHT COUPLING REDUCTION Ø X PRESS • REDUCTION MF • REDUZIERMUFFE IA

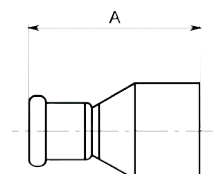

Ref.	Ø	A	Peso / Weight / Poid / Gewicht Kg	U. /
07451055	15 x 12	51	0,026	10
07451060	18 x 12	53	0,032	10
07451065	18 x 15	55	0,036	10
07451070	22 x 12	60	0,039	10
07451075	22 x 15	60	0,042	10
07451077	22 x 18	57	0,044	10
07451080	28 x 15	81	0,062	10
07451082	28 x 18	84	0,068	10
07451085	28 x 22	70	0,067	10
07451090	35 x 15	84	0,084	5
07451092	35 x 18	87	0,090	5
07451095	35 x 22	76	0,095	10
07451100	35 x 28	74	0,087	4
07451104	42 x 18	98	0,180	4
07451105	42 x 22	87	0,177	4
07451110	42 x 28	100	0,128	4
07451115	42 x 35	78	0,115	4
07451119	54 x 18	108	0,190	2
07451120	54 x 22	110	0,185	2
07451125	54 x 28	100	0,185	2
07451130	54 x 35	129	0,206	2
07451135	54 x 42	108	0,189	2
07451137	76,1 x 42	151	0,425	1
07451139	76,1 x 54	145	0,454	1
07451141	88,9 x 54	157	0,591	1
07451143	88,9 x 76,1	157	0,660	1
07451144	108,0 x 54	204	0,880	1
07451145	108,0 x 76,1	196	0,948	1
07451147	108,0 x 88,9	192	0,962	1

RACOR 2 PIEZAS CON JUNTA PLANA • JOINT CONNECTOR FEMALE X PRESS • ÉCROU TOURNANT JOINT FLAT •
ÜBERGANGSMUFFE IG - FLACHDICHTENDA/IG

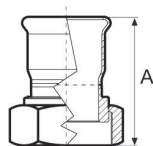

Ref.	Ø	A	Peso / Weight / Poid / Gewicht Kg	U. /
07450270	15 x 3/4"	37	0,069	10
07450272	18 x 3/4"	39	0,070	10
07450275	22 x 1"	40	0,084	5
07450280	28 x 1 1/4"	44	0,156	5
07450285	35 x 1 1/2"	48	0,194	3
07450290	42 x 1 3/4"	52	0,234	2
07450295	54 x 2 3/8"	58	0,405	2

RACOR 3 PIEZAS MACHO • STRAIGHT MALE UNION CONNECTOR • RACCORD UNION FILETÉ • ÜBERGANGSVERSCHRAUBUNG AG

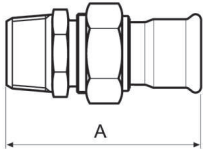

Ref.	Ø	A	Peso / Weight / Poid / Gewicht Kg	U. /
07451750	15 x 1/2"	61	0,138	10
07451755	15 x 3/4"	63	0,124	10
07451760	18 x 1/2"	64	0,136	10
07451765	18 x 3/4"	66	0,122	10
07451770	22 x 1/2"	67	0,228	5
07451775	22 x 3/4"	68	0,212	5
07451780	22 x 1"	73	0,208	5
07451785	28 x 1"	75	0,402	4
07451790	35 x 1 1/4"	80	0,486	4
07451795	42 x 1 1/2"	85	0,608	4
07451800	54 x 2"	97	0,828	4

RACOR 3 PIEZAS HEMBRA • STRAIGHT FEMALE UNION CONNECTOR • RACCORD UNION TARAUDÉ • ÜBERGANGSVERSCHRAUBUNG IG

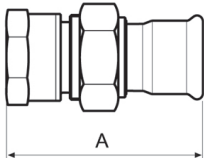

Ref.	Ø	A	Peso / Weight / Poid / Gewicht Kg	U. /
07451700	15 x 1/2"	59	0,176	10
07451710	18 x 1/2"	59	0,174	10
07451720	22 x 3/4"	63	0,196	5
07451725	22 x 1"	66	0,234	5
07451730	28 x 1"	71	0,416	6
07451735	35 x 1 1/4"	77	0,494	6
07451740	42 x 1 1/2"	82	0,564	4
07451745	54 x 2"	95	1,006	1

CURVA ROSCADA MACHO • THREADED BEND 90° MALE X PRESS • COUDE FILETÉ TARAUDÉ 90° • GEWINDEBOGEN 90° AG

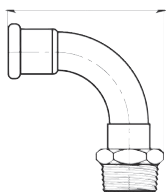

Ref.	Ø	A	B	Peso / Weight / Poid / Gewicht Kg	U. /
07450395	12 x 3/8"	42	34	0,053	10
07450400	15 x 3/8"	41	39	0,062	10
07450405	15 x 1/2"	41	40	0,070	10
07450407	18 x 1/2"	45	48	0,070	10
07450408	22 x 1/2"	58	65	0,116	10
07450410	22 x 3/4"	49	54	0,106	10
07450415	28 x 1"	59	68	0,180	4
07450420	35 x 1 1/4"	72	102	0,259	4
07450425	42 x 1 1/2"	91	116	0,375	2
07450430	54 x 2"	110	142	0,670	1

CODO MACHO • ELBOW TRANSITION MALE X PRESS • COUDE FILETÉ • WINKEL 90° AG

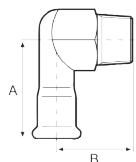

Ref.	Ø	A	B	Peso / Weight / Poid / Gewicht Kg	U. /
07450850	15 x 3/8"	34	23	0,082	10
07450855	15 x 1/2"	34	28	0,095	10
07450857	18 x 1/2"	36	26	0,110	10
07450860	22 x 3/4"	39	36	0,189	10

CODO MACHO ESCUADRA • ELBOW TRANSITION MALE X PRESS • COUDE FILETÉ • WINKEL 90° AG

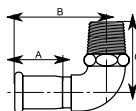

Ref.	Ø	A	B	Peso / Weight / Poid / Gewicht Kg	U. /
07450467	15 x 1/2"	42	38	0,097	10
07450469	18 x 1/2"	44	38	0,118	10
07450471	22 x 3/4"	45	47	0,162	10

CODO HEMBRA ESCUADRA • ELBOW TRANSITION FEMALE X PRESS • COUDE TARAUDÉ • WINKEL 90° IG

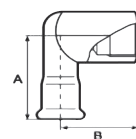

Ref.	Ø	A	B	Peso / Weight / Poid / Gewicht Kg	U. /
07450461	15 x 1/2"	41	40	0,094	10
07450462	18 x 1/2"	41	40	0,102	10
07450463	22 x 3/4"	46	42	0,159	10
07450464	28 x 1/2"	52	47	0,258	10
07450466	28 x 1"	52	47	0,229	10

CURVA ROSCADA HEMBRA • THREADED BEND 90° FEMALE X PRESS • COUDE FILETÉ TARAUDÉ 90° • GEWINDEBOGEN 90° IG

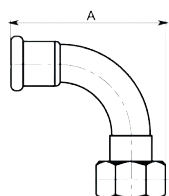

Ref.	Ø	A	B	Peso / Weight / Poid / Gewicht Kg	U. /
07450450	15 x 1/2"	44	41	0,074	10
07450452	18 x 1/2"	51	45	0,084	10
07450453	22 x 1/2"	-	-	-	10
07450455	22 x 3/4"	56	49	0,119	10
07450460	28 x 1"	65	77	0,219	4
07450465	35 x 1 1/4"	72	102	0,256	4

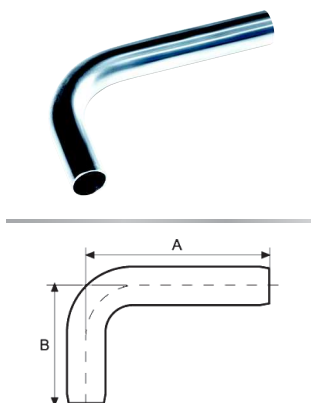
CURVA DE AJUSTE 90° • BEND 90° Ø X Ø • COUDE D'AJUSTEMENT 90° • PASSBOGEN 90° AA

Ref.	Ø	A	B	Peso / Weight / Poid / Gewicht Kg	U. /
07450479	12 x 12	70	120	0,072	10
07450480	15 x 15	70	120	0,088	10
07450482	18 x 18	70	120	0,103	10
07450485	22 x 22	70	120	0,132	10
07450490	28 x 28	97	125	0,190	4
07450495	35 x 35	121	201	0,359	2
07450500	42 x 42	160	254	0,553	1
07450505	54 x 54	202	302	0,877	1

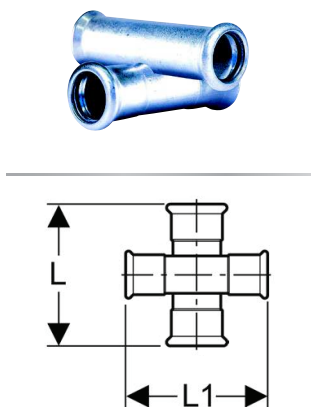
CRUZ REDUCIDA • CROSSOVER COUPLING 4 X PRESS • CROIX REDUCTION • KREUZSTÜCK 90°

Ref.	Ø	L	L1	Peso / Weight / Poid / Gewicht Kg	U. /
07450950	15 x 15 x 15 x 15	74	74	0,100	10
07450956	18 x 15 x 18 x 15	74	82	0,110	10
07450955	22 x 15 x 22 x 15	74	80	0,130	10
07450957	22 x 18 x 22 x 18	80	82	0,140	10
07450960	28 x 18 x 28 x 18	80	92	0,148	5
07450961	42 x 28 x 42 x 28	116	113	0,286	1
07450958	76,1 x 28 x 76,1 x 28	150	232	1,054	1
07450959	88,9 x 28 x 88,9 x 28	153	263	1,400	1

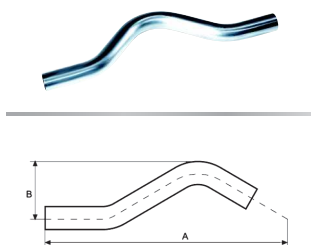
SALTATUBOS • BY-PASS BEND Ø X Ø • DIVERSION COURBE MM • SPRUNGBOGEN AA

Ref.	Ø	A	Peso / Weight / Poid / Gewicht Kg	U. /
07450920	12 x 12	154	0,090	10
07450925	15 x 15	145	0,110	10
07450927	18 x 18	157	0,155	10
07450930	22 x 22	175	0,159	10
07450935	28 x 28	226	0,335	4

TAPÓN • ENDCAP PRESS • BOUCHON • VERSCHLUßKAPPE

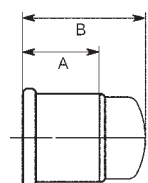

Ref.	Ø	A	Peso / Weight / Poid / Gewicht Kg	U. /
07450975	15	38	0,027	20
07450977	18	41	0,035	20
07450980	22	42	0,045	10
07450985	28	46	0,062	10
07450990	35	51	0,079	4
07450995	42	59	0,123	4
07451000	54	73	0,179	2
07451005	76,1	95	0,361	1
07451010	88,9	115	0,495	1
07451015	108,0	130	0,707	1

TUBO DE TRANSICIÓN • WELD-ON PIPE • TUBE À SOUDER • ANSCHWEIßROHR

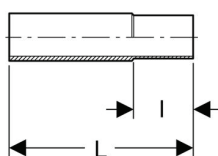

Ref.	Ø	L	I	Peso / Weight / Poid / Gewicht Kg	U. /
07451025	17,2 / 15 x 1,2	120	30	0,077	10
07451027	21,3 / 18 x 1,2	120	30	0,092	5
07451030	26,9 / 22 x 1,5	120	34	0,131	5
07451035	33,7 / 28 x 1,5	120	34	0,210	3
07451040	38 x 35	120	40	0,255	4
07451045	44,5 x 42	120	45	0,307	2
07451050	57 x 54	120	50	0,375	1
07451057	80,5 x 76,1	120	70	0,500	1
07451062	94,9 x 88,9	120	75	0,659	1
07451067	114,0 x 108,0	120	90	0,880	1

**CONEXIÓN RANURADA • TRANSITION JOINT FOR GROOVED FITTINGS • RACCORD TARAUDÉ •
ÜBERGANGSVERSCHRÄUBUNG FÜR GENUTETE FITTINGS**

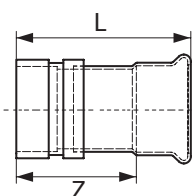

Ref.	Ø	L	Z	Peso / Weight / Poid / Gewicht Kg	U. /
07451600	28 x 33,7	74	50	0,154	5
07451605	35 x 42,4	79	52	0,211	5
07451610	42 x 48,3	86	54	0,267	5
07451615	54 x 60,3	99	62	0,368	5
07451620	76,1 x 76,1	108	53	0,807	1
07451625	88,9 x 88,9	119	56	0,980	1
07451630	108,0 x 108,0	128	51	1,060	1