

ACCESORIOS FILPRESS AISI-316L - PERFIL F
FILPRESS PRESSFITTINGS AISI-316L - PROFILE F
FILPRESS RACCORDS À SERTIR EN ACIER INOXYDABLE AISI-316L
FILPRESS PRESSFITTINGS AUS EDELSTAHL 1.4404 FÜR DÜNNWANDIGE EDELSTAHLROHRE - PRESSKONTUR F



ACCESORIOS INSTALPRESS AISI-316L - PERFIL M
INSTALPRESS PRESSFITTINGS AISI-316L - PROFILE M
INSTALPRESS RACCORDS À SERTIR EN ACIER INOXYDABLE AISI-316L
INSTALPRESS PRESSFITTINGS AUS EDELSTAHL 1.4404 FÜR DÜNNWANDIGE EDELSTAHLROHRE - PRESSKONTUR M

ACCESORIOS ACERO AL CARBONO - PERFIL M
STEEL ZINC PLATED PRESSFITTINGS - M PROFILE
RACCORDS À SERTIR EN ACIER GALVANISÉ
C-STAHLE PRESSFITTINGS - PRESSKONTUR M

ACCESORIOS ACERO AL CARBONO FIREPRESS - PERFIL M
FIREPRESS STEEL ZINC PLATED PRESSFITTINGS - M PROFILE
FIREPRESS RACCORDS À SERTIR EN ACIER GALVANISÉ
FIREPRESS C-STAHLE PRESSFITTINGS - PRESSKONTUR M

JUNTAS
O-RINGS
JOINTS
DICHTUNG

MÁQUINAS DE PRENSAR
PRESS MACHINES
MACHINES PRESSER
PRESSMASCHINEN

ACCESORIOS CAPILARES AISI-316
CAPILLARY FITTINGS AISI-316
ACCESSOIRES CAPILLAIRES - AISI-316
LÖTFITTINGS 1.4401

ABRAZADERAS
PIPE CLAMPS
COLLIERS DE FIXATION
ROHRSCHELLEN

VÁLVULAS AISI-316
VALVES AISI-316
BOISSEAUX AISI-316
KUGELHÄHNE EDELSTAHL 1.4401

ACCESORIOS ROSCADOS DIN-2999 AISI-316
THREADED FITTINGS DIN-2999 AISI-316
ACCESSOIRES FILETÉS DIN-2999 AISI-316
GEWINDEFITTINGE DIN-2999 1.4401

ACCESORIOS DE COMPRESIÓN DIN-2353 AISI-316
COMPRESSION FITTINGS DIN-2353 AISI-316
RACCORDS À COMPRESSION DIN-2353 AISI-316
SCHNEIDRINGVERSCHRAUBUNGEN DIN-2353 1.4401

MANUAL TÉCNICO PRESSFITTINGS INSTALPRESS
PRESSFITTINGS INSTALPRESS TECHNICAL MANUAL



TUBO SANITARIO EN-10312 (AISI-304L) • SANITARY PIPE EN-10312 (AISI-304L) • TUBE SANITAIRE EN-10312 (AISI-304L) • SANITÄR-ROHR EN-10312 (EDELSTAHL 1.4307)



Tubo Brillante Pickled Pipe Tube Standard Standar Rohr Ref.	Tubo Pulido Mirror Polished Pipe Tube Poli Miroir Poliertes Rohr Ref.	Ø x Espesor / Thickness / Épaisseur / Dicke	Largo / Length / Longeur / Länge (mm)	Peso / Weight / Poid / Gewicht (+/-) Kg/m	Presión de Trabajo / Working Pressure / Pression de Service / Arbeitsdruck Kg/cm
10210X06	102P10X06	10 x 0,6	5.000	0,141	133
10212X06	102P12X06	12 x 0,6	5.000	0,171	111
10215X06	102P15X06	15 x 0,6	5.000	0,216	88
10218X07	102P18X07	18 x 0,7	5.000	0,303	86
10222X07	102P22X07	22 x 0,7	5.000	0,373	70
10228X08	102P28X08	28 x 0,8	5.000	0,545	63
10235X10	102P35X10	35 x 1,0	5.000	0,851	63
10242X12	102P42X12	42 x 1,2	5.000	1,226	63
10254X12	102P54X12	54 x 1,2	5.000	1,587	49
122761X20	122P761X20	76,1 x 2,0	6.000	3,711	58
122889X20	122P889X20	88,9 x 2,0	6.000	4,352	49
122108X20	122P108X20	108,0 x 2,0	6.000	5,308	41

TUBO SANITARIO EN-10312 (AISI-316L) • SANITARY PIPE EN-10312 (AISI-316L) • TUBE SANITAIRE EN-10312 (AISI-316L) • SANITÄR-ROHR EN-10312 (EDELSTAHL 1.4404)



Tubo Brillante Pickled Pipe Tube Standad Standar Rohr Ref.	Tubo Pulido Mirror Polished Pipe Tube Poli Miroir Poliertes Rohr Ref.	Ø x Espesor / Thickness / Épaisseur / Dicke	Largo / Length / Longeur / Länge (mm)	Peso / Weight / Poid / Gewicht (+/-) Kg/m	Presión de Trabajo / Working Pressure / Pression de Service / Arbeitsdruck Kg/cm
10410X06	104P10X06	10 x 0,6	5.000	0,141	133
10412X06	104P12X06	12 x 0,6	5.000	0,171	111
10415X06	104P15X06	15 x 0,6	5.000	0,216	88
10418X07	104P18X07	18 x 0,7	5.000	0,303	86
10422X07	104P22X07	22 x 0,7	5.000	0,373	70
10428X08	104P28X08	28 x 0,8	5.000	0,545	63
10435X10	104P35X10	35 x 1,0	5.000	0,851	63
10442X12	104P42X12	42 x 1,2	5.000	1,226	63
10454X12	104P54X12	54 x 1,2	5.000	1,587	49

TUBO SANITARIO DVGW (AISI-316L) • SANITARY PIPE DVGW (AISI-316L) • TUBE SANITAIRE DVGW (AISI-316L) • SANITÄR-ROHR DVGW (EDELSTAHL 1.4404)



Tubo Brillante Pickled Pipe Tube Standad Standar Rohr Ref.	Tubo Pulido Mirror Polished Pipe Tube Poli Miroir Poliertes Rohr Ref.	Ø x Espesor / Thickness / Épaisseur / Dicke	Largo / Length / Longeur / Länge (mm)	Peso / Weight / Poid / Gewicht (+/-) Kg/m	Presión de Trabajo / Working Pressure / Pression de Service / Arbeitsdruck Kg/cm
12415X10	124P15X10	15 x 1,0	6.000	0,303	86
12418X10	124P18X10	18 x 1,0	6.000	0,373	70
12422X12	124P22X12	22 x 1,2	6.000	0,545	63
12428X12	124P28X12	28 x 1,2	6.000	0,851	63
12435X15	124P35X15	35 x 1,5	6.000	1,226	63
12442X15	124P42X15	42 x 1,5	6.000	1,587	49
12454X15	124P54X15	54 x 1,5	6.000	3,711	58
124761X20	124P761X20	76,1 x 2,0	6.000	4,352	49
124889X20	124P889X20	88,9 x 2,0	6.000	4,352	49
124108X20	124P108X20	108,0 x 2,0	6.000	5,308	41

CURVA 90° HH • BEND 90° PRESS X PRESS • COUDE 90° FF • BOGEN 90° II

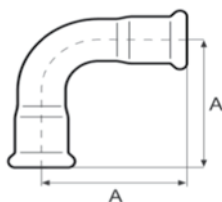

Ref.	Ø	A	Peso / Weight / Poid / Gewicht Kg	U. /
27C90HH15	15 x 15	47	0,057	25
27C90HH18	18 x 18	55	0,077	25
27C90HH22	22 x 22	62	0,097	15
27C90HHRC28	28 x 28	65	0,143	5
27C90HHRC35	35 x 35	75	0,198	5
26C90HHRC42	42 x 42	94	0,314	5
26C90HHRC54	54 x 54	108	0,499	3
26C90HHRC76	76,1 x 76,1	162	0,977	1
26C90HH88	88,9 x 88,9	219	1,325	1
26C90HH108	108,0 x 108,0	266	2,091	1

CURVA 90° HM • BEND 90° Ø X PRESS • COUDE 90° FM • BOGEN 90° IA

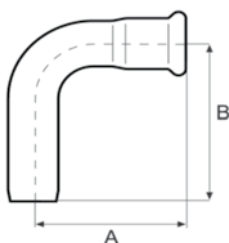

Ref.	Ø	A	B	Peso / Weight / Poid / Gewicht Kg	U. /
27C90HM15	15 x 15	47	55	0,058	25,000
27C90HM18	18 x 18	55	62	0,070	25,000
27C90HM22	22 x 22	62	68	0,098	15,000
27C90HMRC28	28 x 28	65	73	0,147	5,000
27C90HMRC35	35 x 35	75	80	0,200	5,000
26C90HMRC42	42 x 42	93	103	0,260	5,000
26C90HMRC54	54 x 54	105	120	0,400	3,000
26C90HMRC76	76,1 x 76,1	165	183	0,982	1,000
26C90HM88	88,9 x 88,9	222	240	1,317	1,000
26C90HM108	108,0 x 108,0	268	290	2,068	1,000

CURVA 45° HH • BEND 45° PRESS X PRESS • COUDE 45° FF • BOGEN 45° II

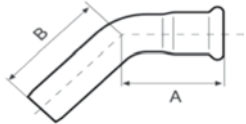

Ref.	Ø	A	Peso / Weight / Poid / Gewicht Kg	U. /
27C45HH15	15 x 15	36	0,049	25
27C45HH18	18 x 18	37	0,059	25
27C45HH22	22 x 22	39	0,081	25
27C45HH28	28 x 28	49	0,118	10
27C45HH35	35 x 35	56	0,161	10
26C45HH42	42 x 42	72	0,254	10
26C45HH54	54 x 54	85	0,369	5
26C45HH76	76,1 x 76,1	138	0,773	1
26C45HH88	88,9 x 88,9	154	0,991	1
26C45HH108	108,0 x 108,0	165	1,600	1

CURVA 45° HM • BEND 45° Ø X PRESS • COUDE 45° FM • BOGEN 45° IA

Ref.	Ø	A	B	Peso / Weight / Poid / Gewicht Kg	U. /
27C45HM15	15 x 15	33	47	0,053	25
27C45HM18	18 x 18	35	48	0,059	25
27C45HM22	22 x 22	37	48	0,085	25
27C45HM28	28 x 28	47	50	0,117	10
27C45HM35	35 x 35	55	63	0,160	10
26C45HM42	42 x 42	72	80	0,237	10
26C45HM54	54 x 54	85	106	0,366	5
26C45HM76	76,1 x 76,1	138	140	0,767	1
26C45HM88	88,9 x 88,9	154	165	0,998	1
26C45HM108	108,0 x 108,0	165	190	1,510	1

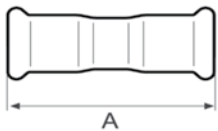
MANGUITO HH • STRAIGHT COUPLING PRESS X PRESS • MANCHON FF • MUFFE II

Ref.	Ø	A	Peso / Weight / Poid / Gewicht Kg	U. /
27M15	15 x 15	49	0,039	25
27M18	18 x 18	49	0,044	25
27M22	22 x 22	54	0,062	25
27M28	28 x 28	56	0,078	10
27M35	35 x 35	64	0,109	10
26M42	42 x 42	82	0,147	10
26M54	54 x 54	90	0,205	5
26M76	76,1 x 76,1	148	0,604	1
26M88	88,9 x 88,9	170	0,837	1
26M108	108,0 x 108,0	197	1,193	1

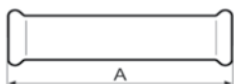
MANGUITO SINFÍN • SLEEVE COUPLING PRESS X PRESS • MANCHON COULISSANT FF • SCHIEBEMUFFE II

Ref.	Ø	A	Peso / Weight / Poid / Gewicht Kg	U. /
27MST15	15 x 15	85	0,047	10
27MST18	18 x 18	82	0,063	15
27MST22	22 x 22	84	0,085	15
27MST28	28 x 28	92	0,114	10
27MST35	35 x 35	104	0,149	5
26MST42	42 x 42	121	0,216	10
26MST54	54 x 54	142	0,316	5
26MST76	76,1 x 76,1	230	0,874	1
26MST88	88,9 x 88,9	260	1,196	1
26MST108	108,0 x 108,0	310	1,775	1

TE IGUAL UNA PIEZA • ONE PIECE PART T-COUPLING 3 X PRESS • MONOBLOC TÉ ÉGAL FEMELLE • T-STÜCK EINTEILIG

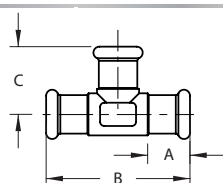

Ref.	Ø	A	B	C	Peso / Weight / Poid / Gewicht Kg	U. /
27T15	15 x 15 x 15	20	68	32	0,087	25
27T18	18 x 18 x 15	20	74	33	0,096	15
27T22	22 x 22 x 22	21	80	40	0,105	15
27T28	28 x 28 x 28	23	90	42	0,149	5
27T35	35 x 35 x 35	26	94	50	0,155	5
26T42	42 x 42 x 42	30	116	54	0,275	5

TE IGUAL SOLDADA • WELDED T-COUPLING 3 X PRESS • SOUDÉ TÉ ÉGAL FEMELLE • T-STÜCK GESCHWEIßT

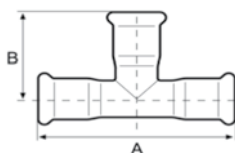

Ref.	Ø	A	B	Peso / Weight / Poid / Gewicht Kg	U. /
27TW15	15 x 15 x 15	16	67	0,047	25
27TW18	18 x 18 x 18	17	68,5	0,059	15
27TW22	22 x 22 x 22	20	75	0,078	15
27TW28	28 x 28 x 28	26	91	0,104	5
27TW35	35 x 35 x 35	29	110	0,132	5
26TW42	42 x 42 x 42	33	117	0,275	5
26TW54	54 x 54 x 54	33	146	0,382	3
26TW76	76,1 x 76,1 x 76,1	54	230	1,192	1
26TW88	88,9 x 88,9 x 88,9	58,5	260	1,617	1
26TW108	108,0 x 108,0 x 108,0	71	310	2,450	1

TE ROSCADA UNA PIEZA • OPP T-COUPLING PRESS X FEMALE X PRESS • MONOBLOC TÉ TARAUDÉ • T-STÜCK EINTEILIG IG

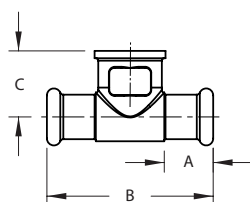

Ref.	Ø	A	B	Peso / Weight / Poid / Gewicht Kg	U. /
27TH15X12	15 x 1/2" x 15	20	68	0,083	10
27TH18X12	18 x 1/2" x 18	20	74	0,095	10
27TH18X34	18 x 3/4" x 18	20	80	0,118	10
27TH22X12	22 x 1/2" x 22	21	80	0,117	10
27TH22X34	22 x 3/4" x 22	21	86	0,140	10
27TH28X12	28 x 1/2" x 28	23	90	0,148	10
27TH28X34	28 x 3/4" x 28	23	90	0,159	10
27TH35X12	35 x 1/2" x 35	26	90	0,178	5
27TH35X34	35 x 3/4" x 35	26	90	0,189	5
26TH42X12	42 x 1/2" x 42	30	116	-	5
26TH42X34	42 x 3/4" x 42	30	116	-	5

TE ROSCADA SOLDADA • WELDED T-COUPLING PRESS X FEMALE X PRESS • TÉ TARAUDÉ SOUDÉ • T-STÜCK GESCHWEIßT IG

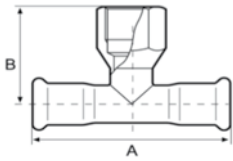

Ref.	Ø	A	B	Peso / Weight / Poid / Gewicht Kg	U. /
27THW15X12	15 x 1/2"	68	33	0,083	10
27THW18X12	18 x 1/2"	69	35	0,095	10
27THW18X34	18 x 3/4"	69	40	0,118	10
27THW22X12	22 x 1/2"	75	33	0,117	10
27THW22X34	22 x 3/4"	76	43	0,131	10
27THW28X10	28 x 1"	92	48	0,174	10
27THW28X12	28 x 1/2"	85	37	0,144	10
27THW28X34	28 x 3/4"	85	46	0,159	10
27THW35X12	35 x 1/2"	102	40	0,178	5
27THW35X34	35 x 3/4"	102	50	0,189	5
26THW42X12	42 x 1/2"	116	44	0,240	5
26THW42X34	42 x 3/4"	116	49	0,254	5
26THW54X12	54 x 1/2"	146	48	0,362	3
26THW54X34	54 x 3/4"	146	59	0,364	3
26THW54X20	54 x 2"	146	85	0,523	3
26THW76X34	76,1 x 3/4"	230	70	1,009	1
26THW76X20	76,1 x 2"	230	98	1,194	1
26THW88X34	88,9 x 3/4"	260	76	1,210	1
26THW88X20	88,9 x 2"	260	100	1,450	1
26THW108X34	108,0 x 3/4"	310	86	1,956	1
26THW108X20	108,0 x 2"	310	112	2,118	1

TE REDUCCIÓN HHH • T-COUPLING REDUCTION 3 X PRESS • TÉ RÉDUIT • T-STÜCK REDUZIERT

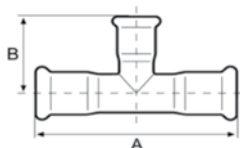

Ref.	Ø	A	B	Peso / Weight / Poid / Gewicht Kg	U. /
27TR18X15	18 x 15 x 18	16,5	68,5	0,083	15
27TR22X15	22 x 15 x 22	20	75	0,098	15
27TR22X18	22 x 18 x 22	19	75	0,105	15
27TR28X15	28 x 15 x 28	21	90	0,130	5
27TR28X18	28 x 18 x 28	23	91	0,132	5
27TR28X22	28 x 22 x 28	21	90	0,140	5
27TR35X15	35 x 15 x 35	29	110	0,164	5
27TR35X18	35 x 18 x 35	27	120	0,164	5
27TR35X22	35 x 22 x 35	25	110	0,172	5
27TR35X28	35 x 28 x 35	27	110	0,175	5
27TR42X22	42 x 22 x 42	30	117	0,239	5
27TR42X28	42 x 28 x 42	30	117	0,240	5
27TR42X35	42 x 35 x 42	30	117	0,242	5
27TR54X22	54 x 22 x 54	33	145	0,325	5
27TR54X28	54 x 28 x 54	33	145	0,348	4
27TR54X35	54 x 35 x 54	33	146	0,344	4
26TR54X42	54 x 42 x 54	33	146	0,368	4
27TR76X22	76,1 x 22 x 76,1	54	230	0,942	1
27TR76X28	76,1 x 28 x 76,1	66	245	0,956	1
27TR76X35	76,1 x 35 x 76,1	53	230	0,968	1
26TR76X42	76,1 x 42 x 76,1	53	230	0,981	1
26TR76X54	76,1 x 54 x 76,1	53	230	1,067	1
27TR88X22	88,9 x 22 x 88,9	82	277	1,256	1
27TR88X28	88,9 x 28 x 88,9	56	260	1,244	1
27TR88X35	88,9 x 35 x 88,9	60	260	1,267	1
26TR88X42	88,9 x 42 x 88,9	60	260	1,271	1
26TR88X54	88,9 x 54 x 88,9	60	260	1,297	1
26TR88X76	88,9 x 76,1 x 88,9	58	260	1,479	1
27TR108X22	108,0 x 22 x 108,0	69	310	1,919	1
27TR108X28	108,0 x 28 x 108,0	75	310	1,939	1
27TR108X35	108,0 x 35 x 108,0	71	310	1,955	1
26TR108X42	108,0 x 42 x 108,0	73	310	1,886	1
26TR108X54	108,0 x 54 x 108,0	67,5	310	1,967	1
26TR108X76	108,0 x 76,1 x 108,0	75	310	2,147	1
26TR108X88	108,0 x 88,9 x 108,0	75	310	2,255	1

BRIDA ADAPTADOR • FLANGE WITH PRESS-JOINT • BRIDE À BOUT LISSE • FLANSCH MIT PRESSMUFFE

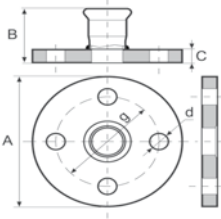

Ref.	Ø	A	B	C	Peso / Weight / Poid / Gewicht Kg	U. /
27BA15	15	95	40	-	0,582	1
27BA18	18	95	43	-	0,590	1
27BA22	22	105	47	-	0,783	1
27BA28	28	115	50	-	1,091	1
27BA35	35	140	54	-	1,717	1
26BA42	42	150	59	110	2,088	1
26BA54	54	165	62	125	2,834	1
26BA76	76	185	102	145	3,546	1
26BA88	88,9	200	97	160	4,344	1
26BA108	108,0	220	122	180	5,251	1

COMPENSADOR DE DILATACIÓN • EXPANSION COMPENSATOR WITH FLANGES • COMPENSATEUR D'EXPANSION AVEC BRIDES • KOMPENSATOR II / MIT FLANSCHEN

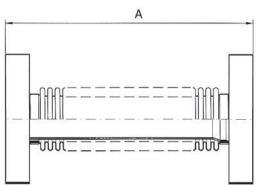
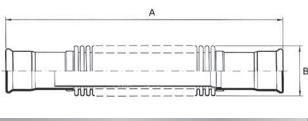

Ref.	Ø	A	B	Peso / Weight / Poid / Gewicht Kg	U. /
27CD15	15	320	25	0,220	10
27CD18	18	320	25	0,220	10
27CD22	22	320	30	0,270	5
27CD28	28	325	38	0,460	5
27CD35	35	340	48	0,650	3
26CD42	42	340	54	0,840	3
26CD54	54	400	71	1,370	3
26CD76	76,1	286	-	7,402	1
26CD88	88,9	290	-	9,376	1
26CD108	108,0	280	-	10,960	1

UNIÓN MACHO UNA PIEZA • ONE PIECE PART STRAIGHT ADAPTER MALE X PRESS • RACCORD FILETÉ MONOBLOC • ÜBERGANG AG EINTEILIG

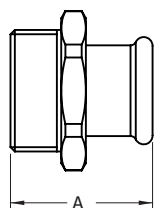

Ref.	Ø	A	Peso / Weight / Poid / Gewicht Kg	U. /
27UM15X12	15 x 1/2"	41	0,060	10
27UM18X12	18 x 1/2"	42	0,085	10
27UM18X34	18 x 3/4"	44	0,095	10
27UM22X12	22 x 1/2"	42	0,070	10
27UM22X34	22 x 3/4"	44	0,110	10
27UM22X10	22 x 1"	46	0,110	10
27UM28X34	28 x 3/4"	46	0,120	10
27UM28X10	28 x 1"	48	0,180	10
27UM35X114	35 x 1 1/4"	53	0,230	10
26UM42X114	42 x 1 1/4"	71	0,275	10
26UM42X112	42 x 1 1/2"	57	0,280	10
26UM54X20	54 x 2"	71	0,368	5
26UM108X40	108,0 x 4"	-	-	1

UNIÓN MACHO SOLDADO • WELDED STRAIGHT ADAPTER MALE X PRESS • RACCORD FILETÉ SOUDÉ • ÜBERGANG AG GESCHWEIßT

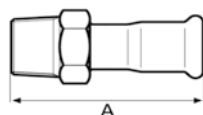

Ref.	Ø	A	Peso / Weight / Poid / Gewicht Kg	U. /
27UMW15X12	15 x 1/2"	41	0,052	10
27UMW15X34	15 x 3/4"	43	0,066	10
27UMW15X38	15 x 3/8"	-	0,050	10
27UMW18X12	18 x 1/2"	42	0,053	10
27UMW18X34	18 x 3/4"	44	0,067	10
27UMW22X12	22 x 1/2"	42	0,073	10
27UMW22X34	22 x 3/4"	44	0,074	10
27UMW22X10	22 x 1"	46	0,116	10
27UMW28X34	28 x 3/4"	46	0,100	10
27UMW28X10	28 x 1"	48	0,115	10
27UMW28X114	28 x 1 1/4"	-	0,172	10
27UMW35X10	35 x 1"	73	0,148	10
27UMW35X114	35 x 1 1/4"	53	0,165	10
27UMW35X112	35 x 1 1/2"	-	0,198	10
26UMW42X114	42 x 1 1/4"	71	0,216	10
26UMW42X112	42 x 1 1/2"	57	0,204	10
26UMW54X112	54 x 1 1/2"	84	0,271	5
26UMW54X20	54 x 2"	71	0,368	5
26UMW76X212	76,1 x 2 1/2"	123	0,820	1
26UMW88X30	88,9 x 3"	135	1,158	1

UNIÓN HEMBRA UNA PIEZA • ONE PIECE PART STRAIGHT ADAPTER FEMALE X PRESS • RACCORD TARAUDÉ MONOBLOC • ÜBERGANG IG EINTEILIG

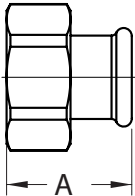

Ref.	Ø	A	Peso / Weight / Poid / Gewicht Kg	U. /
27UH15X12	15 x 1/2"	37	0,052	10
27UH18X12	18 x 1/2"	37	0,068	10
27UH18X34	18 x 3/4"	38	0,077	10
27UH22X12	22 x 1/2"	36	0,090	10
27UH22X34	22 x 3/4"	39	0,110	10
27UH22X10	22 x 1"	42	0,105	10
27UH28X10	28 x 1"	44	0,121	10
27UH35X114	35 x 1 1/4"	49	0,332	10
26UH42X114	42 x 1 1/4"	53	0,219	10

UNIÓN HEMBRA SOLDADA • WELDED STRAIGHT ADAPTER FEMALE X PRESS • RACCORD TARAUDÉ SOUDÉ • ÜBERGANG IG GESCHWEIßT

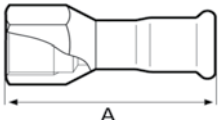

Ref.	Ø	A	Peso / Weight / Poid / Gewicht Kg	U. /
27UHW15X12	15 x 1/2"	37	0,052	10
27UHW15X34	15 x 3/4"	38	0,081	10
27UHW18X12	18 x 1/2"	37	0,052	10
27UHW18X34	18 x 3/4"	38	0,077	10
27UHW22X12	22 x 1/2"	36	0,077	10
27UHW22X34	22 x 3/4"	39	0,075	10
27UHW22X10	22 x 1"	42	0,105	10
27UHW28X34	28 x 3/4"	62	0,105	10
27UHW28X10	28 x 1"	44	0,103	10
27UHW28X114	28 x 1 1/4"	94	0,171	10
27UHW35X10	35 x 1"	79	0,136	10
27UHW35X114	35 x 1 1/4"	49	0,170	10
27UHW35X112	42 x 1 1/2"	98	0,259	10
26UHW42X114	42 x 1 1/4"	53	0,221	10
26UHW42X112	42 x 1 1/2"	79	0,252	10
26UHW54X112	54 x 1 1/2"	87	0,328	5
26UHW54X20	54 x 2"	62	0,342	5
26UHW76X212	76,1 x 2 1/2"	127	0,993	1

REDUCCIÓN MH • STRAIGHT COUPLING REDUCTION Ø X PRESS • RÉDUCTION MF • REDUZIERMUFFE IA

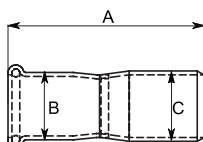
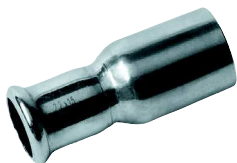

Ref.	Ø	A	Peso / Weight / Poid / Gewicht Kg	U. /
27RE18X15	18 x 15	58	0,040	25
27RE22X15	22 x 15	59	0,045	25
27RE22X18	22 x 18	55	0,047	10
27RE28X15	28 x 15	64	0,056	10
27RE28X18	28 x 18	65	0,061	10
27RE28X22	28 x 22	57	0,065	10
27RE35X15	35 x 15	71	0,089	10
27RE35X18	35 x 18	87	0,096	10
27RE35X22	35 x 22	74	0,098	10
27RE35X28	35 x 28	68	0,112	10
27RE42X15	42 x 15	91	0,118	10
27RE42X18	42 x 18	96	0,126	10
27RE42X22	42 x 22	84	0,125	10
27RE42X28	42 x 28	84	0,140	10
27RE42X35	42 x 35	87	0,120	10
27RE54X15	54 x 15	110	0,197	10
27RE54X18	54 x 18	113	0,200	10
27RE54X22	54 x 22	107	0,191	10
27RE54X28	54 x 28	94	0,193	10
27RE54X35	54 x 35	93	0,237	10
26RE54X42	54 x 42	97	0,191	10
26RE76X42	76,1 X 42	151	0,415	1
26RE76X54	76,1 x 54	150	0,451	1
26RE88X54	88,9 x 54	166	0,586	1
26RE88X76	88,9 x 76,1	163	0,653	1
26RE108X54	108,0 x 54	245	0,880	1
26RE108X76	108,0 x 76,1	203	0,978	1
26RE108X88	108,0 x 88,9	205	0,992	1

RACOR 2 PIEZAS CON CUELLO • JOINT CONNECTOR FEMALE X PRESS • ÉCROU TOURNANT • ÜBERGANGSMUFFE IG

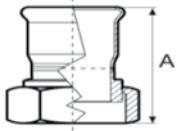

Ref.	Ø	A	Peso / Weight / Poid / Gewicht Kg	U. /
27RP15X12	15 x 1/2"	19	0,070	25
27RP15X34	15 x 3/4"	19	0,081	15
27RP18X12	18 x 1/2"	20	0,095	15
27RP18X34	18 x 3/4"	21,5	0,102	10
27RP22X34	22 x 3/4"	22	0,112	10
27RP22X10	22 x 1"	21,5	0,118	15
27RP28X10	28 x 1"	24	0,122	10
27RP28X114	28 x 1 1/4"	28	0,135	10
27RP35X114	35 x 1 1/4"	30	0,150	10
26RP42X112	42 x 1 1/2"	32	0,278	10
26RP54X20	54 x 2"	53,5	0,585	5
26RP54X212	54 x 2 1/2"	-	0,954	5
26RP76X212	76,1 x 2 1/2"	-	1,125	1

RACOR 2 PIEZAS CON JUNTA PLANA • JOINT CONNECTOR FEMALE X PRESS • ÉCROU TOURNANT JOINT FLAT • ÜBERGANGSMUFFE IG - FLACHDICHTEND

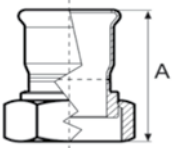

Ref.	Ø	A	Peso / Weight / Poid / Gewicht Kg	U. /
27RPJP15X12	15 x 1/2"	47	0,070	25
27RPJP15X34	15 x 3/4"	54	0,081	15
27RPJP18X12	18 x 1/2"	50	0,095	15
27RPJP18X34	18 x 3/4"	56	0,102	10
27RPJP22X34	22 x 3/4"	56	0,112	10
27RPJP22X10	22 x 1"	56	0,118	15
27RPJP28X10	28 x 1"	62	0,122	10
27RPJP28X114	28 x 1 1/4"	65	0,135	10
27RPJP35X114	35 x 1 1/4"	71	0,150	10
27RPJP35X112	35 x 1 1/2"	-	0,248	10
26RPJP42X112	42 x 1 1/2"	67	0,174	10
26RPJP42X20	42 x 2"	84	0,562	5
26RPJP54X20	54 x 2"	96	0,592	5
26RPJP54X212	54 x 2 1/2"	158	0,941	5
26RPJP54X238	54 x 2 3/8"	-	0,950	5
26RPJP76X212	76,1 x 2 1/2"	138	1,125	1

RACOR 3 PIEZAS CÓNICO • JOINT CONNECTOR PRESS X PRESS • RACCORD CONIQUE • VERSCHRAUBUNG MIT PRESSMUFFEN

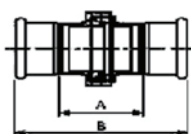

Ref.	Ø	A	B	Peso / Weight / Poid / Gewicht Kg	U. /
27RTP15	15	34	-	0,100	10
27RTP18	18	38	-	0,130	10
27RTP22	22	41	-	0,180	5
27RTP28	28	49	-	0,260	4
27RTP35	35	55	-	0,420	4
26RTP42	42	55	127	0,461	1
26RTP54	54	66	146	0,759	1

RACOR 3 PIEZAS MACHO • JOINT CONNECTOR MALE X PRESS • RACCORD UNION FILETÉ • ÜBERGANGSVERSCHRAUBUNG AG

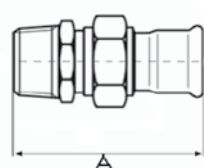

Ref.	Ø	A	Peso / Weight / Poid / Gewicht Kg	U. /
27RTUM15X12	15 x 1/2"	76	0,141	10
27RTUM15X34	15 x 3/4"	80	0,166	10
27RTUM18X12	18 x 1/2"	76	0,142	10
27RTUM18X34	18 x 3/4"	79	0,167	10
27RTUM22X12	22 x 1/2"	80	0,239	5
27RTUM22X34	22 x 3/4"	82	0,215	5
27RTUM22X10	22 x 1"	86	0,249	5
27RTUM28X10	28 x 1"	88	0,349	4
27RTUM35X114	35 x 1 1/4"	100	0,525	4
26RTUM42X112	42 x 1 1/2"	106	0,608	4
26RTUM54X20	54 x 2"	122	0,978	1

RACOR 3 PIEZAS HEMBRA • JOINT CONNECTOR FEMALE X PRESS • RACCORD UNION TARAUDÉ • ÜBERGANGSVERSCHRAUBUNG IG

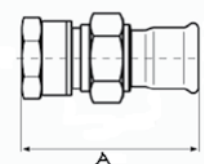

Ref.	Ø	A	Peso / Weight / Poid / Gewicht Kg	U. /
27RTUH15X12	15 x 1/2"	73	0,139	10
27RTUH18X12	15 x 3/4"	72	0,139	10
27RTUH22X34	22 x 3/4"	76	0,205	5
27RTUH28X10	28 x 1"	83	0,387	4
27RTUH35X114	35 x 1 1/4"	93	0,448	4
26RTUH42X112	42 x 1 1/2"	96	0,542	3
26RTUH54X20	54 x 2"	113	0,943	1

CODO MACHO UNA PIEZA • ONE PIECE PART ELBOW TRANSITION MALE X PRESS • COUDE FILETÉ MONOBLOC • WINKEL 90° EINTEILIG AG

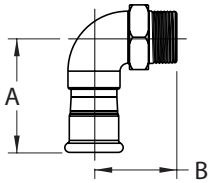

Ref.	Ø	A	B	Peso / Weight / Poid / Gewicht Kg	U. /
27CM15X12	15 x 1/2"	42	37	0,065	15
27CM18X12	18 x 1/2"	44	37	0,084	15
27CM22X34	22 x 3/4"	46	46	0,080	10
27CM28X10	28 x 1"	52	46	0,270	10
27CM35X114	35 x 1 1/4"	60	54	0,370	10
26CM42X112	42 x 1 1/2"	66	54	0,280	5
26CM54X20	54 x 2"	75	63	0,320	5

CODO MACHO SOLDADO • WELDED ELBOW TRANSITION MALE X PRESS • COUDE FILETÉ SOUDÉ • WINKEL 90° GESCHWEIßT AG

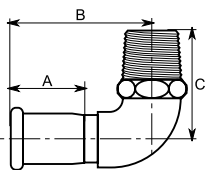

Ref.	Ø	A	B	Peso / Weight / Poid / Gewicht Kg	U. /
27CMW15X12	15 x 1/2"	53	34	0,075	10
27CMW18X12	18 x 1/2"	55	36	0,081	10
27CMW22X34	22 x 3/4"	63	42,5	0,119	5
27CMW28X10	28 x 1"	73	52,5	0,184	5
27CMW35X114	35 x 1 1/4"	82	52	0,262	3
26CMW42X112	42 x 1 1/2"	136	67	0,376	3
26CMW54X20	54 x 2"	155	70	0,667	3

CODO HEMBRA UNA PIEZA • ONE PIECE PART ELBOW TRANSITION FEMALE X PRESS • COUDE TARAUDÉ MONOBLOC • WINKEL 90° EINTEILIG IG

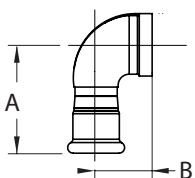

Ref.	Ø	A	B	Peso / Weight / Poid / Gewicht Kg	U. /
27CH15X12	15 x 1/2"	42	37	0,065	15
27CH18X12	18 x 1/2"	42	37	0,084	15
27CH22X34	22 x 3/4"	46	42	0,147	15
27CH28X10	28 X 1"	52	45	0,220	10
27CH35X114	35 x 1 1/4"	60	45	0,360	10

CODO HEMBRA SOLDADO • WELDED ELBOW TRANSITION FEMALE X PRESS • COUDE TARAUDÉ SOUDÉ • WINKEL 90° GESCHWEIßT IG

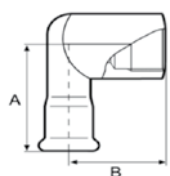

Ref.	Ø	A	B	Peso / Weight / Poid / Gewicht Kg	U. /
27CHW15X12	15 x 1/2"	53	27	0,076	10
27CHW18X12	18 x 1/2"	55	27	0,084	10
27CHW22X34	22 x 3/4"	59	30,5	0,123	5
27CHW28X10	22 x 1"	72	39	0,191	5
27CHW28X12	28 x 1/2"	-	-	0,172	5
27CHW35X114	35 x 1 1/4"	81	46	0,267	3

CODO PLACA UNA PIEZA • ONE PIECE PART WALLPLATE FEMALE X PRESS • COUDE TARAUDÉ AVEC APPLIQUE MONOBLOC • DECKENWINKEL 90° EINTEILIG IG

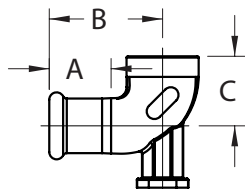

Ref.	Ø	A	B	Peso / Weight / Poid / Gewicht Kg	U. /
27CF15X12	15 x 1/2"	42	27	0,065	15
27CF18X12	18 x 1/2"	44	27	0,112	15
27CF22X34	22 x 3/4"	46	33	0,147	10
27CF28X10	28 x 1"	52	39	0,218	10

CODO PLACA SOLDADO • WELDED WALLPLATE FEMALE X PRESS • COUDE TARAUDÉ AVEC APPLIQUE SOUDÉ • DECKENWINKEL 90° GESCHWEIßT IG

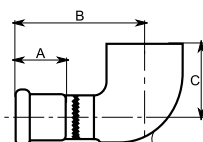

Ref.	Ø	A	B	Peso / Weight / Poid / Gewicht Kg	U. /
27CFW15X12	15 x 1/2"	18	53	0,104	10
27CFW18X12	18 x 1/2"	20	57	0,100	10
27CFW22X34	22 x 3/4"	22	60	0,147	5
27CFW28X10	28 x 1"	72	42	0,218	5

CURVA 2 PIEZAS • BEND 2 PIECES • COUDE ÉCROU TOURNANT • ÜBERGANGSWINKEL 90° IG

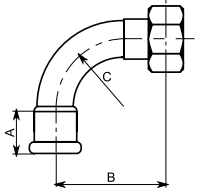

Ref.	Ø	A	B	C	Peso / Weight / Poid / Gewicht Kg	U. /
27CP15X12	15 x 1/2"	16,5	45	28	0,080	25
27CP18X12	18 x 1/2"	19	51	32	0,105	15
27CP18X34	18 x 3/4"	19	54,5	32	0,125	10
27CP22X34	22 x 3/4"	22	67,5	38	0,140	10
27CP22X10	22 x 1"	22	72,5	38	0,155	10

CURVA DE AJUSTE 15° • BEND 15° • COUDE D'AJUSTEMENT 15° • PASSBOGEN 15° AA

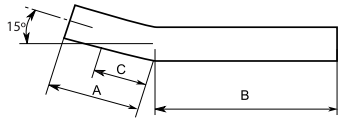

Ref.	Ø	A	B	C	Peso / Weight / Poid / Gewicht Kg	U. /
26CA1528	28 x 28	67	134	48	0,193	3
26CA1535	35 x 35	78	222	53	0,372	3
26CA1542	42 x 42	121	280	59	0,575	3
26CA1554	54 x 54	140	337	67	0,837	3

CURVA DE AJUSTE 30° • BEND 30° • COUDE D'AJUSTEMENT 30° • PASSBOGEN 30° AA

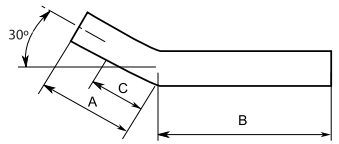

Ref.	Ø	A	B	C	Peso / Weight / Poid / Gewicht Kg	U. /
26CA3028	28 x 28	70	130	54	0,195	3
26CA3035	35 x 35	86	214	60	0,372	3
26CA3042	42 x 42	135	265	69	0,576	3
26CA3054	54 x 54	136	326	79	0,845	3

CURVA DE AJUSTE 60° • BEND 60° • COUDE D'AJUSTEMENT 60° • PASSBOGEN 60° AA

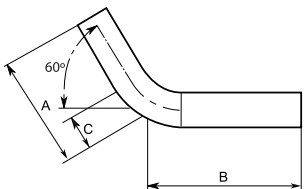

Ref.	Ø	A	B	C	Peso / Weight / Poid / Gewicht Kg	U. /
26CA6028	28 x 28	80	125	66	0,195	5
26CA6035	35 x 35	105	190	77	0,371	5
26CA6042	42 x 42	150	250	90	0,600	3
26CA6054	54 x 54	165	306	107	0,888	3

CURVA DE AJUSTE 90° • BEND 90° • COUDE D'AJUSTEMENT 90° • PASSBOGEN 90° AA

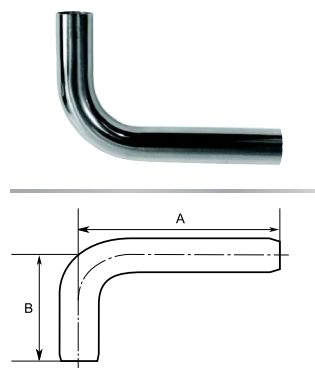

Ref.	Ø	A	B	Peso / Weight / Poid / Gewicht Kg	U. /
26CA9015	15 x 15	75	122	0,059	10
26CA9018	18 x 18	74	120	0,106	10
26CA9022	22 x 22	77	120	0,134	10
26CA9028	28 x 28	102	120	0,155	5
26CA9035	35 x 35	130	200	0,364	3
26CA9042	42 x 42	185	250	0,575	3
26CA9054	54 x 54	207	300	0,846	2

CURVA DESVIACIÓN MH • BY-PASS BEND Ø X PRESS • BAÏONETTE MF • SPRUNGBOGEN IA

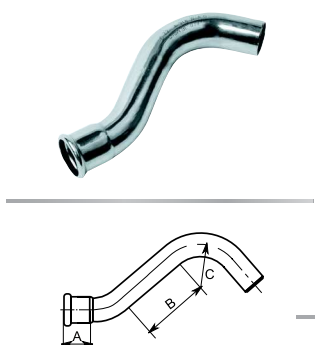

Ref.	Ø	A	B	C	Peso / Weight / Poid / Gewicht Kg	U. /
27CDHM15	15	15,5	43	28	0,095	10
27CDHM18	18	18	51	32	0,128	5
27CDHM22	22	19,5	43	38	0,166	5

CURVA DESVIACIÓN CISNE • COMPRESSED AIR BEND • CROSSE D'ÉVÊQUE • DRUCKLUFT-ROHRBOGEN

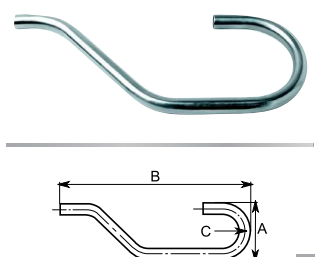

Ref.	Ø	A	B	C	Peso / Weight / Poid / Gewicht Kg	U. /
26CC15	15 x 15	98	306	41	0,164	10
26CC18	18 x 18	144	370	63	0,197	10
26CC22	22 x 22	170	410	73	0,210	5

CRUZ REDUCIDA • CROSSOVER COUPLING 4 X PRES • CROIX REDUCTION • HREUZSTÜCK 90°

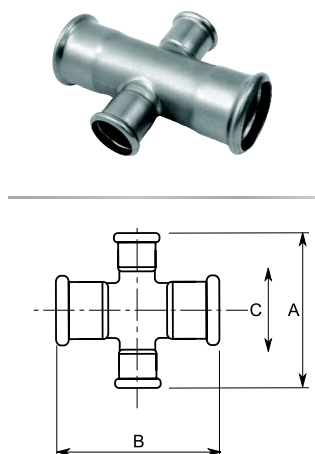

Ref.	Ø	A	B	C	Peso / Weight / Poid / Gewicht Kg	U. /
26CR42X76X76X42	42 x 76,1 x 76,1 x 42	142	265	84	-	1
26CR42X88X88X42	42 x 88,9 x 88,9 x 42	156	-	-	-	1

TAPÓN • ENDCAP PRESS • BOUCHON • VERSCHLUßKAPPE



Ref.	Ø	A	Peso / Weight / Poid / Gewicht Kg	U. /
27TA15	15	36	0,027	10
27TA18	18	39	0,033	10
27TA22	22	41	0,044	10
27TA28	28	47	0,063	5
27TA35	35	52	0,081	5
26TA42	42	55	0,119	5
26TA54	54	63	0,171	3
26TA76	76,1	97	0,427	1
26TA88	88,9	108	0,559	1
26TA108	108,0	129	0,821	1