

**TUBOS Y ACCESORIOS • TUBES AND FITTINGS**  
**TUBES ET ACCESSOIRES • ROHRE UND FITTINGE**

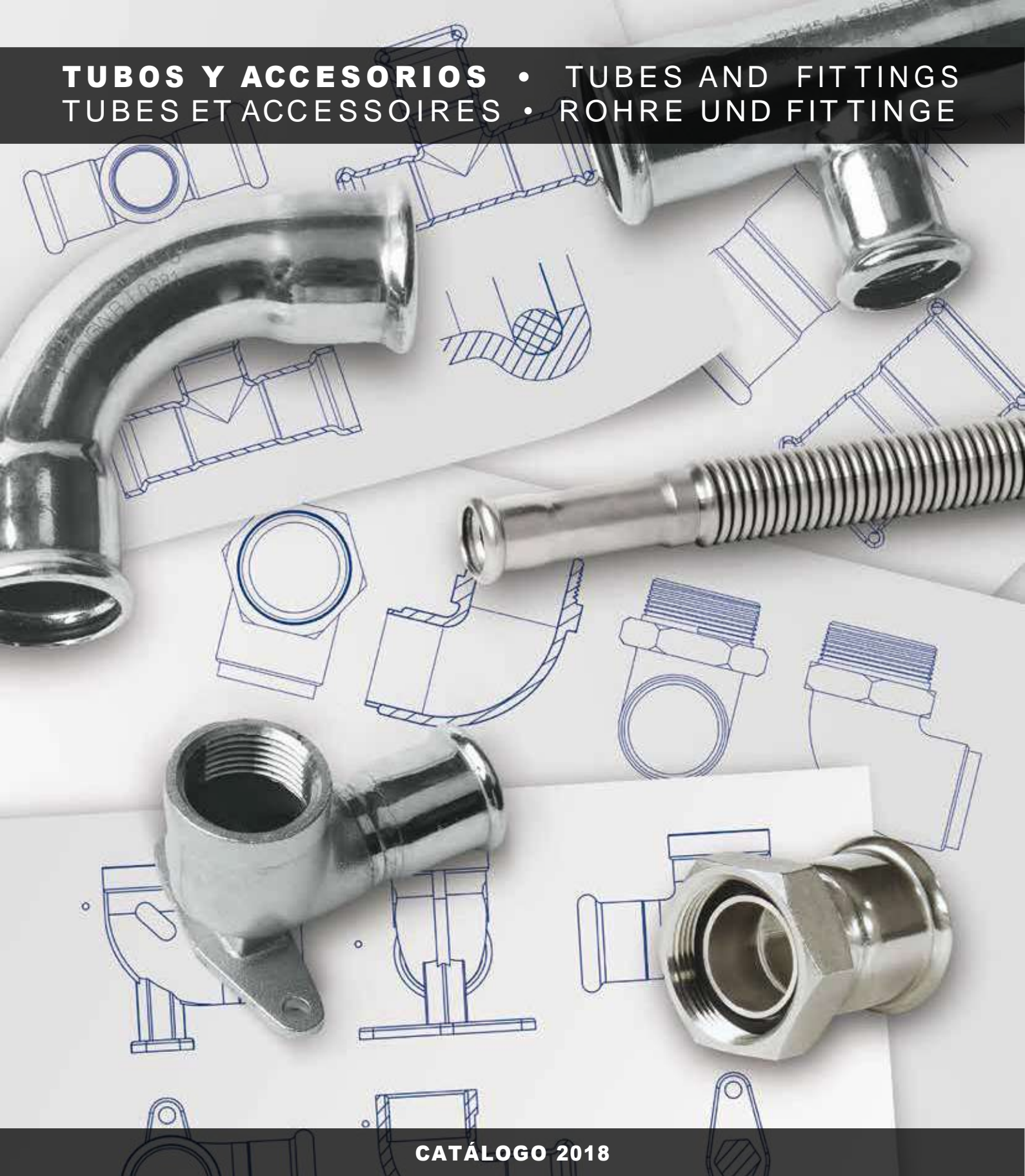

**CATÁLOGO 2018**



**FILTUBE**  
ACERO INOXIDABLE

**[Instalpress]**

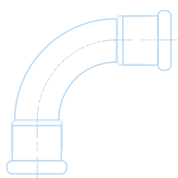

**ACCESORIOS FILPRESS AISI-316L - PERFIL F**  
 FILPRESS PRESSFITTINGS AISI-316L - PROFILE F  
 FILPRESS RACCORDS À SERTIR EN ACIER INOXYDABLE AISI-316L  
 FILPRESS PRESSFITTINGS AUS EDELSTAHL 1.4404 FÜR DÜNNWANDIGE EDELSTAHLROHRE - PRESSKONTUR F

8

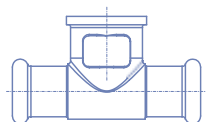

**ACCESORIOS INSTALPRESS AISI-316L - PERFIL M**  
 INSTALPRESS PRESSFITTINGS AISI-316L - PROFILE M  
 INSTALPRESS RACCORDS À SERTIR EN ACIER INOXYDABLE AISI-316L  
 INSTALPRESS PRESSFITTINGS AUS EDELSTAHL 1.4404 FÜR DÜNNWANDIGE EDELSTAHLROHRE - PRESSKONTUR M

18

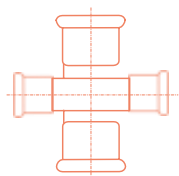

**ACCESORIOS ACERO AL CARBONO - PERFIL M**  
 STEEL ZINC PLATED PRESSFITTINGS - M PROFILE  
 RACCORDS À SERTIR EN ACIER GALVANISÉ  
 C-STAHLE PRESSFITTINGS - PRESSKONTUR M

31



**ACCESORIOS ACERO AL CARBONO FIREPRESS - PERFIL M**  
 FIREPRESS STEEL ZINC PLATED PRESSFITTINGS - M PROFILE  
 FIREPRESS RACCORDS À SERTIR EN ACIER GALVANISÉ  
 FIREPRESS C-STAHLE PRESSFITTINGS - PRESSKONTUR M

41

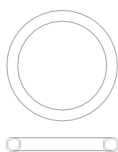

**JUNTAS**  
 O-RINGS  
 JOINTS  
 DICHTUNG

43

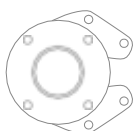

**MÁQUINAS DE PRENSAR**  
 PRESS MACHINES  
 MACHINES PRESSER  
 PRESSMASCHINEN

44

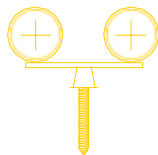

**ABRAZADERAS**  
 PIPE CLAMPS  
 COLLIERES DE FIXATION  
 ROHRSCHELLEN

49

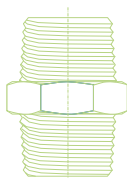

**ACCESORIOS ROSCADOS DIN EN 10226-1 AISI-316**  
 THREADED FITTINGS DIN EN 10226-1 AISI-316  
 ACCESSOIRES FILETÉS DIN EN 10226-1 AISI-316  
 GEWINDEFITTINGE DIN EN 10226-1 1.4401

55

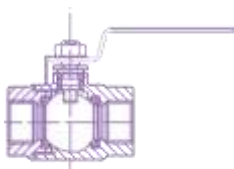

**VÁLVULAS AISI-316**  
 VALVES AISI-316  
 BOISSEAUX AISI-316  
 KUGELHÄHNE EDELSTAHL 1.4401

60



# CERTIFICATE

No. 340555



This is to certify that the Quality Management System of



## FILINOX, S.A.

Sant Joan Baptista, s/n  
08789 La Torre de Claramunt (Barcelona)  
Spain

Administrative site:  
C/Sant Adria, 76 08030 Barcelona

has been assessed and found to be in compliance with the standard

### ISO 9001:2015

applicable to

**Design, manufacture and commercialization of stainless steel products for domestic, industrial use, swimming pools, pipes and fittings, tubes and derivatives, vessels and heat resistant stainless steel tools.**

The certificate has been issued under No. 340555 for the registration period from 15<sup>th</sup> August 2017 to 14<sup>th</sup> August 2020.

Approved by

Printed by



validity code: **86F26437-F78**  
Check the validity of this certificate using this code at [www.ll-c.info](http://www.ll-c.info)



[www.ll-c.net](http://www.ll-c.net)

LL-C (Certification) Czech Republic s.r.o. | Pobežní 620/3, 186 00 Praha 8

### INOX STEEL A-316 L



### CARBON STEEL





ES

## PRESENTACIÓN EMPRESA FILINOX, S.A.

En Filinox somos especialistas en el diseño y la fabricación de productos de acero inoxidable. Acumulamos más de 50 años de experiencia y contamos con la confianza de una cartera de más de 3.000 clientes.

Nuestro compromiso es aportar conocimiento y experiencia para alcanzar las soluciones técnicas más idóneas. La alta profesionalidad de nuestro equipo humano, la experiencia que proporciona nuestra trayectoria de más de 50 años en el sector, unidos al hecho de ser especialistas en las diferentes técnicas de trabajar el acero inoxidable, nos permite tener una visión global y cualificada para diseñar y ofrecer la mejor solución para cada cliente.

Nuestras marcas más reconocidas son:



- Sistemas Pressfitting de distribución y canalización de fluidos industriales y líquidos acuosos, incluyendo el agua potable destinada al consumo humano.
- Sistemas Pressfitting de distribución y canalización de fluidos para circuitos de Refrigeración, Climatización y Calefacción.
- Sistemas Modulares de Pressfitting para instalaciones de agua (BIES) y sistemas rociadores, de protección contra-incendios.

EN

## FILINOX, S.A. COMPANY PRESENTATION

At Filinox we specialize in the design and manufacture of stainless steel products. We have accumulated over 50 years' experience and we have a portfolio of over 3,000 satisfied customers.

Our commitment is to provide knowledge and experience to achieve the most appropriate technical solutions. The high professionalism of our team, the experience provided by our track record of over 50 years in the industry, coupled with the fact of being specialists in the various stainless steel working techniques, gives us a global vision and qualifies us to design and offer the best solution for each customer.

Our top brands include:



- Press fitting systems for the distribution and channelling of industrial fluids and aqueous liquids including drinking water for human consumption.
- Press fitting systems for the distribution and channelling of fluids for cooling, air-conditioning and heating circuits.
- Modular press fitting systems for water facilities (fire hydrants) and sprinkler systems for firefighting operations.

FR

## PRÉSENTATION ENTREPRISE FILINOX, S.A.

Chez Filinox, nous sommes spécialisés dans la conception et la fabrication de produits en acier inoxydable. Nous avons une expérience de plus de 50 ans et comptons sur la confiance d'un portefeuille de plus de 3 000 clients.

Notre engagement est de fournir des connaissances et notre expérience pour trouver les solutions techniques parfaites. Le haut niveau de professionnalisme de notre équipe humaine, l'expérience que nous fournit notre trajectoire de plus de 50 ans dans le secteur, et le fait d'être des spécialistes dans les différentes techniques de travail de l'acier inoxydable, nous permettent d'avoir une vision globale et qualifiée pour concevoir et offrir la meilleure solution à chaque client.

Nos marques les plus reconnues sont :



- Systèmes Press fitting de distribution et de canalisation de fluides industriels et de liquides aqueux, y compris l'eau potable destinée à la consommation humaine.
- Systèmes Press fitting de distribution et de canalisation de fluides pour des circuits de refroidissement, climatisation et chauffage.
- Systèmes modulaires de Press fitting pour des installations d'eau (BIE) et des systèmes de sprinklers, de protection contre l'incendie.

DE

## VORSTELLUNG DER FIRMA FILINOX, S.A.

Filinox ist auf die Entwicklung und Herstellung von Erzeugnissen aus Edelstahl spezialisiert. Wir blicken auf über 50 Jahre Erfahrung zurück und genießen das Vertrauen von mehr als 3000 Stammkunden.

Mit Know-how und Erfahrung engagieren wir uns für die Erzielung von idealen technischen Lösungen. Die hohe Professionalität unseres Teams, unsere mehr als 50-jährige Erfahrung in der Branche sowie die Tatsache, dass wir Spezialisten auf dem Gebiet der Verarbeitung von Edelstahl sind, ermöglichen uns eine umfassende und fachlich qualifizierte Sichtweise, um für jeden Kunden die beste Lösung entwickeln zu können.

Unsere renommiertesten Marken sind:



- Pressfitting-Systeme für die Verteilung und Leitung von industriellen Flüssigkeiten und wässrigen Medien einschließlich Trinkwasser für den menschlichen Verzehr
- Pressfitting-Systeme für die Verteilung und Leitung von Flüssigkeiten für Kühl-, Klima- und Heizkreisläufe
- Modulare Pressfitting-Systeme für Wasserinstallationen (Hydranten) und Sprinkleranlagen für den Brandschutz

**TUBO SANITARIO EN-10312 (AISI-304L) • SANITARY PIPE EN-10312 (AISI-304L) • TUBE SANITAIRE EN-10312 (AISI-304L) • SANITÄR-ROHR EN-10312 (EDELSTAHL 1.4307)**



Tubo Brillante Pickled Pipe Tube Standard Standar Rohr Ref.	Tubo Pulido Mirror Polished Pipe Tube Poli Miroir Poliertes Rohr Ref.	Ø x Espesor / Thickness / Épaisseur / Dicke	Largo / Length/ Longeur / Länge (mm)	Peso / Weight / Poid / Gewicht (+/-) Kg/m	Presión de Trabajo / Working Pressure / Pression de Service / Arbeitsdruck Kg/cm	U. / □
10210X06	102P10X06	10 x 0,6	5.000	0,141	133	720
10212X06	102P12X06	12 x 0,6	5.000	0,171	111	720
10215X06	102P15X06	15 x 0,6	5.000	0,216	88	425
10218X07	102P18X07	18 x 0,7	5.000	0,303	86	425
10222X07	102P22X07	22 x 0,7	5.000	0,373	70	425
10228X08	102P28X08	28 x 0,8	5.000	0,545	63	425
10235X10	102P35X10	35 x 1,0	5.000	0,851	63	280
10242X12	102P42X12	42 x 1,2	5.000	1,226	63	280
10254X12	102P54X12	54 x 1,2	5.000	1,587	49	220
122761X20	122P761X20	76,1 x 2,0	6.000	3,711	58	144
122889X20	122P889X20	88,9 x 2,0	6.000	4,352	49	114
122108X20	122P108X20	108,0 x 2,0	6.000	5,308	41	114

**TUBO SANITARIO EN-10312 (AISI-316L) • SANITARY PIPE EN-10312 (AISI-316L) • TUBE SANITAIRE EN-10312 (AISI-316L) • SANITÄR-ROHR EN-10312 (EDELSTAHL 1.4404)**



Tubo Brillante Pickled Pipe Tube Standard Standar Rohr Ref.	Tubo Pulido Mirror Polished Pipe Tube Poli Miroir Poliertes Rohr Ref.	Ø x Espesor / Thickness / Épaisseur / Dicke	Largo / Length/ Longeur / Länge (mm)	Peso / Weight / Poid / Gewicht (+/-)Kg/m	Presión de Trabajo / Working Pressure / Pression de Service / Arbeitsdruck Kg/cm	U. / □
10410X06	104P10X06	10 x 0,6	5.000	0,141	133	720
10412X06	104P12X06	12 x 0,6	5.000	0,171	111	720
10415X06	104P15X06	15 x 0,6	5.000	0,216	88	425
10418X07	104P18X07	18 x 0,7	5.000	0,303	86	425
10422X07	104P22X07	22 x 0,7	5.000	0,373	70	425
10428X08	104P28X08	28 x 0,8	5.000	0,545	63	425
10435X10	104P35X10	35 x 1,0	5.000	0,851	63	280
10442X12	104P42X12	42 x 1,2	5.000	1,226	63	280
10454X12	104P54X12	54 x 1,2	5.000	1,587	49	220

**TUBO SANITARIO DVGW (AISI-316L) • SANITARY PIPE DVGW (AISI-316L) • TUBE SANITAIRE DVGW (AISI-316L) • SANITÄR-ROHR DVGW (EDELSTAHL 1.4404)**



Tubo Brillante Pickled Pipe Tube Standard Standar Rohr Ref.	Tubo Pulido Mirror Polished Pipe Tube Poli Miroir Poliertes Rohr Ref.	Ø x Espesor / Thickness / Épaisseur / Dicke	Largo / Length/ Longeur / Länge (mm)	Peso / Weight / Poid / Gewicht (+/-)Kg/m	Presión de Trabajo / Working Pressure / Pression de Service / Arbeitsdruck Kg/cm	U. / □
12415X10	124P15X10	15 x 1,0	6.000	0,351	147	510
12418X10	124P18X10	18 x 1,0	6.000	0,426	123	510
12422X12	124P22X12	22 x 1,2	6.000	0,625	121	510
12428X12	124P28X12	28 x 1,2	6.000	0,805	95	510
12435X15	124P35X15	35 x 1,5	6.000	1,258	95	336
12442X15	124P42X15	42 x 1,5	6.000	1,521	79	336
12454X15	124P54X15	54 x 1,5	6.000	1,972	61	265
124761X20	124P761X20	76,1 x 2,0	6.000	3,711	58	144
124889X20	124P889X20	88,9 x 2,0	6.000	4,352	49	114
124108X20	124P108X20	108,0 x 2,0	6.000	5,308	41	114

**CURVA 90° HH • BEND 90° PRESS X PRESS • COUDE 90° FF • BOGEN 90° II**

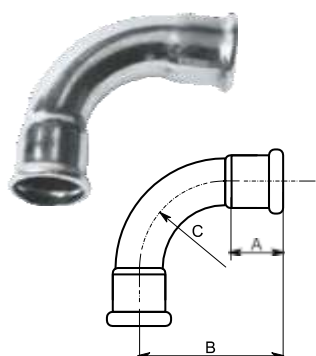

Ref.	Ø	A	B	C	Kg	U./□
26C90HH15	15 x 15	16	49	28	0,040	10
26C90HH18	18 x 18	18	52	32	0,054	10
26C90HH22	22 x 22	21	60	38	0,068	10
26C90HH28	28 x 28	25,5	78	50	0,100	5
26C90HH35	35 x 35	28	100	68	0,139	5
26C90HHRC42	42 x 42	31	94	55	0,314	2
26C90HHRC54	54 x 54	35	108	65	0,499	2
26C90HHRC76	76,1 x 76,1	53	162	91	0,977	1
26C90HH88	88,9 x 88,9	56	219	135	1,325	1
26C90HH108	108,0 x 108,0	79	266	165	2,091	1

**CURVA 90° HM • BEND 90° Ø X PRESS • COUDE 90° FM • BOGEN 90° IA**

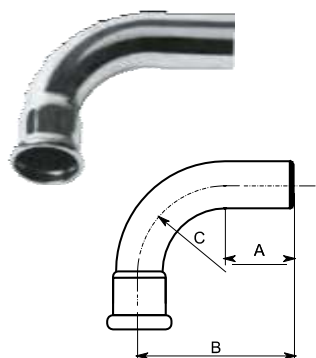

Ref.	Ø	A	B	C	Kg	U./□
26C90HM15	15 x 15	25,5	55	28	0,041	10
26C90HM18	18 x 18	25	57	32	0,049	10
26C90HM22	22 x 22	25	66	38	0,069	10
26C90HM28	28 x 28	41	82	50	0,103	5
26C90HM35	35 x 35	35	110	68	0,140	5
26C90HMRC42	42 x 42	33	103	55	0,260	2
26C90HMRC54	54 x 54	37	110	65	0,400	2
26C90HMRC76	76,1 x 76,1	63	183	91	0,982	1
26C90HM88	88,9 x 88,9	85	240	135	1,317	1
26C90HM108	108,0 x 108,0	77	290	162	2,068	1

**CURVA 45° HH • BEND 45° PRESS X PRESS • COUDE 45° FF • BOGEN 45° II**

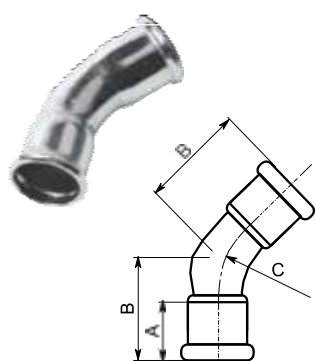

Ref.	Ø	A	B	C	Kg	U./□
26C45HH15	15 x 15	16	32	28	0,034	10
26C45HH18	18 x 18	18,5	33	32	0,041	10
26C45HH22	22 x 22	21,5	37	38	0,057	10
26C45HH28	28 x 28	25,5	47	50	0,083	5
26C45HH35	35 x 35	27	63	68	0,113	5
26C45HH42	42 x 42	33	72	80	0,254	2
26C45HH54	54 x 54	34	85	108	0,369	2
26C45HH76	76,1 x 76,1	67	138	115	0,773	1
26C45HH88	88,9 x 88,9	58	134	135	0,991	1
26C45HH108	108,0 x 108,0	72	165	165	1,600	1

**CURVA 45° HM • BEND 45° Ø X PRESS • COUDE 45° FM • BOGEN 45° IA**

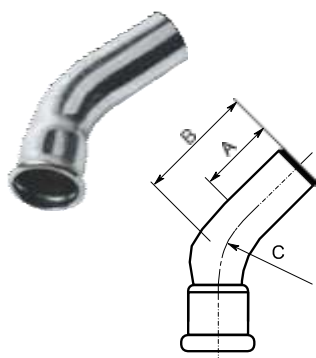

Ref.	Ø	A	B	C	Kg	U./□
26C45HM15	15 x 15	25	36,5	28	0,037	10
26C45HM18	18 x 18	26	36	32	0,041	10
26C45HM22	22 x 22	32	43,5	38	0,060	10
26C45HM28	28 x 28	32	50,3	50	0,082	5
26C45HM35	35 x 35	38	75	68	0,112	5
26C45HM42	42 x 42	40	80	80	0,237	2
26C45HM54	54 x 54	42	106	108	0,366	2
26C45HM76	76,1 x 76,1	71	140	115	0,767	1
26C45HM88	88,9 x 88,9	64	165	135	0,998	1
26C45HM108	108,0 x 108,0	79	190	165	1,510	1

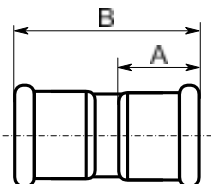

**MANGUITO HH • STRAIGHT COUPLING PRESS X PRESS • MANCHON FF • MUFFE II**

Ref.	Ø	A	B	Kg	U./□
26M15	15 x 15	15	39,5	0,027	10
26M18	18 x 18	16,5	44	0,031	10
26M22	22 x 22	20	51,5	0,043	10
26M28	28 x 28	22,5	61	0,055	5
26M35	35 x 35	26	68	0,076	5
26M42	42 x 42	32	82	0,147	2
26M54	54 x 54	36	90	0,205	2
26M76	76,1 x 76,1	53	148	0,604	1
26M88	88,9 x 88,9	56	170	0,837	1
26M108	108,0 x 108,0	73	197	1,193	1

**MANGUITO SINFIN • SLEEVE COUPLING PRESS X PRESS • MANCHON COULISSANT FF • SCHIEBEMUFFE II**

Ref.	Ø	B	Kg	U./□
26MST15	15 x 15	78	0,033	10
26MST18	18 x 18	77	0,044	10
26MST22	22 x 22	82,5	0,060	10
26MST28	28 x 28	89,5	0,080	5
26MST35	35 x 35	102	0,104	5
26MST42	42 x 42	121	0,216	2
26MST54	54 x 54	142	0,316	2
26MST76	76,1 x 76,1	230	0,874	1
26MST88	88,9 x 88,9	260	1,196	1
26MST108	108,0 x 108,0	310	1,775	1

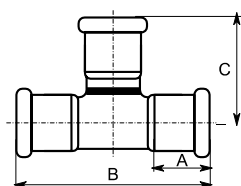
**TE IGUAL SOLDADA • WELDED T-COUPLING 3 X PRESS • SOUDÉ TÉ ÉGAL FEMELLE • T-STÜCK GESCHWEIßT**

Ref.	Ø	A	B	C	Kg	U./□
26T15	15 x 15 x 15	16	67	34	0,047	10
26T18	18 x 18 x 18	17	68,5	34	0,059	10
26T22	22 x 22 x 22	20	75	39	0,078	10
26T28	28 x 28 x 28	26	91	46,5	0,104	5
26T35	35 x 35 x 35	29	110	54	0,132	5
26TW42	42 x 42 x 42	33	117	64	0,275	2
26TW54	54 x 54 x 54	33	146	74,5	0,382	2
26TW76	76,1 x 76,1 x 76,1	54	230	115	1,192	1
26TW88	88,9 x 88,9 x 88,9	58,5	260	127	1,617	1
26TW108	108,0 x 108,0 x 108,0	71	310	160	2,450	1

**TE ROSCADA SOLDADA • WELDED T-COUPLING PRESS X FEMALE X PRESS • TÉ TARAUDÉ SOUDÉ • T-STÜCK GESCHWEIßT IG**

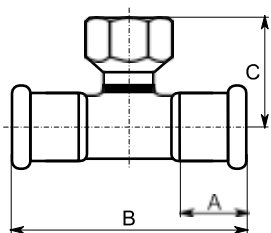

Ref.	Ø	A	B	C	Kg	U./□
26TH15X12	15 x 1/2" x 15	19	63,5	33	0,090	10
26TH18X12	18 x 1/2" x 18	17	68,5	36	0,064	10
26TH18X34	18 x 3/4" x 18	17	67,5	39	0,102	10
26TH22X12	22 x 1/2" x 22	21	75	36,5	0,125	10
26TH22X34	22 x 3/4" x 22	20	75	42	0,105	10
26TH28X12	28 x 1/2" x 28	23	90	36,5	0,092	5
26TH28X34	28 x 3/4" x 28	23	90	44	0,128	5
26TH35X12	35 x 1/2" x 35	26,5	110	39,5	0,173	5
26TH35X34	35 x 3/4" x 35	27,5	110	49	0,180	5
26THW42X12	42 x 1/2" x 42	32,5	117	44	0,240	2
26THW42X34	42 x 3/4" x 42	33	116	48,5	0,254	2
26THW54X12	54 x 1/2" x 54	35	146	48	0,362	2
26THW54X34	54 x 3/4" x 54	35	145	58,5	0,364	2
26THW54X20	54 x 2" x 54	33	146	85	0,523	2
26THW76X34	76,1 x 3/4" x 76,1	54	230	70	1,009	1
26THW76X20	76,1 x 2" x 76,1	54	230	98	1,194	1
26THW88X34	88,9 x 3/4" x 88,9	55,5	260	76	1,210	1
26THW88X20	88,9 x 2" x 88,9	60,5	260	100	1,450	1
26THW108X34	108,0 x 3/4" x 108,0	79	310	86	1,956	1
26THW108X20	108,0 x 2" x 108,0	69	310	112	2,118	1

**TE REDUCCIÓN HHH • T-COUPLING REDUCTION 3 X PRESS • TÉ RÉDUIT • T-STÜCK REDUZIERT**

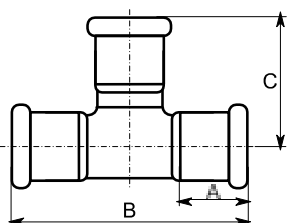

Ref.	Ø	A	B	C	Kg	U./□
26TR18X15	18 x 15 x 18	16,5	68,5	38,5	0,058	10
26TR22X15	22 x 15 x 22	20	75	38,5	0,069	10
26TR22X18	22 x 18 x 22	19	75	36,5	0,074	10
26TR28X15	28 x 15 x 28	21	90	41,5	0,091	5
26TR28X18	28 x 18 x 28	23	91	38,5	0,092	5
26TR28X22	28 x 22 x 28	21	90	43,5	0,098	5
26TR35X15	35 x 15 x 35	29	110	41	0,115	5
26TR35X18	35 x 18 x 35	27	120	42	0,115	5
26TR35X22	35 x 22 x 35	25	110	47	0,120	5
26TR35X28	35 x 28 x 35	27	110	49	0,123	5
26TR42X22	42 x 22 x 42	30	117	51	0,167	2
26TR42X28	42 x 28 x 42	30	117	54	0,233	2
26TR42X35	42 x 35 x 42	30	117	59	0,246	2
26TR54X22	54 x 22 x 54	33	145	57	0,228	2
26TR54X28	54 x 28 x 54	33	145	60	0,345	2
26TR54X35	54 x 35 x 54	33	146	65	0,358	2
26TR54X42	54 x 42 x 54	33	146	70	0,368	2
26TR76X22	76,1 x 22 x 76,1	54	230	67	0,659	1
26TR76X28	76,1 x 28 x 76,1	66	245	73	1,030	1
26TR76X35	76,1 x 35 x 76,1	53	230	77	0,677	1
26TR76X42	76,1 x 42 x 76,1	53	230	82	0,981	1
26TR76X54	76,1 x 54 x 76,1	53	230	85	1,067	1
26TR88X22	88,9 x 22 x 88,9	82	277	74	0,879	1
26TR88X28	88,9 x 28 x 88,9	56	260	81	1,380	1
26TR88X42	88,9 x 42 x 88,9	60	260	85	1,271	1
26TR88X54	88,9 x 54 x 88,9	60	260	88	1,297	1
26TR88X76	88,9 x 76,1 x 88,9	58	260	117	1,479	1
26TR108X22	108,0 x 22 x 108,0	69	310	85	1,343	1
26TR108X28	108,0 x 28 x 108,0	75	310	90	1,357	1
26TR108X35	108,0 x 35 x 108,0	71	310	90	1,369	1
26TR108X42	108,0 x 42 x 108,0	73	310	95	1,886	1
26TR108X54	108,0 x 54 x 108,0	67,5	310	105	1,967	1
26TR108X76	108,0 x 76,1 x 108,0	75	310	126	2,147	1
26TR108X88	108,0 x 88,9 x 108,0	75	310	136	2,255	1

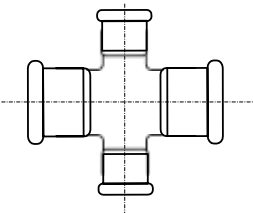
**CRUZ REDUCIDA • CROSSOVER COUPLING 4 X PRESS • CROIX REDUITE • KREUZSTÜCK 90°**

Ref.	Ø	U./□
26CR18X28X28X18	18 x 28 x 28 x 18	2
26CR22X42X42X22	22 x 42 x 42 x 22	2
26CR28X76X76X28	28 x 76,1 x 76,1 x 28	1
26CR28X88X88X28	28 x 88,9 x 88,9 x 28	1
26CR42X76X76X42	42 x 76,1 x 76,1 x 42	1
26CR42X88X88X42	42 x 88,9 x 88,9 x 42	1
26CR42X108X42	42 x 108,0 x 108,0 x 42	1
26CR54X88X88X54	54 x 88,9 x 88,9 x 54	1

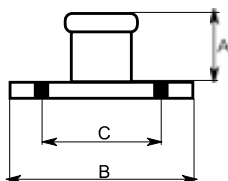
**BRIDA ADAPTADOR • FLANGE WITH PRESS-JOINT • BRIDE À BOUT LISSE • FLANSCH MIT PRESSMUFFE**

Ref.	Ø	A	B	C	Kg	U./□
26BA15	15	47	95	65	0,407	2
26BA18	18	47	95	65	0,413	2
26BA22	22	50	105	75	0,548	2
26BA28	28	29	115	85	0,763	2
26BA35	35	64	140	100	1,201	2
26BA42	42	42	150	110	2,088	2
26BA54	54	47	165	125	2,834	2
26BA76	76,1	71	185	145	3,546	1
26BA88	88,9	79	200	160	4,344	1
26BA108	108,0	97	220	180	5,251	1

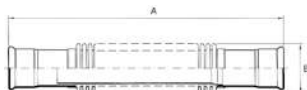
**COMPENSADOR DE DILATACIÓN • EXPANSION COMPENSATOR WITH FLANGES • COMPENSATEUR D'EXPANSION AVEC BRIDES • KOMPENSATOR II / MIT FLANSCHEN**

Ref.	Ø	A	B	Carrera · Stroke · Course · Dehnungsweg (mm)	Kg	U./□
26CD15	15 x 15	320	25	50	0,196	1
26CD18	18 x 18	320	25	50	0,208	1
26CD22	22 x 22	320	30	50	0,263	1
26CD28	28 x 28	320	38	50	0,449	1
26CD35	35 x 35	340	48	50	0,664	1
26CD42	42 x 42	340	54	50	0,840	1
26CD54	54 x 54	400	71	50	1,370	1

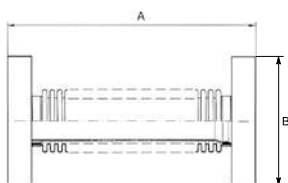

Ref.	Ø	A	B	Carrera · Stroke · Course · Dehnungsweg (mm)	Kg	U./□
26CD76	76,1 x 76,1	286	185	40	7,402	1
26CD88	88,9 x 88,9	290	200	40	9,376	1
26CD108	108,0 x 108,0	280	220	40	10,960	1

**UNIÓN MACHO UNA PIEZA** • ONE PIECE PART STRAIGHT ADAPTER MALE X PRESS • RACCORD FILETÉ MONOBLOC • ÜBERGANG AG EINTEILIG



Ref.	Ø	A	Kg
26UM15X12	15 x 1/2"	42	0,058
26UM18X12	18 x 1/2"	47,5	0,056
26UM18X34	18 x 3/4"	50,5	0,085
26UM22X34	22 x 3/4"	54	0,074
26UM22X10	22 x 1"	58	0,117
26UM28X10	28 x 1"	62	0,118
26UM35X114	35 x 1 1/4"	67	0,175
26UM42X114	42 x 1 1/4"	71	0,275
26UM42X112	42 x 1 1/2"	57	0,280
26UM54X20	54 x 2"	71	0,368

**UNIÓN MACHO SOLDADO** • WELDED STRAIGHT ADAPTER MALE X PRESS • RACCORD FILETÉ SOUDÉ • ÜBERGANG AG GESCHWEIßT

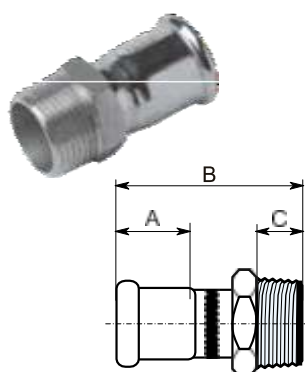

Ref.	Ø	A	B	C	Kg
26UM15X38	15 x 3/8"	17,5	47,5	11,5	0,036
26UMW42X114	42 x 1 1/4"	33	71	15	0,216
26UMW42X112	42 x 1 1/2"	30	57	16	0,204
26UMW54X112	54 x 1 1/2"	36	84,5	16,5	0,271
26UMW54X20	54 x 2"	35	71	22,5	0,368
26UMW76X212	76,1 x 2 1/2"	53,5	123,5	29	0,820
26UMW88X30	88,9 x 3"	60	137	33	1,158

**UNIÓN HEMBRA UNA PIEZA** • ONE PIECE PART STRAIGHT ADAPTER FEMALE X PRESS • RACCORD TARAUDÉ MONOBLOC • ÜBERGANG IG EINTEILIG

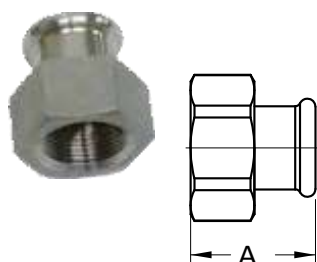

Ref.	Ø	A	Kg
26UH15X12	15 x 1/2"	48,5	0,055
26UH18X12	18 x 1/2"	46,5	0,042
26UH22X34	22 x 3/4"	56	0,078
26UH28X10	28 x 1"	57,5	0,140
26UH35X114	35 x 1 1/4"	79	0,194
26UH42X114	42 x 1 1/4"	53	0,220

**UNIÓN HEMBRA SOLDADA** • WELDED STRAIGHT ADAPTER FEMALE X PRESS • RACCORD TARAUDÉ SOUDÉ • ÜBERGANG IG GESCHWEIßT

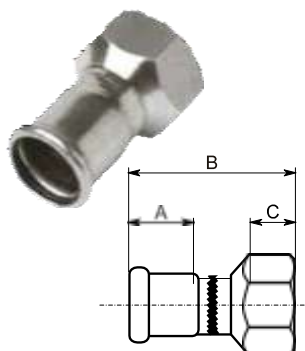

Ref.	Ø	A	B	C	Kg
26UH18X34	18 x 3/4"	16	52	13,5	0,085
26UH22X10	22 x 1"	20,5	53,5	18	0,112
26UHW42X114	42 x 1 1/4"	32,5	83	21	0,221
26UHW42X112	42 x 1 1/2"	31	79	23	0,252
26UHW54X112	54 x 1 1/2"	36	87	23,5	0,328
26UHW54X20	54 x 2"	34,5	98	31,5	0,342
26UHW76X212	76,1 x 2 1/2"	53,5	127,5	30	0,877

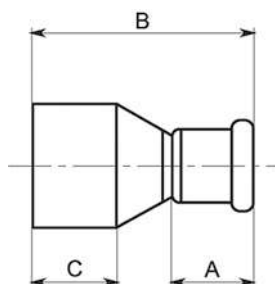
**REDUCCIÓN MH • STRAIGHT COUPLING REDUCTION Ø X PRESS • RÉDUCTION MF • REDUZIERMUFFE IA**

Ref.	Ø	A	B	C	Kg	U./□
26RE18X15	18 x 15	23	52	23	0,028	10
26RE22X15	22 x 15	24	56,5	24	0,032	10
26RE22X18	22 x 18	22	55	25	0,033	10
26RE28X15	28 x 15	24	60	26	0,039	5
26RE28X18	28 x 18	24	59	27	0,043	5
26RE28X22	28 x 22	26,5	60	27	0,046	5
26RE35X22	35 x 22	26	70	30	0,062	5
26RE35X28	35 x 28	31	70	30	0,067	5
26RE42X22	42 x 22	25,5	82	36	0,069	2
26RE42X28	42 x 28	29	82	39	0,078	2
26RE42X35	42 x 35	34	82	41	0,082	2
26RE54X15	54 x 15	26,5	96	45	0,088	2
26RE54X22	54 x 22	26	102	41	0,088	2
26RE54X28	54 x 28	30,5	94	41	0,098	2
26RE54X35	54 x 35	34	91	39	0,084	2
26RE54X42	54 x 42	39	97	47	0,191	2
26RE76X42	76,1 x 42	151	119	82	0,395	1
26RE76X54	76,1 x 54	42	150	80	0,451	1
26RE88X54	88,9 x 54	43	166	70	0,586	1
26RE88X76	88,9 x 76,1	71	163	80	0,653	1
26RE108X54	108,0 x 54	117	245	42	0,880	1
26RE108X76	108,0 x 76,1	71	203	95	0,978	1
26RE108X88	108,0 x 88,9	80	205	95	0,992	1

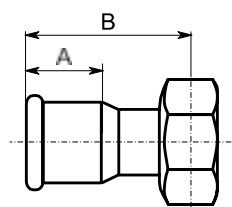
**RACOR 2 PIEZAS CON CUELLO • JOINT CONNECTOR FEMALE X PRESS • ÉCROU TOURNANT • ÜBERGANGSMUFFE IG**

Ref.	Ø	A	B	Kg	U./□
26RP15X12	15 x 1/2"	19	36,5	0,042	10
26RP15X34	15 x 3/4"	19	43	0,060	10
26RP18X12	18 x 1/2"	20	38	0,043	10
26RP18X34	18 x 3/4"	21,5	37	0,079	10
26RP22X34	22 x 3/4"	22	43	0,082	10
26RP22X10	22 x 1"	21,5	51	0,149	10
26RP28X10	28 x 1"	24	52	0,157	5
26RP28X114	28 x 1 1/4"	28	48	0,218	5
26RP35X114	35 x 1 1/4"	30	52	0,259	5
26RP42X112	42 x 1 1/2"	32	57,5	0,278	2
26RP54X20	54 x 2"	35	77	0,586	2
26RP54X212	54 x 2 1/2"	35	77	0,954	2
26RP76X212	76,1 x 2 1/2"	53,5	114,5	1,125	1

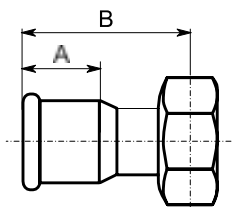
**RACOR 2 PIEZAS CON JUNTA PLANA • JOINT CONNECTOR FEMALE X PRESS • ÉCROU TOURNANT JOINT FLAT • ÜBERGANGSMUFFE IG - FLACHDICHTEND**

Ref.	Ø	A	B	Kg	U./□
26RPJP15X12	15 x 1/2"	19,5	37	0,040	10
26RPJP15X34	15 x 3/4"	19,5	38,5	0,057	10
26RPJP18X12	18 x 1/2"	17	33,5	0,041	10
26RPJP18X34	18 x 3/4"	17	38	0,055	10
26RPJP22X34	22 x 3/4"	22,5	41	0,081	10
26RPJP22X10	22 x 1"	27	43	0,068	10
26RPJP28X10	28 x 1"	24	50,5	0,155	5
26RPJP28X114	28 x 1 1/4"	24	48	0,104	5
26RPJP35X114	35 x 1 1/4"	29	52	0,272	5
26RPJP42X112	42 x 1 1/2"	33	57	0,174	2
26RPJP42X20	42 x 2"	36	69	0,562	2
26RPJP54X20	54 x 2"	36	76	0,592	2
26RPJP54X238	54 x 2 3/8"	27	50	0,312	2
26RPJP54X212	54 x 2 1/2"	36	133	0,941	2
26RPJP76X212	76,1 x 2 1/2"	53,5	113	0,312	1

**RACOR 3 PIEZAS CÓNICO** • JOINT CONNECTOR PRESS X PRESS • RACCORD CONIQUE • VERSCHRAUBUNG MIT PRESSMUFFEN



Ref.	Ø	A	B	Kg
26RTP42	42 x 42	60	127	0,461
26RTP54	54 x 54	58	146	0,759

**CODO MACHO SOLDADO** • WELDED ELBOW TRANSITION MALE X PRESS • COUDE FILETÉ SOUDÉ • WINKEL 90° GESCHWEIßT AG

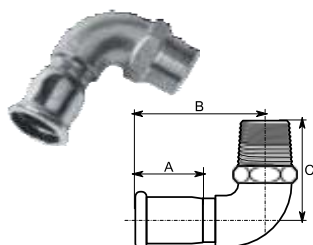

Ref.	Ø	A	B	C	Kg	U./□
26CM15X12	15 x 1/2"	18	49	36	0,093	10
26CM18X12	18 x 1/2"	23	48	36	0,091	10
26CMW42X112	42 x 1 1/2"	31	136	67	0,376	2
26CMW54X20	54 x 2"	97	155	70	0,667	2

**CODO HEMBRA SOLDADO** • WELDED ELBOW TRANSITION FEMALE X PRESS • COUDE TARAUDÉ SOUDÉ • WINKEL 90° GESCHWEIßT IG

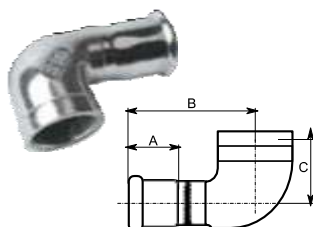

Ref.	Ø	A	B	C	Kg	U./□
26CH15X12	15 x 1/2"	19	49,5	27	0,071	10
26CH18X12	18 x 1/2"	16	48	27	0,082	10
26CH22X34	22 x 3/4"	22	56	30	0,134	10
26CH28X12	28 x 1/2"	25	57	27,5	0,097	5

**CODO PLACA SOLDADO** • WELDED WALLPLATE FEMALE X PRESS • COUDE TARAUDÉ AVEC APPLIQUE SOUDÉ • DECKENWINKEL 90° GESCHWEIßT IG

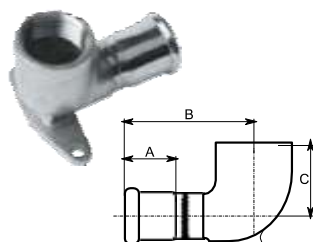

Ref.	Ø	A	B	C	Kg	U./□
26CF15X12	15 x 1/2"	18,5	47,5	27	0,100	10
26CF18X12	18 x 1/2"	20	48	27	0,118	10
26CF22X34	22 x 3/4"	24	53,5	30	0,142	10
26CF28X10	28 x 1"	28	68,5	39	0,206	5

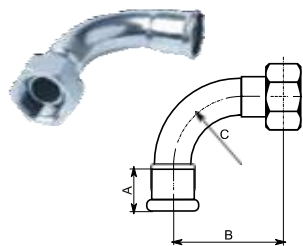
**CURVA 2 PIEZAS • BEND 2 PIECES • COUDE ÉCROU TOURNANT • ÜBERGANGSWINKEL 90° IG**

Ref.	Ø	A	B	C	Kg	U./□
26CP15X12	15 x 1/2"	16,5	45	28	0,057	10
26CP18X12	18 x 1/2"	19	51	32	0,066	10
26CP18X34	18 x 3/4"	19	54,5	32	0,103	10
26CP22X34	22 x 3/4"	22	67,5	38	0,114	10
26CP22X10	22 x 1"	22	72,5	38	0,181	10

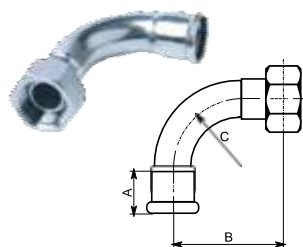
**CURVA 2 PIEZAS JUNTA PLANA • BEND 2 PIECES FLAT JOINT • COUDE ÉCROU TOURNANT JOINT FLAT • ÜBERGANGSWINKEL 90° IG - FLACHDICHTEND**

Ref.	Ø	A	B	C	Kg	U./□
26CPJP18X12	18 x 1/2"	19	51	32	0,065	10
26CPJP18X34	18 x 3/4"	19	54,5	32	0,098	10
26CPJP22X34	22 x 3/4"	22	67,5	38	0,150	10
26CPJP22X10	22 x 1"	22	72,5	38	0,172	10

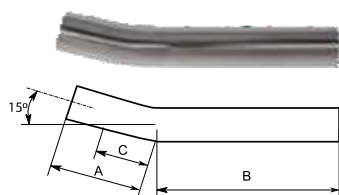
**CURVA DE AJUSTE 15° • BEND 15° • COUDE D'AJUSTEMENT 15° • PASSBOGEN 15° AA**

Ref.	Ø	A	B	C	Kg	U./□
26CA1528	28 x 28	67	134	48	0,193	5
26CA1535	35 x 35	78	222	53	0,372	5
26CA1542	42 x 42	121	280	59	0,575	2
26CA1554	54 x 54	140	337	67	0,837	2

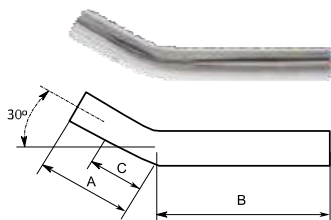
**CURVA DE AJUSTE 30° • BEND 30° • COUDE D'AJUSTEMENT 30° • PASSBOGEN 30° AA**

Ref.	Ø	A	B	C	Kg	U./□
26CA3028	28 x 28	70	130	54	0,195	5
26CA3035	35 x 35	86	214	60	0,372	5
26CA3042	42 x 42	135	265	69	0,576	2
26CA3054	54 x 54	136	326	79	0,845	2

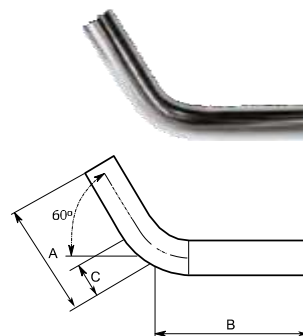
**CURVA DE AJUSTE 60° • BEND 60° • COUDE D'AJUSTEMENT 60° • PASSBOGEN 60° AA**

Ref.	Ø	A	B	C	Kg	U./□
26CA6028	28 x 28	67	134	48	0,193	5
26CA6035	35 x 35	78	222	53	0,372	5
26CA6042	42 x 42	121	280	59	0,575	2
26CA6054	54 x 54	140	337	67	0,837	2

**CURVA DE AJUSTE 90° • BEND 90° • COUDE D'AJUSTEMENT 90° • PASSBOGEN 90° AA**

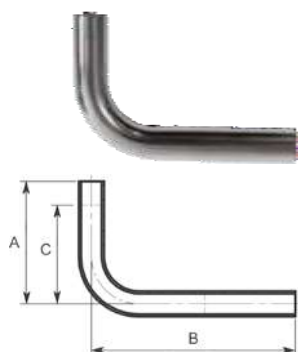

Ref.	Ø	A	B	C	Kg	U./□
26CA9015	15 x 15	75	122	58	0,059	10
26CA9018	18 x 18	74	120	63	0,106	10
26CA9022	22 x 22	77	120	70	0,134	10
26CA9028	28 x 28	102	120	80	0,155	5
26CA9035	35 x 35	130	200	100	0,364	5
26CA9042	42 x 42	185	250	120	0,575	2
26CA9054	54 x 54	207	300	145	0,846	2

**CURVA DESVIACIÓN MH • BY-PASS BEND Ø X PRESS • BAÏONETTE MF • SPRUNGBOGEN IA**

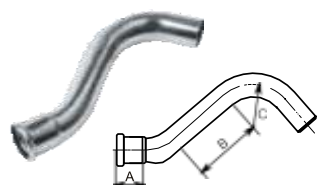

Ref.	Ø	A	B	C	Kg	U./□
26CDHM15	15 x 15	15,5	43	28	0,052	10
26CDHM18	18 x 18	18	51	32	0,070	10
26CDHM22	22 x 22	19,5	43	38	0,070	10

**CURVA DESVIACIÓN CISNE • COMPRESSED AIR BEND • CROSSE D'ÉVÊQUE • DRUCKLUFT-ROHRBOGEN**

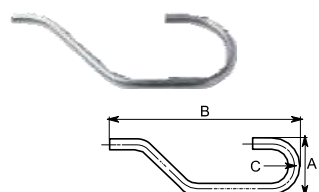

Ref.	Ø	A	B	C	Kg	U./□
26CC15	15 x 15	98	306	41	0,164	5
26CC18	18 x 18	144	370	63	0,197	5
26CC22	22 x 22	170	410	73	0,210	5

**SALTATUBOS • STRAIGHT BY-PASS Ø X Ø • CHAPEAU DE GENDARME • ÜBERSPRUNGBOGEN AA**

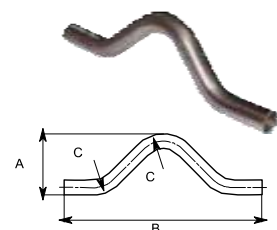

Ref.	Ø	A	B	C	Kg	U./□
26ST15	15 x 15	62	200	28	0,074	10
26ST18	18 x 18	73	230	32	0,111	10
26ST22	22 x 22	75	255	38	0,143	10
26ST28	28 x 28	94	280	50	0,220	5

**TAPÓN • ENDCAP PRESS • BOUCHON F • VERSCHLUSSKAPPE**

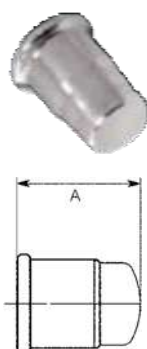

Ref.	Ø	A	B	Kg	U./□
26TA15	15	19	34,5	0,019	10
26TA18	18	22	39	0,023	10
26TA22	22	21,5	37,5	0,031	10
26TA28	28	26,5	43	0,044	5
26TA35	35	29	49	0,056	5
26TA42	42	31	54,5	0,119	2
26TA54	54	34	63	0,171	2
26TA76	76,1	53,5	97	0,427	1
26TA88	88,9	57,5	108	0,559	1
26TA108	108,0	75	129	0,821	1



**TUBO SANITARIO EN-10312 (AISI-304L) • SANITARY PIPE EN-10312 (AISI-304L) • TUBE SANITAIRE EN-10312 (AISI-304L) • SANITÄR-ROHR EN-10312 (EDELSTAHL 1.4307)**



Tubo Brillante Picked Pipe Tube Standard Standar Rohr Ref.	Tubo Pulido Mirror Polished Pipe Tube Poli Miroir Poliertes Rohr Ref.	Ø x Espesor / Thickness / Épaisseur / Dicke	Largo / Length/ Longeur / Länge (mm)	Peso / Weight / Poid / Gewicht (+/-) Kg/m	Presión de Trabajo / Working Pressure / Pression de Service / Arbeitsdruck Kg/cm	U. /
10210X06	102P10X06	10 x 0,6	5.000	0,141	133	720
10212X06	102P12X06	12 x 0,6	5.000	0,171	111	720
10215X06	102P15X06	15 x 0,6	5.000	0,216	88	425
10218X07	102P18X07	18 x 0,7	5.000	0,303	86	425
10222X07	102P22X07	22 x 0,7	5.000	0,373	70	425
10228X08	102P28X08	28 x 0,8	5.000	0,545	63	425
10235X10	102P35X10	35 x 1,0	5.000	0,851	63	280
10242X12	102P42X12	42 x 1,2	5.000	1,226	63	280
10254X12	102P54X12	54 x 1,2	5.000	1,587	49	220
122761X20	122P761X20	76,1 x 2,0	6.000	3,711	58	144
122889X20	122P889X20	88,9 x 2,0	6.000	4,352	49	114
122108X20	122P108X20	108,0 x 2,0	6.000	5,308	41	114

**TUBO SANITARIO EN-10312 (AISI-316L) • SANITARY PIPE EN-10312 (AISI-316L) • TUBE SANITAIRE EN-10312 (AISI-316L) • SANITÄR-ROHR EN-10312 (EDELSTAHL 1.4404)**



Tubo Brillante Picked Pipe Tube Standard Standar Rohr Ref.	Tubo Pulido Mirror Polished Pipe Tube Poli Miroir Poliertes Rohr Ref.	Ø x Espesor / Thickness / Épaisseur / Dicke	Largo / Length/ Longeur / Länge (mm)	Peso / Weight / Poid / Gewicht (+/-)Kg/m	Presión de Trabajo / Working Pressure / Pression de Service / Arbeitsdruck Kg/cm	U. /
10410X06	104P10X06	10 x 0,6	5.000	0,141	133	720
10412X06	104P12X06	12 x 0,6	5.000	0,171	111	720
10415X06	104P15X06	15 x 0,6	5.000	0,216	88	425
10418X07	104P18X07	18 x 0,7	5.000	0,303	86	425
10422X07	104P22X07	22 x 0,7	5.000	0,373	70	425
10428X08	104P28X08	28 x 0,8	5.000	0,545	63	425
10435X10	104P35X10	35 x 1,0	5.000	0,851	63	280
10442X12	104P42X12	42 x 1,2	5.000	1,226	63	280
10454X12	104P54X12	54 x 1,2	5.000	1,587	49	220

**TUBO SANITARIO DVGW (AISI-316L) • SANITARY PIPE DVGW (AISI-316L) • TUBE SANITAIRE DVGW (AISI-316L) • SANITÄR-ROHR DVGW (EDELSTAHL 1.4404)**



Tubo Brillante Picked Pipe Tube Standard Standar Rohr Ref.	Tubo Pulido Mirror Polished Pipe Tube Poli Miroir Poliertes Rohr Ref.	Ø x Espesor / Thickness / Épaisseur / Dicke	Largo / Length/ Longeur / Länge (mm)	Peso / Weight / Poid / Gewicht (+/-)Kg/m	Presión de Trabajo / Working Pressure / Pression de Service / Arbeitsdruck Kg/cm	U. /
12415X10	124P15X10	15 x 1,0	6.000	0,351	147	510
12418X10	124P18X10	18 x 1,0	6.000	0,426	123	510
12422X12	124P22X12	22 x 1,2	6.000	0,625	121	510
12428X12	124P28X12	28 x 1,2	6.000	0,805	95	510
12435X15	124P35X15	35 x 1,5	6.000	1,258	95	336
12442X15	124P42X15	42 x 1,5	6.000	1,521	79	336
12454X15	124P54X15	54 x 1,5	6.000	1,972	61	265
124761X20	124P761X20	76,1 x 2,0	6.000	3,711	58	144
124889X20	124P889X20	88,9 x 2,0	6.000	4,352	49	114
124108X20	124P108X20	108,0 x 2,0	6.000	5,308	41	114

**CURVA 90° HH • BEND 90° PRESS X PRESS • COUDE 90° FF • BOGEN 90° II**



Ref.	Ø	A	Kg	U./□
27C90HH15	15 x 15	47	0,057	10
27C90HH18	18 x 18	55	0,077	10
27C90HH22	22 x 22	62	0,097	10
27C90HHRC28	28 x 28	65	0,143	5
27C90HHRC35	35 x 35	75	0,198	5
26C90HHRC42	42 x 42	94	0,314	2
26C90HHRC54	54 x 54	108	0,499	2
26C90HHRC76	76,1 x 76,1	162	0,977	1
26C90HH88	88,9 x 88,9	219	1,325	1
26C90HH108	108,0 x 108,0	266	2,091	1

**CURVA 90° HM • BEND 90° Ø X PRESS • COUDE 90° FM • BOGEN 90° IA**



Ref.	Ø	A	B	Kg	U./□
27C90HM15	15 x 15	47	55	0,058	10
27C90HM18	18 x 18	55	62	0,070	10
27C90HM22	22 x 22	62	68	0,098	10
27C90HMRC28	28 x 28	65	73	0,147	5
27C90HMRC35	35 x 35	75	80	0,200	5
26C90HMRC42	42 x 42	93	103	0,260	2
26C90HMRC54	54 x 54	105	120	0,400	2
26C90HMRC76	76,1 x 76,1	165	183	0,982	1
26C90HM88	88,9 x 88,9	222	240	1,317	1
26C90HM108	108,0 x 108,0	268	290	2,068	1

**CURVA 45° HH • BEND 45° PRESS X PRESS • COUDE 45° FF • BOGEN 45° II**



Ref.	Ø	A	Kg	U./□
27C45HH15	15 x 15	36	0,049	10
27C45HH18	18 x 18	37	0,059	10
27C45HH22	22 x 22	39	0,081	10
27C45HH28	28 x 28	49	0,118	5
27C45HH35	35 x 35	56	0,161	5
26C45HH42	42 x 42	72	0,254	2
26C45HH54	54 x 54	85	0,369	2
26C45HH76	76,1 x 76,1	138	0,773	1
26C45HH88	88,9 x 88,9	154	0,991	1
26C45HH108	108,0 x 108,0	165	1,600	1

**CURVA 45° HM • BEND 45° Ø X PRESS • COUDE 45° FM • BOGEN 45° IA**



Ref.	Ø	A	B	Kg	U./□
27C45HM15	15 x 15	33	47	0,053	10
27C45HM18	18 x 18	35	48	0,059	10
27C45HM22	22 x 22	37	48	0,085	10
27C45HM28	28 x 28	47	50	0,117	5
27C45HM35	35 x 35	55	63	0,160	5
26C45HM42	42 x 42	72	80	0,237	2
26C45HM54	54 x 54	85	106	0,366	2
26C45HM76	76,1 x 76,1	138	140	0,767	1
26C45HM88	88,9 x 88,9	154	165	0,998	1
26C45HM108	108,0 x 108,0	165	190	1,510	1

**MANGUITO HH • STRAIGHT COUPLING PRESS X PRESS • MANCHON FF • MUFFE II**



Ref.	Ø	A	Kg	U./□
27M15	15 x 15	49	0,039	10
27M18	18 x 18	49	0,044	10
27M22	22 x 22	54	0,062	10
27M28	28 x 28	56	0,078	5
27M35	35 x 35	64	0,109	5
26M42	42 x 42	82	0,147	2
26M54	54 x 54	90	0,205	2
26M76	76,1 x 76,1	148	0,604	1
26M88	88,9 x 88,9	170	0,837	1
26M108	108,0 x 108,0	197	1,193	1

**MANGUITO SINFÍN • SLEEVE COUPLING PRESS X PRESS • MANCHON COULISSANT FF • SCHIEBEMUFFE II**

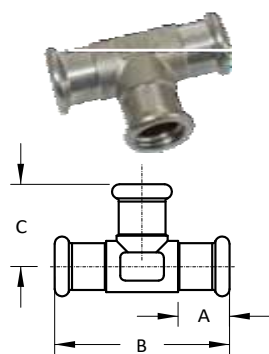
Ref.	Ø	A	Kg	U./□
27MST15	15 x 15	85	0,047	10
27MST18	18 x 18	82	0,063	10
27MST22	22 x 22	84	0,085	10
27MST28	28 x 28	92	0,114	5
27MST35	35 x 35	104	0,149	5
26MST42	42 x 42	121	0,216	2
26MST54	54 x 54	142	0,316	2
26MST76	76,1 x 76,1	230	0,874	1
26MST88	88,9 x 88,9	260	1,196	1
26MST108	108,0 x 108,0	310	1,775	1

**TE IGUAL UNA PIEZA • ONE PIECE PART T-COUPLING 3 X PRESS • MONOBLOC TÉ ÉGAL FEMELLE • T-STÜCK EINTEILIG**

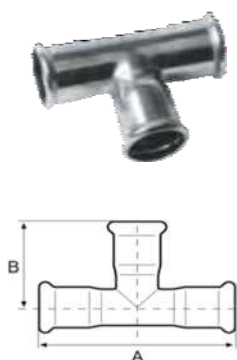
Ref.	Ø	A	B	C	Kg	U./□
27T15	15 x 15 x 15	20	68	32	0,087	10
27T18	18 x 18 x 18	20	74	33	0,096	10
27T22	22 x 22 x 22	21	80	40	0,105	10
27T28	28 x 28 x 28	23	90	42	0,149	5
27T35	35 x 35 x 35	26	94	50	0,155	5

**TE IGUAL SOLDADA • WELDED T-COUPLING 3 X PRESS • SOUDÉ TÉ ÉGAL FEMELLE • T-STÜCK GESCHWEIßT**

Ref.	Ø	A	B	Kg	U./□
27TW15	15 x 15 x 15	67	34	0,047	10
27TW18	18 x 18 x 18	68,5	34	0,059	10
27TW22	22 x 22 x 22	75	39	0,078	10
27TW28	28 x 28 x 28	91	46,5	0,104	5
27TW35	35 x 35 x 35	110	54	0,132	5
26TW42	42 x 42 x 42	117	64	0,275	2
26TW54	54 x 54 x 54	146	74,5	0,382	2
26TW76	76,1 x 76,1 x 76,1	230	115	1,192	1
26TW88	88,9 x 88,9 x 88,9	260	127	1,617	1
26TW108	108,0 x 108,0 x 108,0	310	160	2,450	1

**TE ROSCADA UNA PIEZA** • OPP T-COUPLING PRESS X FEMALE X PRESS • MONOBLOC TÉ TARAUDÉ • T-STÜCK EINTEILIG IG

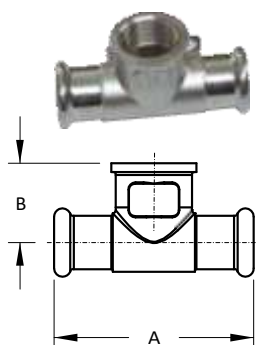

Ref.	Ø	A	B	Kg	U./□
27TH15X12	15 x 1/2" x 15	68	33	0,083	10
27TH22X12	22 x 1/2" x 22	80	39	0,117	10
27TH22X34	22 x 3/4" x 22	86	36,5	0,140	10
27TH28X12	28 x 1/2" x 28	90	42	0,148	5
27TH28X34	28 x 3/4" x 28	90	36,5	0,159	5
27TH35X12	35 x 1/2" x 35	90	44	0,178	5
27TH35X34	35 x 3/4" x 35	90	39,5	0,189	5

**TE ROSCADA SOLDADA** • WELDED T-COUPLING PRESS X FEMALE X PRESS • TÉ TARAUDÉ SOUDÉ • T-STÜCK GESCHWEIßT IG

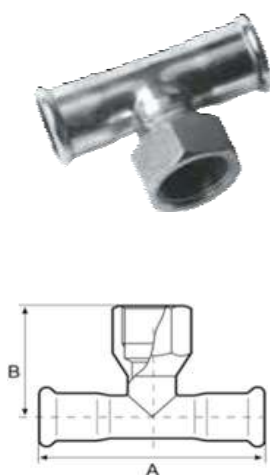

Ref.	Ø	A	B	Kg	U./□
27THW15X12	15 x 1/2"	68	33	0,083	10
27THW18X12	18 x 1/2"	69	35	0,095	10
27THW18X34	18 x 3/4"	69	40	0,118	10
27THW22X12	22 x 1/2"	75	33	0,117	10
27THW22X34	22 x 3/4"	76	43	0,131	10
27THW28X12	28 x 1/2"	85	37	0,144	5
27THW28X34	28 x 3/4"	85	46	0,159	5
27THW28X10	28 x 1"	92	48	0,174	5
27THW35X12	35 x 1/2"	102	40	0,178	5
27THW35X34	35 x 3/4"	102	50	0,189	5
26THW42X12	42 x 1/2"	116	44	0,240	2
26THW42X34	42 x 3/4"	116	49	0,254	2
26THW54X12	54 x 1/2"	146	48	0,362	2
26THW54X34	54 x 3/4"	146	59	0,364	2
26THW54X20	54 x 2"	146	85	0,523	2
26THW76X34	76,1 x 3/4"	230	70	1,009	1
26THW76X20	76,1 x 2"	230	98	1,194	1
26THW88X34	88,9 x 3/4"	260	76	1,210	1
26THW88X20	88,9 x 2"	260	100	1,450	1
26THW108X34	108,0 x 3/4"	310	86	1,956	1
26THW108X20	108,0 x 2"	310	112	2,118	1

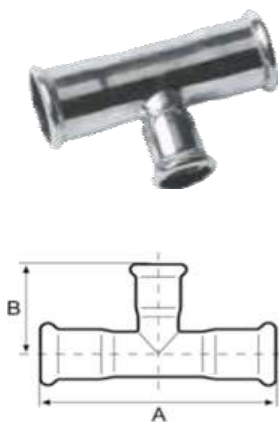
**TE REDUCCIÓN HHH • T-COUPLING REDUCTION 3 X PRESS • TÉ RÉDUIT • T-STÜCK REDUZIERT**

Ref.	Ø	A	B	Kg	U./□
27TR18X15	18 x 15 x 18	68,5	16,5	0,083	10
27TR22X15	22 x 15 x 22	75	20	0,098	10
27TR22X18	22 x 18 x 22	75	19	0,105	10
27TR28X15	28 x 15 x 28	90	21	0,130	5
27TR28X18	28 x 18 x 28	91	23	0,132	5
27TR28X22	28 x 22 x 28	90	21	0,140	5
27TR35X15	35 x 15 x 35	110	29	0,164	5
27TR35X18	35 x 18 x 35	120	27	0,164	5
27TR35X22	35 x 22 x 35	110	25	0,172	5
27TR35X28	35 x 28 x 35	110	27	0,175	5
27TR42X22	42 x 22 x 42	117	30	0,239	2
27TR42X28	42 x 28 x 42	117	30	0,240	2
27TR42X35	42 x 35 x 42	117	30	0,242	2
27TR54X22	54 x 22 x 54	145	33	0,325	2
27TR54X28	54 x 28 x 54	145	33	0,348	2
27TR54X35	54 x 35 x 54	146	33	0,344	2
26TR54X42	54 x 42 x 54	146	33	0,368	2
27TR76X22	76,1 x 22 x 76,1	230	54	0,942	1
27TR76X28	76,1 x 28 x 76,1	245	66	0,956	1
26TR76X35	76,1 x 35 x 76,1	230	53	0,968	1
26TR76X42	76,1 x 42 x 76,1	230	53	0,981	1
26TR76X54	76,1 x 54 x 76,1	230	53	1,067	1
27TR88X22	88,9 x 22 x 88,9	277	82	1,256	1
27TR88X28	88,9 x 28 x 88,9	260	56	1,244	1
27TR88X35	88,9 x 35 x 88,9	260	60	1,267	1
26TR88X42	88,9 x 42 x 88,9	260	60	1,271	1
26TR88X54	88,9 x 54 x 88,9	260	60	1,297	1
26TR88X76	88,9 x 76,1 x 88,9	260	58	1,479	1
27TR108X22	108,0 x 22 x 108,0	310	69	1,919	1
27TR108X28	108,0 x 28 x 108,0	310	75	1,939	1
27TR108X35	108,0 x 35 x 108,0	310	71	1,955	1
26TR108X42	108,0 x 42 x 108,0	310	73	1,886	1
26TR108X54	108,0 x 54 x 108,0	310	67,5	1,967	1
26TR108X76	108,0 x 76,1 x 108,0	310	75	2,147	1
26TR108X88	108,0 x 88,9 x 108,0	310	75	2,255	1

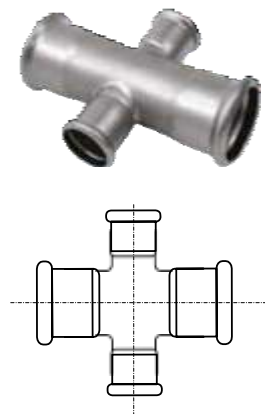
**CRUZ REDUCIDA • CROSSOVER COUPLING 4 X PRESS • CROIX RÉDUITE • KREUZSTÜCK 90°**

Ref.	Ø	U./□
27CR42X35X42X35	42 x 35 x 42 x 35	1
26CR42X76X76X42	42 x 76,1 x 76,1 x 42	1
26CR42X88X88X42	42 x 88,9 x 88,9 x 42	1
26CR42X108X42	42 x 108,0 x 108,0 x 42	1
27CR54X35X54X35	54 x 35 x 54 x 35	1
26CR54X88X88X54	54 x 88,9 x 88,9 x 54	1

**BRIDA ADAPTADOR • FLANGE WITH PRESS-JOINT • BRIDE À BOUT LISSE • FLANSCH MIT PRESSMUFFE**

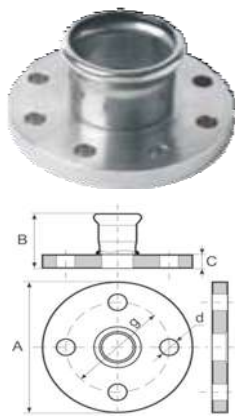

Ref.	Ø	A	B	C	Kg	U./□
27BA15	15	95	40	14	0,582	2
27BA18	18	95	43	14	0,590	2
27BA22	22	105	47	14	0,783	2
27BA28	28	115	50	18	1,091	2
27BA35	35	140	54	18	1,717	2
26BA42	42	150	59	110	2,088	2
26BA54	54	165	62	125	2,834	2
26BA76	76,1	185	102	145	3,546	1
26BA88	88,9	200	97	160	4,344	1
26BA108	108,0	220	122	180	5,251	1

**COMPENSADOR DE DILATACIÓN • EXPANSION COMPENSATOR WITH FLANGES • COMPENSATEUR D'EXPANSION AVEC BRIDES • KOMPENSATOR II / MIT FLANSCHEN**

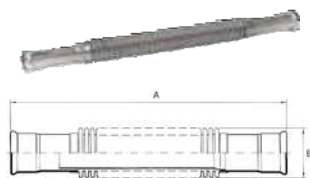

Ref.	Ø	A	B	Carrera · Stroke · Course · Dehnungsweg (mm)	Kg	U./□
27CD15	15	320	25	50	0,220	1
27CD18	18	320	25	50	0,220	1
27CD22	22	320	30	50	0,270	1
27CD28	28	320	38	50	0,460	1
27CD35	35	340	48	50	0,650	1
26CD42	42	340	54	50	0,840	1
26CD54	54	400	71	50	1,370	1

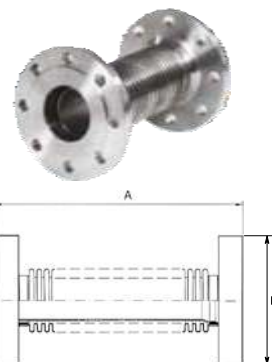

Ref.	Ø	A	B	Carrera · Stroke · Course · Dehnungsweg (mm)	Kg	U./□
26CD76	76,1	286	185	40	7,402	1
26CD88	88,9	290	200	40	9,376	1
26CD108	108,0	280	220	40	10,960	1

**UNIÓN MACHO UNA PIEZA • ONE PIECE PART STRAIGHT ADAPTER MALE X PRESS • RACCORD FILETÉ MONOBLOC • ÜBERGANG AG EINTEILIG**



Ref.	Ø	A	Kg	U./□
27UM15X12	15 x 1/2"	41	0,060	10
27UM18X12	18 x 1/2"	42	0,085	10
27UM18X34	18 x 3/4"	44	0,095	10
27UM22X12	22 x 1/2"	42	0,070	10
27UM22X34	22 x 3/4"	44	0,110	10
27UM22X10	22 x 1"	46	0,110	10
27UM28X34	28 x 3/4"	46	0,120	5
27UM28X10	28 x 1"	48	0,180	5
27UM35X114	35 x 1 1/4"	53	0,230	5
26UM42X114	42 x 1 1/4"	71	0,275	2
26UM42X112	42 x 1 1/2"	57	0,280	2
26UM54X20	54 x 2"	71	0,368	2

**UNIÓN MACHO SOLDADO** • WELDED STRAIGHT ADAPTER MALE X PRESS • RACCORD FILETÉ SOUDÉ • ÜBERGANG AG GESCHWEIßT



Ref.	Ø	A	Kg	U./□
27UMW15X38	15 x 3/8"	47,5	0,050	10
27UMW15X12	15 x 1/2"	41	0,052	10
27UMW15X34	15 x 3/4"	43	0,066	10
27UMW18X12	18 x 1/2"	42	0,053	10
27UMW18X34	18 x 3/4"	44	0,067	10
27UMW22X12	22 x 1/2"	42	0,073	10
27UMW22X34	22 x 3/4"	44	0,074	10
27UMW22X10	22 x 1"	46	0,116	10
27UMW28X34	28 x 3/4"	46	0,100	5
27UMW28X10	28 x 1"	48	0,115	5
27UMW28X114	28 x 1 1/4"	84,5	0,172	5
27UMW35X10	35 x 1"	73	0,148	5
27UMW35X114	35 x 1 1/4"	53	0,165	5
27UMW35X112	35 x 1 1/2"	137	0,198	5
26UMW42X114	42 x 1 1/4"	71	0,216	2
26UMW42X112	42 x 1 1/2"	57	0,204	2
26UMW54X112	54 x 1 1/2"	84	0,271	2
26UMW54X20	54 x 2"	71	0,368	2
26UMW76X212	76,1 x 2 1/2"	123	0,820	1
26UMW88X30	88,9 x 3"	135	1,158	1

**UNIÓN HEMBRA UNA PIEZA** • ONE PIECE PART STRAIGHT ADAPTER FEMALE X PRESS • RACCORD TARAUDÉ MONOBLOC • ÜBERGANG IG EINTEILIG

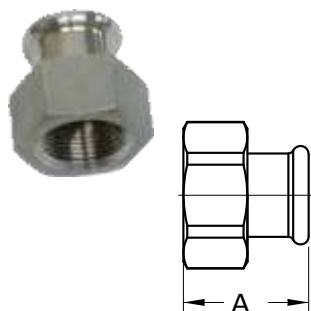

Ref.	Ø	A	Kg	U./□
27UH15X12	15 x 1/2"	37	0,052	10
27UH18X12	18 x 1/2"	37	0,068	10
27UH18X34	18 x 3/4"	38	0,077	10
27UH22X12	22 x 1/2"	36	0,090	10
27UH22X34	22 x 3/4"	39	0,110	10
27UH22X10	22 x 1"	42	0,105	10
27UH28X10	28 x 1"	44	0,121	5
27UH35X114	35 x 1 1/4"	49	0,332	5
26UH42X114	42 x 1 1/4"	53	0,219	2

**UNIÓN HEMBRA SOLDADA** • WELDED STRAIGHT ADAPTER FEMALE X PRESS • RACCORD TARAUDÉ SOUDÉ • ÜBERGANG IG GESCHWEIßT



Ref.	Ø	A	Kg	U./□
27UHW15X12	15 x 1/2"	37	0,052	10
27UHW15X34	15 x 3/4"	38	0,081	10
27UHW18X12	18 x 1/2"	37	0,052	10
27UHW18X34	18 x 3/4"	38	0,077	10
27UHW22X12	22 x 1/2"	36	0,077	10
27UHW22X34	22 x 3/4"	39	0,075	10
27UHW22X10	22 x 1"	42	0,105	10
27UHW28X34	28 x 3/4"	62	0,105	5
27UHW28X10	28 x 1"	44	0,103	5
27UHW28X114	28 x 1 1/4"	94	0,171	5
27UHW35X10	35 x 1"	79	0,136	5
27UHW35X114	35 x 1 1/4"	49	0,170	5
27UHW35X112	35 x 1 1/2"	98	0,259	5
26UHW42X114	42 x 1 1/4"	53	0,221	2
26UHW42X112	42 x 1 1/2"	79	0,252	2
26UHW54X112	54 x 1 1/2"	87	0,328	2
26UHW54X20	54 x 2"	62	0,342	2
26UHW76X212	76,1 x 2 1/2"	127	0,993	1

**REDUCCIÓN MH** • STRAIGHT COUPLING REDUCTION Ø X PRESS • RÉDUCTION MF • REDUZIERMUFFE IA

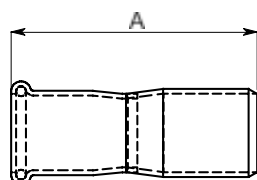

Ref.	Ø	A	Kg	U./□
27RE18X15	18 x 15	58	0,040	10
27RE22X15	22 x 15	59	0,045	10
27RE22X18	22 x 18	55	0,047	10
27RE28X15	28 x 15	64	0,056	5
27RE28X18	28 x 18	65	0,061	5
27RE28X22	28 x 22	57	0,065	5
27RE35X15	35 x 15	71	0,089	5
27RE35X18	35 x 18	87	0,096	5
27RE35X22	35 x 22	74	0,098	5
27RE35X28	35 x 28	68	0,112	5
27RE42X15	42 x 15	91	0,118	2
27RE42X18	42 x 18	96	0,126	2
27RE42X22	42 x 22	84	0,125	2
27RE42X28	42 x 28	84	0,140	2
27RE42X35	42 x 35	87	0,120	2
27RE54X15	54 x 15	110	0,197	2
27RE54X18	54 x 18	113	0,200	2
27RE54X22	54 x 22	107	0,191	2
27RE54X28	54 x 28	94	0,193	2
27RE54X35	54 x 35	93	0,237	2
26RE54X42	54 x 42	97	0,191	2
26RE76X42	76,1 X 42	151	0,415	1
26RE76X54	76,1 x 54	150	0,451	1
26RE88X54	88,9 x 54	166	0,586	1
26RE88X76	88,9 x 76,1	163	0,653	1
26RE108X54	108,0 x 54	245	0,880	1
26RE108X76	108,0 x 76,1	203	0,978	1
26RE108X88	108,0 x 88,9	205	0,992	1

**RACOR 2 PIEZAS CON CUELLO** • JOINT CONNECTOR FEMALE X PRESS • ÉCROU TOURNANT • ÜBERGANGSMUFFE IG

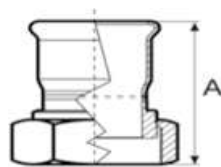

Ref.	Ø	A	Kg	U./□
27RP15X12	15 x 1/2"	47	0,070	10
27RP15X34	15 x 3/4"	54	0,081	10
27RP18X12	18 x 1/2"	50	0,095	10
27RP18X34	18 x 3/4"	56	0,102	10
27RP22X34	22 x 3/4"	56	0,112	10
27RP22X10	22 x 1"	56	0,118	10
27RP28X10	28 x 1"	62	0,122	5
27RP28X114	28 x 1 1/4"	65	0,135	5
27RP35X114	35 x 1 1/4"	71	0,150	5
26RP42X112	42 x 1 1/2"	57,5	0,278	2
26RP54X20	54 x 2"	77	0,585	2
26RP54X212	54 x 2 1/2"	77	0,954	2
26RP76X212	76,1 x 2 1/2"	114,5	1,125	1



**RACOR 2 PIEZAS CON JUNTA PLANA** • JOINT CONNECTOR FEMALE X PRESS • ÉCROU TOURNANT JOINT FLAT • ÜBERGANGSMUFFE IG - FLACHDICHTEND

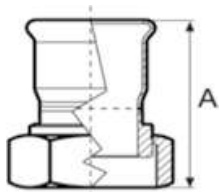

Ref.	Ø	A	Kg	U./□
27RPJP15X12	15 x 1/2"	47	0,070	10
27RPJP15X34	15 x 3/4"	54	0,081	10
27RPJP18X12	18 x 1/2"	50	0,095	10
27RPJP18X34	18 x 3/4"	56	0,102	10
27RPJP22X34	22 x 3/4"	56	0,112	10
27RPJP22X10	22 x 1"	56	0,118	10
27RPJP28X10	28 x 1"	62	0,122	5
27RPJP28X114	28 x 1 1/4"	65	0,135	5
27RPJP35X114	35 x 1 1/4"	71	0,150	5
27RPJP35X112	35 x 1 1/2"	68	0,248	5
26RPJP42X112	42 x 1 1/2"	67	0,174	2
26RPJP42X20	42 x 2"	84	0,562	2
26RPJP54X20	54 x 2"	96	0,592	2
26RPJP54X238	54 x 2 3/8"	62	0,950	2
26RPJP54X212	54 x 2 1/2"	158	0,941	2
26RPJP76X212	76,1 x 2 1/2"	138	1,125	1

**RACOR 3 PIEZAS CÓNICO** • JOINT CONNECTOR PRESS X PRESS • RACCORD CONIQUE • VERSCHRAUBUNG MIT PRESSMUFFEN

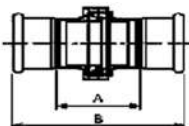

Ref.	Ø	A	B	Kg	U./□
27RTP15	15	34	82	0,100	10
27RTP18	18	38	85	0,130	10
27RTP22	22	41	103	0,180	10
27RTP28	28	49	110	0,260	5
27RTP35	35	55	124	0,420	5
26RTP42	42	55	127	0,461	2
26RTP54	54	66	146	0,759	2

**RACOR 3 PIEZAS MACHO** • JOINT CONNECTOR MALE X PRESS • RACCORD UNION FILETÉ • ÜBERGANGSVERSCHRAUBUNG AG

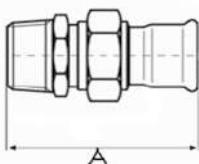

Ref.	Ø	A	Kg	U./□
27RTUM15X12	15 x 1/2"	77	0,150	10
27RTUM15X34	15 x 3/4"	80	0,168	10
27RTUM18X12	18 x 1/2"	63	0,129	10
27RTUM18X34	18 x 3/4"	66	0,149	10
27RTUM22X12	22 x 1/2"	67	0,225	10
27RTUM22X34	22 x 3/4"	69	0,195	10
27RTUM22X10	22 x 1"	73	0,237	10
27RTUM28X10	28 x 1"	78	0,366	5
27RTUM35X114	35 x 1 1/4"	85	0,495	5
26RTUM42X112	42 x 1 1/2"	90	0,578	2
26RTUM54X20	54 x 2"	103	0,988	2

**RACOR 3 PIEZAS HEMBRA** • JOINT CONNECTOR FEMALE X PRESS • RACCORD UNION TARAUDÉ • ÜBERGANGVERSCHRAUBUNG IG

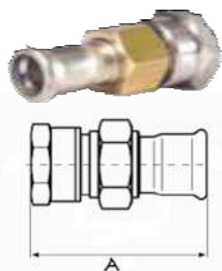

Ref.	Ø	A	Kg	U./□
27RTUH15X12	15 x 1/2"	73	0,139	10
27RTUH18X12	15 x 3/4"	76	0,180	10
27RTUH22X34	22 x 3/4"	63	0,184	10
27RTUH28X10	28 x 1"	71	0,376	5
27RTUH35X114	35 x 1 1/4"	77	0,470	5
26RTUH42X112	42 x 1 1/2"	82	0,516	2
26RTUH54X20	54 x 2"	94	0,948	2

**CODO MACHO UNA PIEZA** • ONE PIECE PART ELBOW TRANSITION MALE X PRESS • COUDE FILETÉ MONOBLOC • WINKEL 90° EINTEILIG AG

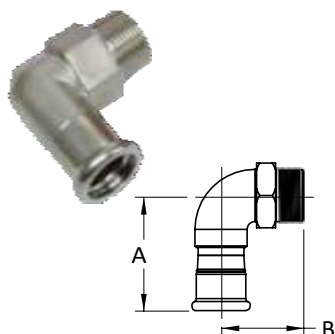

Ref.	Ø	A	B	Kg	U./□
27CM15X12	15 x 1/2"	42	37	0,065	10
27CM18X12	18 x 1/2"	44	37	0,084	10
27CM22X34	22 x 3/4"	46	46	0,080	10
27CM28X10	28 x 1"	52	46	0,270	5
27CM35X114	35 x 1 1/4"	60	54	0,370	5

**CODO MACHO SOLDADO** • WELDED ELBOW TRANSITION MALE X PRESS • COUDE FILETÉ SOUDÉ • WINKEL 90° GESCHWEIßT AG

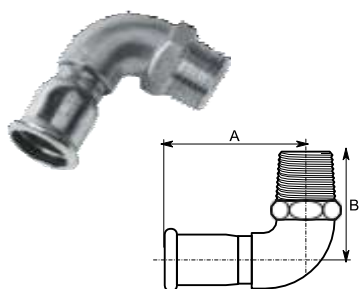

Ref.	Ø	A	B	Kg	U./□
27CMW15X12	15 x 1/2"	53	34	0,075	10
27CMW18X12	18 x 1/2"	55	36	0,081	10
27CMW22X34	22 x 3/4"	63	42,5	0,119	10
27CMW28X10	28 x 1"	73	52,5	0,184	5
27CMW35X114	35 x 1 1/4"	82	52	0,262	5
26CMW42X112	42 x 1 1/2"	136	67	0,376	2
26CMW54X20	54 x 2"	155	70	0,667	2

**CODO HEMBRA UNA PIEZA** • ONE PIECE PART ELBOW TRANSITION FEMALE X PRESS • COUDE TARAUDÉ MONOBLOC • WINKEL 90° EINTEILIG IG



Ref.	Ø	A	B	Kg	U./□
27CH15X12	15 x 1/2"	42	37	0,065	10
27CH18X12	18 x 1/2"	42	37	0,084	10
27CH22X34	22 x 3/4"	46	42	0,147	10
27CH35X114	35 x 1 1/4"	60	45	0,360	5

**CODO HEMBRA SOLDADO** • WELDED ELBOW TRANSITION FEMALE X PRESS • COUDE TARAUDÉ SOUDÉ • WINKEL 90° GESCHWEIßT IG

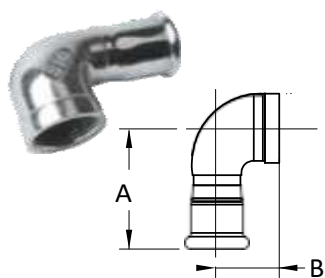

Ref.	Ø	A	B	Kg	U./□
27CHW15X12	15 x 1/2"	53	27	0,076	10
27CHW18X12	18 x 1/2"	55	27	0,084	10
27CHW22X34	22 x 3/4"	59	30,5	0,123	10
27CHW28X12	28 x 1/2"	57	27,5	0,172	5
27CHW28X10	28 x 1"	72	39	0,191	5
27CHW35X114	35 x 1 1/4"	81	46	0,267	5

**CODO PLACA UNA PIEZA** • ONE PIECE PART WALLPLATE FEMALE X PRESS • COUDE TARAUDÉ AVEC APPLIQUE MONOBLOC • DECKENWINKEL 90° EINTEILIG IG

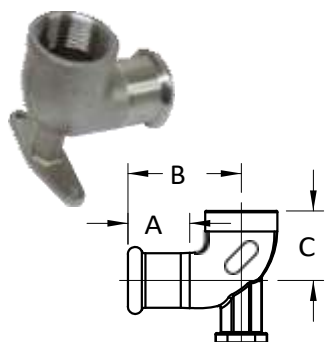

Ref.	Ø	A	B	C	Kg	U./□
27CF15X12	15 x 1/2"	24	42	27	0,065	10
27CF18X12	18 x 1/2"	24	44	27	0,112	10
27CF22X34	22 x 3/4"	26	46	33	0,147	10
27CF28X10	28 x 1"	29,5	52	39	0,218	5

**CODO PLACA SOLDADO** • WELDED WALLPLATE FEMALE X PRESS • COUDE TARAUDÉ AVEC APPLIQUE SOUDÉ • DECKENWINKEL 90° GESCHWEIßT IG

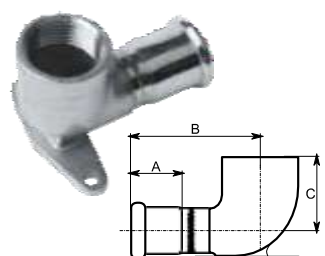

Ref.	Ø	A	B	C	Kg	U./□
27CFW15X12	15 x 1/2"	18	53	27	0,104	10
27CFW18X12	18 x 1/2"	20	57	27	0,100	10
27CFW22X34	22 x 3/4"	22	60	32	0,147	10
27CFW28X10	28 x 1"	23	72	42	0,218	5

**CURVA 2 PIEZAS** • BEND 2 PIECES • COUDE ÉCROU TOURNANT • ÜBERGANGSWINKEL 90° IG

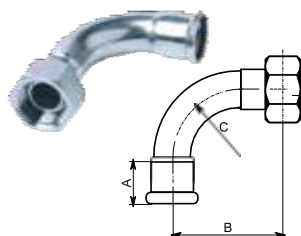

Ref.	Ø	A	B	C	Kg	U./□
27CP15X12	15 x 1/2"	16,5	45	28	0,080	10
27CP18X12	18 x 1/2"	19	51	32	0,105	10
27CP18X34	18 x 3/4"	19	54,5	32	0,125	10
27CP22X34	22 x 3/4"	22	67,5	38	0,140	10
27CP22X10	22 x 1"	22	72,5	38	0,155	10

**CURVA 2 PIEZAS JUNTA PLANA**

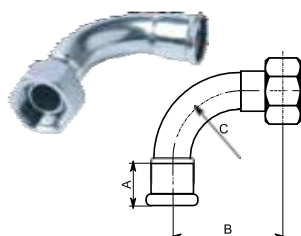

Ref.	Ø	A	B	C	Kg	U./□
27CPJP15X12	15 x 1/2"	16,5	45	28	0,080	10
27CPJP18X12	18 x 1/2"	19	51	32	0,105	10

**CURVA DE AJUSTE 15° • BEND 15° • COUDE D'AJUSTEMENT 15° • PASSBOGEN 15° AA**

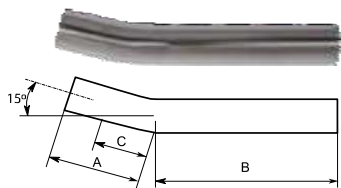

Ref.	Ø	A	B	C	Kg	U./□
26CA1528	28 x 28	67	134	48	0,193	5
26CA1535	35 x 35	78	222	53	0,372	5
26CA1542	42 x 42	121	280	59	0,575	2
26CA1554	54 x 54	140	337	67	0,837	2

**CURVA DE AJUSTE 30° • BEND 30° • COUDE D'AJUSTEMENT 30° • PASSBOGEN 30° AA**

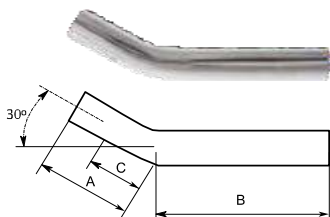

Ref.	Ø	A	B	C	Kg	U./□
26CA3028	28 x 28	70	130	54	0,195	5
26CA3035	35 x 35	86	214	60	0,372	5
26CA3042	42 x 42	135	265	69	0,576	2
26CA3054	54 x 54	136	326	79	0,845	2

**CURVA DE AJUSTE 60° • BEND 60° • COUDE D'AJUSTEMENT 60° • PASSBOGEN 60° AA**

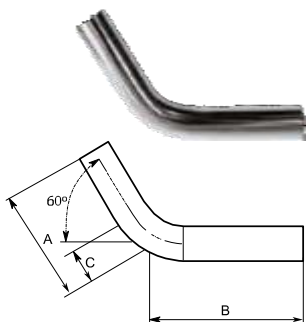

Ref.	Ø	A	B	C	Kg	U./□
26CA6028	28 x 28	80	125	66	0,195	5
26CA6035	35 x 35	105	190	77	0,371	5
26CA6042	42 x 42	150	250	90	0,600	2
26CA6054	54 x 54	165	306	107	0,888	2

**CURVA DE AJUSTE 90° • BEND 90° • COUDE D'AJUSTEMENT 90° • PASSBOGEN 90° AA**

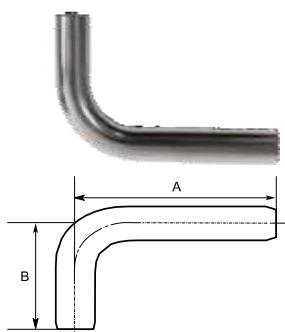

Ref.	Ø	A	B	Kg	U./□
26CA9015	15 x 15	75	122	0,059	10
26CA9018	18 x 18	74	120	0,106	10
26CA9022	22 x 22	77	120	0,134	10
26CA9028	28 x 28	102	120	0,155	5
26CA9035	35 x 35	130	200	0,364	5
26CA9042	42 x 42	185	250	0,575	2
26CA9054	54 x 54	207	300	0,846	2

**CURVA DESVIACIÓN MH • BY-PASS BEND Ø X PRESS • BAÏONETTE MF • SPRUNGBOGEN IA**

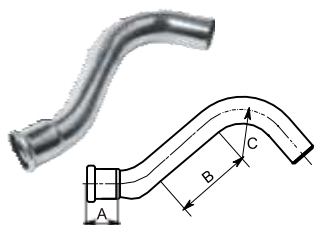

Ref.	Ø	A	B	C	Kg	U./□
27CDHM15	15	15,5	43	28	0,095	10
27CDHM18	18	18	51	32	0,128	10
27CDHM22	22	19,5	43	38	0,166	10

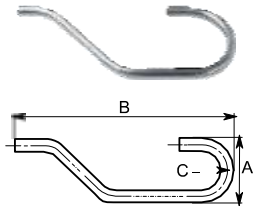
**CURVA DESVIACIÓN CISNE • COMPRESSED AIR BEND • CROSSE D'ÉVÊQUE • DRUCKLUFT-ROHRBOGEN**

Ref.	Ø	A	B	C	Kg	U./□
26CC15	15 x 15	98	306	41	0,164	5
26CC18	18 x 18	144	370	63	0,197	5
26CC22	22 x 22	170	410	73	0,210	5

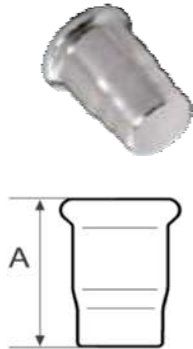
**TAPÓN • ENDCAP PRESS • BOUCHON F • VERSCHLUßKAPPE**

Ref.	Ø	A	Kg	U./□
27TA15	15	36	0,027	10
27TA18	18	39	0,033	10
27TA22	22	41	0,044	10
27TA28	28	47	0,063	5
27TA35	35	52	0,081	5
26TA42	42	55	0,119	2
26TA54	54	63	0,171	2
26TA76	76,1	97	0,427	1
26TA88	88,9	108	0,559	1
26TA108	108,0	129	0,821	1

**TUBO GALVANIZADO (INT/EXT) EN 10305-3 • GALVANIZED BOTH SIDES CS PIPE EN 10305-3 • TUBE ÉLECTROZINGUÉ INTÉRIEUR - EXTÉRIEUR EN 10305-3 • DÜNNWANDIGES C-STAHlROHR - INNEN UND AUSSEN VERZINKT NACH EN 10305-3**



Ref.	Ø x Espesor / Thickness / Épaisseur / Dicke	Largo / Length / Longueur / Länge (mm)	Peso / Weight / Poids / Gewicht (+/-) Kg/m	Presión de Trabajo / Working Pressure / Pression de Service / Arbeitsdruck (Kg/cm)	U. / □
F03001000	12 x 1,2	6.000	0,416	160	624
F03001010	15 x 1,2	6.000	0,408	147	1.488
F03001025	18 x 1,2	6.000	0,497	127	1.212
F03001030	22 x 1,2	6.000	0,616	98	1.290
F03001050	28 x 1,5	6.000	0,980	76	960
F03001070	35 x 1,5	6.000	1,239	75	762
F03001090	42 x 1,5	6.000	1,498	65	762
F03001110	54 x 1,5	6.000	1,942	50	366
F03001150	76,1 x 2,0	6.000	3,655	46	222
F03001170	88,9 x 2,0	6.000	4,286	40	198
F03001190	108,0 x 2,0	6.000	5,228	33	162

**TUBO GALVANIZADO (1 CARA EXTERIOR) EN 10305-3 • GALVANIZED OUTSIDE CS PIPE EN 10305-3 • TUBE ÉLECTROZINGUE À L'EXTERIEUR EN 10305-3 • DÜNNWANDIGES C-STAHlROHR - AUSSEN VERZINKT NACH EN 10305-3**



Ref.	Ø x Espesor / Thickness / Épaisseur / Dicke	Largo / Length / Longueur / Länge (mm)	Peso / Weight / Poids / Gewicht (+/-) Kg/m	Presión de Trabajo / Working Pressure / Pression de Service / Arbeitsdruck (Kg/cm)	U. / □
03001000	12 x 1,2	6.000	0,360	160	1.014
03001010	15 x 1,2	6.000	0,410	147	1.836
03001025	18 x 1,2	6.000	0,520	127	1.524
03001030	22 x 1,2	6.000	0,640	98	1.290
03001050	28 x 1,5	6.000	1,000	76	960
03001070	35 x 1,5	6.000	1,300	75	402
03001090	42 x 1,5	6.000	1,520	65	402
03001110	54 x 1,5	6.000	1,950	50	366
03001150	76,1 x 2,0	6.000	3,620	46	222
03001170	88,9 x 2,0	6.000	4,286	40	222
03001190	108,0 x 2,0	6.000	5,228	33	114

**CURVA 90° HH • BEND 90° PRESS X PRESS • COUDE 90° FF • BOGEN 90° II**

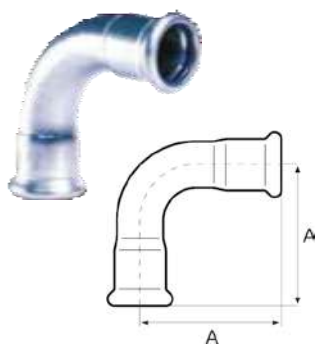

Ref.	Ø	A	Kg	U. / □
07450297	12 x 12	42	0,040	10
07450300	15 x 15	41	0,047	10
07450302	18 x 18	45	0,058	10
07450305	22 x 22	49	0,078	10
07450310	28 x 28	59	0,112	5
07450315	35 x 35	72	0,175	5
07450320	42 x 42	91	0,246	2
07450325	54 x 54	110	0,395	2
07450330	76,1 x 76,1	150	0,977	1
07450335	88,9 x 88,9	174	1,324	1
07450340	108,0 x 108,0	215	1,991	1

**CURVA 90° HM • BEND 90° Ø X PRESS • COUDE 90° FM • BOGEN 90° IA**

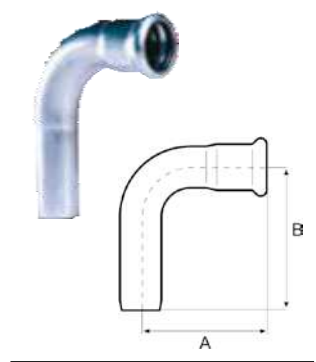

Ref.	Ø	A	B	Kg	U. / □
07450468	12 x 12	42	48	0,035	10
07450350	15 x 15	41	49	0,047	10
07450470	18 x 18	45	53	0,058	10
07450355	22 x 22	49	59	0,080	10
07450360	28 x 28	59	69	0,113	5
07450365	35 x 35	72	83	0,175	5
07450370	42 x 42	91	96	0,250	2
07450375	54 x 54	110	116	0,392	2
07450476	76,1 x 76,1	150	166	0,991	1
07450477	88,9 x 88,9	174	190	1,329	1
07450478	108,0 x 108,0	215	230	1,988	1

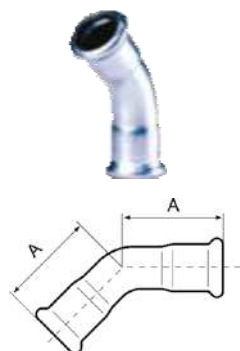
**CURVA 45° HH • BEND 45° PRESS X PRESS • COUDE 45° FF • BOGEN 45° II**

Ref.	Ø	A	Kg	U./□
07450520	12 x 12	32	0,034	10
07450525	15 x 15	30	0,039	10
07450527	18 x 18	31	0,047	10
07450530	22 x 22	35	0,063	10
07450535	28 x 28	41	0,090	5
07450540	35 x 35	56	0,150	5
07450545	42 x 42	63	0,201	2
07450550	54 x 54	75	0,304	2
07450555	76,1 x 76,1	98	0,800	1
07450560	88,9 x 88,9	113	1,034	1
07450565	108,0 x 108,0	138	1,550	1

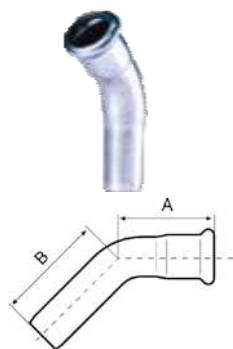
**CURVA 45° HM • BEND 45° Ø X PRESS • COUDE 45° FM • BOGEN 45° IA**

Ref.	Ø	A	B	Kg	U./□
07450570	12 x 12	32	41	0,032	10
07450575	15 x 15	30	42	0,039	10
07450577	18 x 18	31	35	0,047	10
07450580	22 x 22	35	47	0,066	10
07450585	28 x 28	41	47	0,090	5
07450590	35 x 35	36	66	0,153	5
07450595	42 x 42	63	70	0,202	2
07450600	54 x 54	75	82	0,316	2
07450605	76,1 x 76,1	98	119	0,800	1
07450610	88,9 x 88,9	113	130	1,054	1
07450615	108,0 x 108,0	138	160	1,580	1

**MANGUITO HH • STRAIGHT COUPLING PRESS X PRESS • MANCHON FF • MUFFE II**

Ref.	Ø	A	Kg	U./□
07450000	12 x 12	42	0,030	10
07450005	15 x 15	52	0,036	10
07450007	18 x 18	52	0,045	10
07450010	22 x 22	59	0,060	10
07450015	28 x 28	61	0,077	5
07450020	35 x 35	72	0,103	5
07450025	42 x 42	79	0,142	2
07450030	54 x 54	90	0,202	2
07450035	76,1 x 76,1	142	0,619	1
07450040	88,9 x 88,9	163	0,817	1
07450045	108,0 x 108,0	192	1,204	1

**MANGUITO SIN TOPE • SLEEVE COUPLING PRESS X PRESS • MANCHON COULISSANT FF • SCHIEBEMUFFE II**

Ref.	Ø	A	Kg	U./□
07450220	12 x 12	56	0,040	10
07450225	15 x 15	75	0,051	10
07450227	18 x 18	77	0,060	10
07450230	22 x 22	86	0,081	10
07450235	28 x 28	92	0,112	5
07450240	35 x 35	99	0,136	5
07450245	42 x 42	119	0,203	2
07450250	54 x 54	145	0,280	2
07450255	76,1 x 76,1	230	0,875	1
07450260	88,9 x 88,9	262	1,200	1
07450265	108,0 x 108,0	304	1,705	1

**MANGUITO COMPRESIÓN • STRAIGHT ADAPTER PRESS X COMPRESSION • ADAPTATEUR À COMPRESSION • ÜBERGANGSMUFFE MIT SCHNEIDRINGVERSCHRAUBUNG**

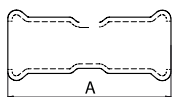

Ref.	Ø	A	Kg	U./□
07451150	15 x 15	61	0,068	10
07451155	22 x 22	65	0,099	10
07451160	28 x 28	66	0,120	5

**TE IGUAL • T-COUPLING 3 X PRESS • TÉ ÉGAL FFF • T-STÜCK**



Ref.	Ø	A	B	Kg	U./□
07450620	12 x 12 x 12	56	35	0,048	10
07450625	15 x 15 x 15	74	36	0,067	10
07450627	18 x 18 x 18	80	37	0,082	10
07450630	22 x 22 x 22	82	43	0,109	10
07450635	28 x 28 x 28	92	46	0,144	5
07450640	35 x 35 x 35	102	55	0,189	5
07450645	42 x 42 x 42	118	60	0,270	2
07450650	54 x 54 x 54	142	73	0,396	2
07450655	76,1 x 76,1 x 76,1	232	121	1,150	1
07450660	88,9 x 88,9 x 88,9	262	126	1,600	1
07450665	108,0 x 108,0 x 108,0	312	152	2,319	1

**TE ROSCADA • T-COUPLING PRESS X FEMALE X PRESS • TÉ TARAUDÉ • T-STÜCK IG**

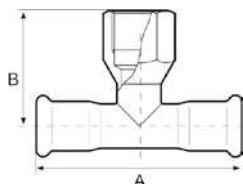

Ref.	Ø	A	B	Kg	U./□
07450800	15 x 1/2" x 15	74	38	0,082	10
07450802	18 x 1/2" x 18	80	39	0,095	10
07450806	18 x 3/4" x 18	71	35	0,105	10
07450805	22 x 1/2" x 22	82	42	0,113	10
07450824	22 x 3/4" x 22	82	43	0,120	10
07450810	28 x 1/2" x 28	92	39	0,148	5
07450826	28 x 3/4" x 28	92	45	0,159	5
07450815	35 x 1/2" x 35	102	48	0,176	5
07450827	35 x 3/4" x 35	102	48	0,191	5
07450820	42 x 1/2" x 42	118	46	0,250	2
07450828	42 x 3/4" x 42	118	51	0,255	2
07450825	54 x 1/2" x 54	142	58	0,333	2
07450829	54 x 3/4" x 54	142	59	0,350	2
07450830	76,1 x 3/4" x 76,1	232	69	0,950	1
07450835	88,9 x 3/4" x 88,9	262	76	1,240	1
07450840	108,0 x 3/4" x 108,0	312	86	1,830	1



**TE REDUCIDA • T-COUPLING REDUCTION 3 X PRESS • TÉ RÉDUIT FFF • T-STÜCK REDUZIERT**



Ref.	Ø	A	B	Kg	U./□
07450670	12 x 15 x 12	56	38	0,052	10
07450671	15 x 12 x 15	74	33	0,063	10
07450672	15 x 18 x 15	74	36	0,071	10
07450675	15 x 22 x 15	74	42	0,084	10
07450706	18 x 12 x 18	80	34	0,074	10
07450707	18 x 15 x 18	80	35	0,078	10
07450708	18 x 22 x 18	80	45	0,094	10
07450690	22 x 15 x 15	75	43	0,082	10
07450709	22 x 12 x 22	82	40	0,098	10
07450710	22 x 15 x 22	84	39	0,099	10
07450712	22 x 18 x 22	82	40	0,100	10
07450695	22 x 22 x 15	75	48	0,097	10
07450685	22 x 28 x 22	82	45	0,123	5
07450715	28 x 15 x 28	92	42	0,126	5
07450717	28 x 18 x 28	92	43	0,128	5
07450720	28 x 22 x 28	92	46	0,135	5
07450725	35 x 15 x 35	102	45	0,159	5
07450727	35 x 18 x 35	102	45	0,160	5
07450730	35 x 22 x 35	102	48	0,169	5
07450735	35 x 28 x 35	102	50	0,178	5
07450739	42 x 18 x 42	118	52	0,228	2
07450740	42 x 22 x 42	118	54	0,233	2
07450745	42 x 28 x 42	118	53	0,239	2
07450750	42 x 35 x 42	118	57	0,254	2
07450754	54 x 18 x 54	142	54	0,354	2
07450755	54 x 22 x 54	142	56	0,360	2
07450760	54 x 28 x 54	142	59	0,339	2
07450765	54 x 35 x 54	142	64	0,350	2
07450770	54 x 42 x 54	142	68	0,378	2
07450771	76,1 x 22 x 76,1	232	68	0,986	1
07450773	76,1 x 28 x 76,1	232	71	0,956	1
07450776	76,1 x 35 x 76,1	232	75	0,968	1
07450777	76,1 x 42 x 76,1	232	79	0,981	1
07450775	76,1 x 54 x 76,1	232	80	1,050	1
07450781	88,9 x 22 x 88,9	262	76	1,256	1
07450782	88,9 x 28 x 88,9	262	75,5	1,244	1
07450783	88,9 x 35 x 88,9	262	83	1,267	1
07450778	88,9 x 42 x 88,9	262	85	1,271	1
07450779	88,9 x 54 x 88,9	262	93	1,297	1
07450780	88,9 x 76,1 x 88,9	262	128	1,500	1
07450784	108,0 x 22 x 108,0	312	85	1,838	1
07450786	108,0 x 28 x 108,0	312	88	1,939	1
07450787	108,0 x 35 x 108,0	312	94	1,955	1
07450797	108,0 x 42 x 108,0	312	96	1,886	1
07450795	108,0 x 54 x 108,0	312	102	1,967	1
07450790	108,0 x 76,1 x 108,0	312	125	2,147	1
07450785	108,0 x 88,9 x 108,0	312	135	2,184	1

**BRIDA ADAPTADOR PN16 • FLANGE WITH PRESS-JOINT PN16 • BRIDE À SERTIR PN16 • FLANSCH MIT PRESSMUFFE PN16**

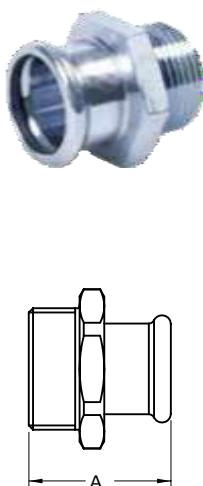

Ref.	Ø	A	B	C	Kg	U./□
07450940	22	105	63	16	0,661	2
07450941	28	115	67	16	0,814	2
07450942	35	140	72	18	1,314	2
07450934	42	150	80	18	1,523	2
07450936	54	165	98	18	1,721	1
07450937	76,1	185	125	18	3,593	1
07450938	88,9	200	145	20	4,615	1
07450939	108,0	220	120	20	5,135	1

**UNIÓN MACHO • STRAIGHT ADAPTER MALE X PRESS • RACCORD FILETÉ • ÜBERGANG AG**



Ref.	Ø	A	Kg	U./□
07450050	12 x 3/8"	36	0,038	10
07450055	15 x 3/8"	43	0,041	10
07450060	15 x 1/2"	43	0,055	10
07450070	15 x 3/4"	43	0,087	10
07450057	18 x 1/2"	44	0,065	10
07450072	18 x 3/4"	44	0,079	10
07450065	22 x 1/2"	44	0,075	10
07450075	22 x 3/4"	44	0,095	10
07450085	22 x 1"	44	0,154	10
07450080	28 x 3/4"	49	0,101	5
07450090	28 x 1"	49	0,107	5
07450095	35 x 1"	54	0,149	5
07450100	35 x 1 1/4"	54	0,169	5
07450093	35 x 1 1/2"	54	0,172	5
07450105	42 x 1 1/4"	59	0,241	2
07450110	42 x 1 1/2"	59	0,226	2
07450115	54 x 2"	69	0,368	2
07450120	76,1 x 2 1/2"	123	0,830	1
07450125	88,9 x 3"	134	1,160	1
07450130	108 x 4"	156	2,005	1

**UNIÓN HEMBRA • STRAIGHT ADAPTER FEMALE X PRESS • RACCORD TARAUDÉ • ÜBERGANG IG**

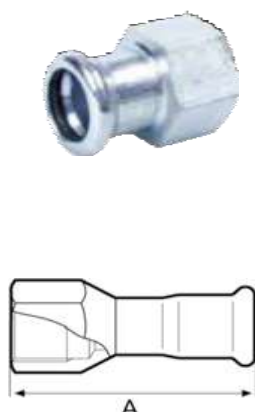

Ref.	Ø	A	Kg	U./□
07450145	12 x 1/2"	35	0,045	10
07450150	15 x 1/2"	37	0,070	10
07450151	15 x 3/4"	38	0,071	10
07450152	18 x 1/2"	37	0,057	10
07450157	18 x 3/4"	38	0,075	10
07450155	22 x 1/2"	37	0,087	10
07450160	22 x 3/4"	40	0,080	10
07450165	22 x 1"	43	0,114	10
07450168	28 x 3/4"	45	0,139	5
07450170	28 x 1"	43	0,119	5
07450172	35 x 1"	45	0,130	5
07450175	35 x 1 1/4"	73	0,300	5
07450180	42 x 1 1/2"	75	0,270	2
07450185	54 x 2"	85	0,360	2

**ADAPTADOR MACHO • STRAIGHT ADAPTER MALE X Ø • EMBOUT FILETÉ • ÜBERGANGVERSCHRAUBUNG A/AG**

Ref.	Ø	A	Kg	U./□
07450900	15 x 1/2"	57	0,070	10
07450905	15 x 3/4"	57	0,110	10
07450902	18 x 1/2"	57	0,074	10
07450907	18 x 3/4"	59	0,103	10
07450910	22 x 3/4"	59	0,015	10

**ADAPTADOR HEMBRA • STRAIGHT ADAPTER FEMALE X Ø • EMBOUT TARAUDÉ • ÜBERGANG A/IG**

Ref.	Ø	A	Kg	U./□
07450870	12 x 1/2"	58	0,060	10
07450875	15 x 1/2"	61	0,060	10
07450877	18 x 1/2"	61	0,062	10
07450882	18 x 3/4"	64	0,091	10
07450880	22 x 1/2"	61	0,065	10
07450885	22 x 3/4"	65	0,093	10

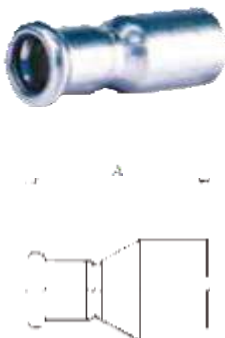
**REDUCCIÓN MH • STRAIGHT COUPLING REDUCTION Ø X PRESS • REDUCTION MF • REDUZIERMUFFE IA**

Ref.	Ø	A	Kg	U./□
07451055	15 x 12	51	0,026	10
07451060	18 x 12	53	0,032	10
07451065	18 x 15	55	0,036	10
07451070	22 x 12	60	0,039	10
07451075	22 x 15	60	0,042	10
07451077	22 x 18	57	0,044	10
07451080	28 x 15	81	0,062	5
07451082	28 x 18	84	0,068	5
07451085	28 x 22	70	0,067	5
07451090	35 x 15	84	0,084	5
07451092	35 x 18	87	0,090	5
07451095	35 x 22	76	0,095	5
07451100	35 x 28	74	0,087	5
07451104	42 x 18	98	0,180	2
07451105	42 x 22	87	0,177	2
07451110	42 x 28	100	0,128	2
07451115	42 x 35	78	0,115	2
07451119	54 x 18	108	0,190	2
07451120	54 x 22	110	0,185	2
07451125	54 x 28	100	0,185	2
07451130	54 x 35	129	0,206	2
07451135	54 x 42	108	0,189	2
07451137	76,1 x 42	151	0,425	1
07451139	76,1 x 54	145	0,454	1
07451141	88,9 x 54	157	0,591	1
07451143	88,9 x 76,1	157	0,660	1
07451144	108,0 x 54	204	0,880	1
07451145	108,0 x 76,1	196	0,948	1
07451147	108,0 x 88,9	192	0,962	1

**RACOR 2 PIEZAS CON JUNTA PLANA • JOINT CONNECTOR FEMALE X PRESS • ÉCROU TOURNANT JOINT FLAT •  
ÜBERGANGSMUFFE IG - FLACHDICHTEND A/IG**

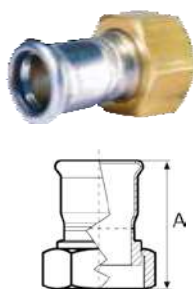

Ref.	Ø	A	Kg	U./□
07450270	15 x 3/4"	37	0,069	10
07450272	18 x 3/4"	39	0,070	10
07450275	22 x 1"	40	0,084	10
07450280	28 x 1 1/4"	44	0,156	5
07450285	35 x 1 1/2"	48	0,194	5
07450290	42 x 1 3/4"	52	0,234	2
07450295	54 x 2 3/8"	58	0,405	2

**RACOR 3 PIEZAS MACHO • STRAIGHT MALE UNION CONNECTOR • RACCORD UNION FILETÉ •  
ÜBERGANGSVERSCHRAUBUNG AG**



Ref.	Ø	A	Kg	U./□
07451750	15 x 1/2"	77	0,150	10
07451755	15 x 3/4"	80	0,168	10
07451760	18 x 1/2"	63	0,129	10
07451765	18 x 3/4"	66	0,149	10
07451770	22 x 1/2"	67	0,225	10
07451775	22 x 3/4"	69	0,195	10
07451780	22 x 1"	73	0,237	10
07451785	28 x 1"	78	0,366	5
07451790	35 x 1 1/4"	85	0,495	5
07451795	42 x 1 1/2"	90	0,578	2
07451800	54 x 2"	103	0,988	2

**RACOR 3 PIEZAS HEMBRA • STRAIGHT FEMALE UNION CONNECTOR • RACCORD UNION TARAUDÉ •  
ÜBERGANGSVERSCHRAUBUNG IG**



Ref.	Ø	A	Kg	U./□
07451700	15 x 1/2"	73	0,140	10
07451710	18 x 1/2"	59	0,120	10
07451720	22 x 3/4"	63	0,184	10
07451725	22 x 1"	67	0,214	10
07451730	28 x 1"	71	0,376	5
07451735	35 x 1 1/4"	77	0,470	5
07451740	42 x 1 1/2"	82	0,516	2
07451745	54 x 2"	94	0,948	2

**CURVA ROSCADA MACHO • THREADED BEND 90° MALE X PRESS • COUDE TARAUDÉ 90° • GEWINDEBOGEN 90° AG**

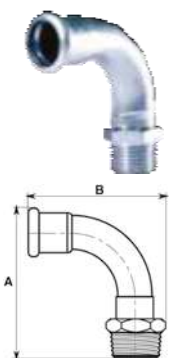

Ref.	Ø	A	B	Kg	U./□
07450395	12 x 3/8"	42	34	0,053	10
07450400	15 x 3/8"	41	39	0,062	10
07450405	15 x 1/2"	41	40	0,070	10
07450407	18 x 1/2"	45	48	0,070	10
07450410	22 x 3/4"	49	54	0,106	10
07450415	28 x 1"	59	68	0,180	5
07450420	35 x 1 1/4"	72	102	0,259	5
07450425	42 x 1 1/2"	91	116	0,375	2
07450430	54 x 2"	110	142	0,670	2

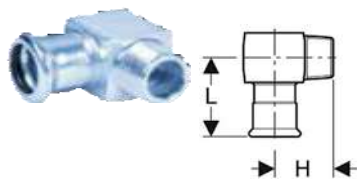
**CODO MACHO • ELBOW TRANSITION MALE X PRESS • COUDE FILETÉ • WINKEL 90° AG**

Ref.	Ø	L	H	Kg	U./□
07450850	15 x 3/8"	34	23	0,082	10
07450855	15 x 1/2"	34	28	0,095	10
07450857	18 x 1/2"	36	26	0,110	10
07450860	22 x 3/4"	39	36	0,189	10

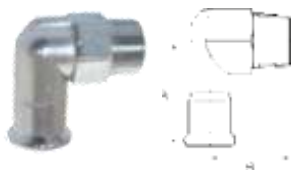
**CODO MACHO ESCUADRA • ELBOW TRANSITION MALE X PRESS • EQUERRE FILETÉ • WINKEL 90° AG**

Ref.	Ø	A	B	Kg	U./□
07450467	15 x 1/2"	42	38	0,097	10
07450469	18 x 1/2"	44	38	0,118	10
07450471	22 x 3/4"	45	47	0,162	10

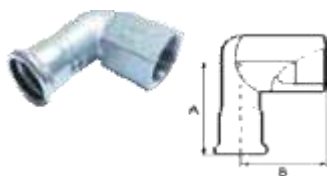
**CODO HEMBRA ESCUADRA • ELBOW TRANSITION FEMALE X PRESS • EQUERRE TARAUDÉ • WINKEL 90° IG**

Ref.	Ø	A	B	Kg	U./□
07450461	15 X 1/2"	41	40	0,094	10
07450462	18 X 1/2"	41	40	0,102	10
07450463	22 x 3/4"	46	42	0,159	10
07450464	28 x 1/2"	52	47	0,258	5
07450466	28 x 1"	52	47	0,229	5

**CURVA ROSCADA HEMBRA • THREADED BEND 90° FEMALE X PRESS • COUDE TARAUDÉ 90° • GEWINDEBOGEN 90° IG**

Ref.	Ø	A	B	Kg	U./□
07450450	15 x 1/2"	44	41	0,074	10
07450452	18 x 1/2"	51	45	0,084	10
07450455	22 x 3/4"	56	49	0,119	10
07450460	28 x 1"	65	77	0,219	5

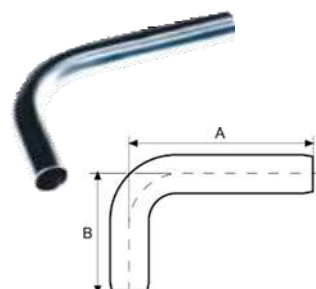
**CURVA DE AJUSTE 90° • BEND 90° Ø X Ø • COUDE D'AJUSTEMENT 90° • PASSBOGEN 90° AA**

Ref.	Ø	A	B	Kg	U./□
07450479	12 x 12	120	70	0,072	10
07450480	15 x 15	120	70	0,088	10
07450482	18 x 18	120	70	0,103	10
07450485	22 x 22	120	70	0,132	10
07450490	28 x 28	125	97	0,190	5
07450495	35 x 35	201	121	0,359	5
07450500	42 x 42	254	160	0,553	2
07450505	54 x 54	302	202	0,877	2

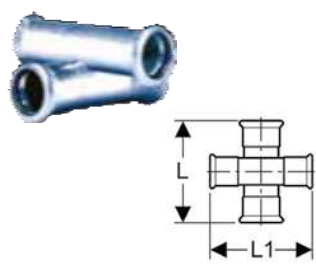
**CRUZ REDUCIDA • CROSSOVER COUPLING 4 X PRESS • CROIX FFF ET CROIX REDUITE • KREUZSTÜCK 90°**

Ref.	Ø	L	L1	Kg	U./□
07450950	15 x 15 x 15 x 15	74	74	0,100	10
07450956	18 x 15 x 18 x 15	80	74	0,110	10
07450955	22 x 15 x 22 x 15	82	74	0,130	10
07450957	22 x 18 x 22 x 18	82	80	0,140	10
07450960	28 x 18 x 28 x 18	92	80	0,148	5
07450961	42 x 28 x 42 x 28	113	116	0,286	2
07450958	76,1x28x76,1x28	232	150	1,054	1
07450959	88,9 x 28 x 88,9 x 28	263	153	1,400	1

**SALTATUBOS SIMÉTRICO • SYMMETRICAL STRAIGHT BY-PASS • CHAPEAU DE GENDARME SYMETRIQUE • SYMMETRISCHE ÜBERSPRUNGBOGEN AA**

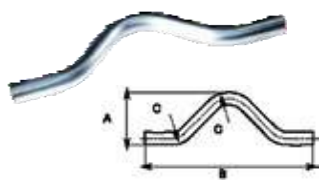

Ref.	Ø	B	Kg	U./□
07450920	12 x 12	200	0,090	10
07450925	15 x 15	202	0,110	10
07450927	18 x 18	237	0,155	10
07450930	22 x 22	233	0,159	10
07450935	28 x 28	301	0,335	5

**SALTATUBOS ASIMÉTRICO • ASYMMETRICAL STRAIGHT BY-PASS • CHAPEAU DE GENDARME ASYMETRIQUE • ASYMMETRISCHE ÜBERSPRUNGBOGEN AA**

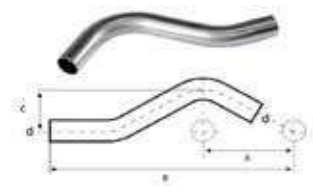

Ref.	Ø	B	Kg	U./□
07451920	12 x 12	154	0,061	10
07451900	15 x 15	145	0,081	10
07451910	18 x 18	157	0,107	10
07451930	22 x 22	175	0,145	10
07451935	28 x 28	226	0,240	5

**TAPÓN • ENDCAP PRESS • BOUCHON F • VERSCHLUßKAPPE**



Ref.	Ø	A	Kg	U./□
07450975	15	38	0,027	10
07450977	18	41	0,035	10
07450980	22	42	0,045	10
07450985	28	46	0,062	5
07450990	35	51	0,079	5
07450995	42	59	0,123	2
07451000	54	73	0,179	2
07451005	76,1	95	0,361	1
07451010	88,9	115	0,495	1
07451015	108,0	130	0,707	1

**TUBO DE TRANSICIÓN • WELD-ON PIPE • TUBE À SOUDER • ANSCHWEIßROHR**

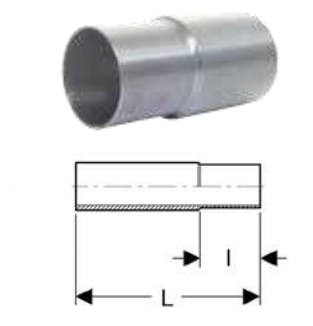

Ref.	Ø	L	I	Kg	U./□
07451025	17,2 / 15 x 1,2	120	30	0,077	10
07451027	21,3 / 18 x 1,2	120	30	0,092	10
07451030	26,9 / 22 x 1,5	120	34	0,131	10
07451035	33,7 / 28 x 1,5	120	34	0,210	5
07451040	38 x 35	120	40	0,255	5
07451045	44,5 x 42	120	45	0,307	2
07451050	57 x 54	120	50	0,375	2
07451057	80,5 x 76,1	120	70	0,500	1
07451062	94,9 x 88,9	120	75	0,659	1
07451067	114,0 x 108,0	120	90	0,880	1

**CONEXIÓN RANURADA • TRANSITION JOINT FOR GROOVED FITTINGS • RACCORD À RAINURER • ÜBERGANGSVERSCHAUBUNG FÜR GENUTETE FITTINGS**

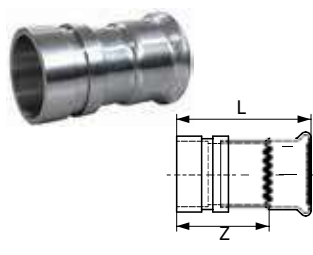

Ref.	Ø	L	Z	Kg	U./□
07451600	28 x 33,7	74	50	0,154	5
07451605	35 x 42,4	79	52	0,211	5
07451610	42 x 48,3	86	54	0,267	2
07451615	54 x 60,3	99	62	0,368	2
07451620	76,1 x 76,1	108	53	0,807	1
07451625	88,9 x 88,9	119	56	0,980	1
07451630	108,0 x 108,0	128	51	1,060	1

# Firepress

Instalpress

**MÓDULOS FIREPRESS**  
FIREPRESS MODULES  
MODULES FIREPRESS  
FIREPRESS-MODULE

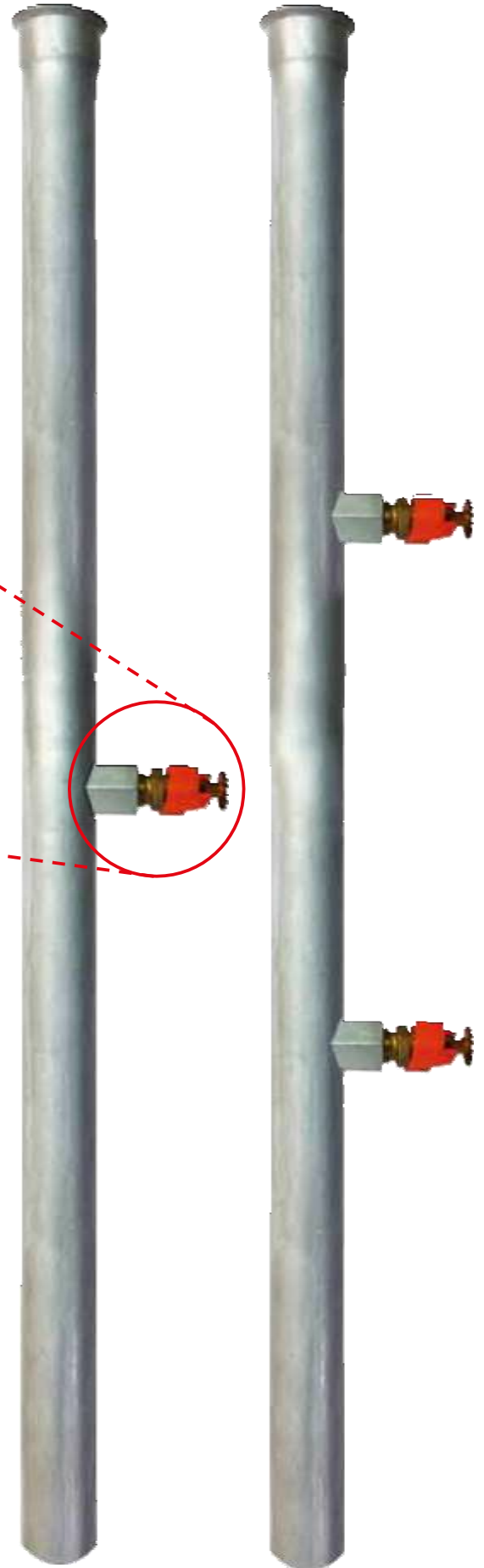

**ES** Posibilidad de componer módulos Firepress, que incluyen todos los accesorios listos para conectar al sprinkler, en función de sus necesidades.

**EN** Possibility of composing Firepress modules including all accessories ready to connect to sprinkler, depending on your needs.

**FR** Possibilité de créer un ensemble Firepress qui inclu tous les accessoires nécessaires pour la connexion au sprinkler, en fonction de vos besoins.

**DE** Nach Bedarf: kundenspezifische Firepress- Module mit schon eingebauten Sprinkler- Anschlüssen.

**CONECTOR ROCIADOR IPS** • IPS - SPRINKLER COUPLING • IPS - RACCORD POUR SPRINKLER • IPS - SPRINKLER-ANSCHLUSS

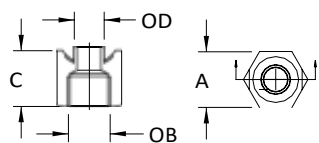

Ref.	Ø	C	OB	OD	A	Kg	U./☐
07453005	42 - 54 x 1/2"	28	28,4	18	1/2"	0,083	10
07453010	76,1 - 88,9 - 108,0 x 1/2"	28	25,9	18	1/2"	0,082	10
07453015	42 - 54 x 3/4"	38	27	24	3/4"	0,140	10
07453020	76,1 - 88,9 - 108,0 x 3/4"	38	23,5	24	3/4"	0,130	10
07453025	76,1 - 88,9 - 108,0 x 1"	44	29,5	29,5	1"	0,158	5

**CONEXIÓN MANGUITO REDUCTOR A PRENSAR IPS** • IPS - SLEEVE ADAPTER TO PRESS • IPS - ADAPTATEUR À SERTIR • IPS - REDUZIERMUFFE-ANSCHLUSS

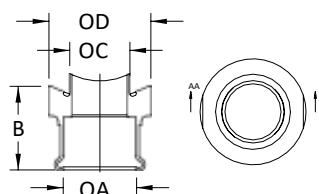

Ref.	Ø	C	OB	OD	A	Kg	U./☐
07453100	76,1 - 88,9 - 108,0 x 28	29	37	29,5	45	0,151	5
07453105	76,1 - 88,9 - 108,0 x 35	36	41	29,5	50	0,195	5

**MÁQUINAS Y CAJA FIREPRESS** • MACHINE AND BOX FIREPRESS • MACHINE ET BOÎTE FIREPRESS • PRESSMASCHINEN + BOX FIREPRESS



Ref.	ROCIADOR / SPRINKLER	Kg	U./☐
F03002100	1/2" - 3/4" - 1"	2,120	1

**CABEZAL INJERTO** • IPS - SPRINKLER PLIER • PINCE SPRINKLER • SPRINKLER PRESSBACKEN



Ref.	Ø	ROCIADOR / SPRINKLER	U./☐
F03002120	42-54-76,1-88,9-108,0	1/2"	1
F03002130	42-54-76,1-88,9-108,0	3/4"	1
F03002150	76,1-88,9-108,0	1" (28-35)	1

**POSICIONADOR** • POSITIONER • POSITIONNEUR • STELLUNGSREGLER



Ref.	ROCIADOR / SPRINKLER	U./☐
F03002500	1/2"	1
F03002510	3/4"	1



# Firepress

## Instalpress

**COMPACTA • FLEXIBLE • LIGERA**  
COMPACT • FLEXIBLE • LIGHT  
COMPACT • FLEXIBLE • LÉGER  
KOMPAKT • FLEXIBLE • LICHT

**Ref. F03002100**

**ES** Cabezal giratorio de 360°. Alta flexibilidad • Cuerpo ergonómico y carcasa de 2 componentes, con revestimientos blandos para manejo con una sola mano • Multifunción LED para el control de mantenimiento e información de carga de la batería • Aceite hidráulico biodegradable, respetuoso con el medio ambiente • Peso (incluido batería) 2,12 kg • Potencia de 60 kN • Parada automática • LED para la iluminación del lugar de trabajo • Con batería de Li-Ion 18V - 3.0 Ah de alto rendimiento, cargador rápido que permite procesos de trabajo largos y tiempos de recarga cortos (22 min). Sin efecto memoria

**EN** 360° rotating head. High flexibility • Ergonomic body and structure of 2 components, with soft finishes for a single hand operation • Multifunction LED for battery charging information and maintenance control • Hydraulic oil biodegradable, eco-friendly • Weight (including battery) = 2,12 kg • Power = 60 kN • Automatic stop • LED for illumination of the workplace • With built-in Li-ion battery 18V - 3.0 Ah of high performance quick charger that allows worker processes long and recharge times short (22'). Without memory effect

**FR** 360° tête rotative. Grande flexibilité • Corps ergonomique et la structure des 2 composants, avec une finition douce pour une opération de main unique • Multifonction LED pour information et contrôle de la maintenance de charge de batterie • Biodégradable de l'huile hydraulique, respectueux de l'environnement • Poids (batterie incluse)=2,12 kg • Puissance=60 kN • Arrêt automatique • LED pour l'éclairage des lieux de travail • Avec Li-ion intégré batterie 18V - 3,0 Ah chargeur rapide de haute performance qui permet aux travailleurs de la traite depuis longtemps et temps de recharge court (22'). Sans effet de mémoire

**DE** 360° drehen Kopfes. Hohe Flexibilität • Ergonomische Körper und Struktur von 2 Komponenten, mit weichen Oberflächen für eine Einhandbedienung • Multifunktions-LED für Informations- und Wartung des Akkus • Hydrauliköl biologisch abbaubar, umweltfreundlich • Gewicht (inkl. Akku)=2,12 kg • Macht=60 kN • Automatischer Stopp • LED für die Beleuchtung des Arbeitsplatzes • Mit eingebauter Li-Ion Akku 18V - 3,0 Ah von Hochleistungs-Schnellladegerät, mit dem Arbeitnehmer kann lange verarbeitet, und aufladen mal kurz (22'). Ohne Memory-Effekt



**JUNTA EPDM • O-RING EPDM • JOINT EPDM • DICHTUNG EPDM (SCHWARZ)**

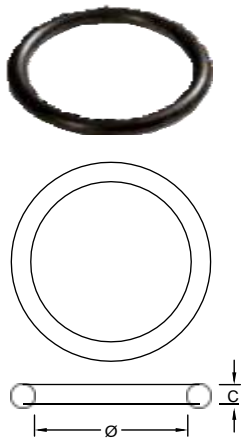

Ref.	Ø	Perfil / Profile / Profil / Profil	C	Kg	U. / □
26JN15	15	Filpress	2,15	0,001	1
06003930	15	Instalpress	2,6	0,001	1
26JN18	18	Filpress	2,0	0,001	1
06003931	18	Instalpress	2,6	0,001	1
26JN22	22	Filpress	2,0	0,001	1
06004239	22	Instalpress	3,2	0,001	1
06003933	28	Filpress / Instalpress	3,1	0,001	1
06003934	35	Filpress / Instalpress	3,1	0,001	1
06003935	42	Filpress / Instalpress	4,1	0,001	1
06003936	54	Filpress / Instalpress	4,1	0,001	1
06004208	76,1	Filpress / Instalpress	7	0,001	1
06004209	88,9	Filpress / Instalpress	8	0,001	1
06004210	108,0	Filpress / Instalpress	10	0,001	1

**JUNTA VITON VERDE • O-RING FPM (DIN ISO 1629) / FKM (ASTM D1418) • JOINT FPM (DIN ISO 1629) / FKM (ASTM D1418) • DICHTUNG FKM (GRÜN)**

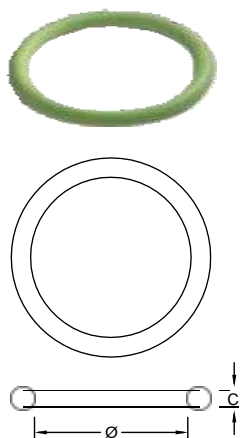

Ref.	Ø	Perfil / Profile / Profil / Profil	C	Kg	U. / □
07451245	12	Instalpress	2,4	0,001	1
26JVFKM15	15	Filpress	2,15	0,001	1
07451250	15	Instalpress	2,6	0,001	1
26JVFKM18	18	Filpress	2,0	0,001	1
07451252	18	Instalpress	2,6	0,001	1
26JVFKM22	22	Filpress	2,0	0,001	1
07451255	22	Instalpress	3,2	0,001	1
07451260	28	Filpress / Instalpress	3,1	0,001	1
07451265	35	Filpress / Instalpress	3,1	0,001	1
07451270	42	Filpress / Instalpress	4,1	0,001	1
07451275	54	Filpress / Instalpress	4,1	0,001	1
07451280	76,1	Filpress / Instalpress	7	0,001	1
07451285	88,9	Filpress / Instalpress	8	0,001	1
07451290	108,0	Filpress / Instalpress	10	0,001	1

**JUNTA VITON ROJA • O-RING FPM (DIN ISO 1629) / FKM (ASTM D1418) • JOINT FPM (DIN ISO 1629) / FKM (ASTM D1418) • DICHTUNG FKM (ROT)**

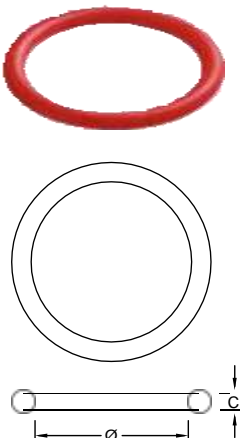

Ref.	Ø	Perfil / Profile / Profil / Profil	C	Kg	U. / □
07451300	15	Instalpress	2,6	0,001	1
07451305	18	Instalpress	2,6	0,001	1
07451310	22	Instalpress	3,2	0,001	1
07451315	28	Instalpress	3,1	0,001	1
07451320	35	Instalpress	3,1	0,001	1
07451325	42	Instalpress	4,1	0,001	1
07451330	54	Instalpress	4,1	0,001	1
07451335	76,1	Instalpress	7	0,001	1
07451340	88,9	Instalpress	8	0,001	1
07451345	108,0	Instalpress	10	0,001	1

**MÁQUINA DE PRENSAR MAP2L 19** • PRESS MACHINE MAP2L 19 • MACHINE PRESSER MAP2L 19 • PRESSMACHINEN MAP2L 19



Ref.	Ø	Mod.	Kg
26MAP2L 19	15 – 35	KLAUKE MAP2L 19	5,480



**MÁQUINAS PRENSAR ELÉCTRICA UNP2** • PRESS MACHINES UNP2 • MACHINES PRESSER UNP2 • PRESSMACHINEN UNP2



Ref.	Ø	Mod.	Kg
26MPHFK	15 - 54	KLAUKE UNP2	3,500



**ACCESORIOS** • ACCESSORIES • ACCESSOIRES • ZUBEHÖR



**CAJA METÁLICA UNP2** • METAL BOX UNP2 •  
BOÎTE MÉTALLIQUE UNP2 • METALLKOFFER UNP2

Ref.	Mod.	Kg
26MRUNP2	KLAUKE UNP2	1,500

MÁQUINA DE PRENSAR UAP3L • PRESS MACHINE UAP3L • MACHINE PRESSER UAP3L • PRESSMASCHINEN UAP3L



Ref.	Ø	Mod.	Kg
26UAP3L	15 - 54	KLAUKE UAP3L	3,50



MÁQUINA DE PRENSAR UAP4L • PRESS MACHINE UAP4L • MACHINE PRESSER UAP4L • PRESSMASCHINEN UAP4L



Ref.	Ø	Mod.	Kg
26UAP4L	15 - 108,0	KLAUKE UAP4L	4,300



ACCESORIOS • ACCESSORIES • ACCESSOIRES • ZUBEHÖR

CARGADOR BATERÍA • BATTERY CHARGER • CHARGEUR DE BATTERIE • AKKU-LADEGERÄT

Ref.	Kg
26CMPBF	1,000

BATERÍA 18V 3AH • BATTERY 18V 3AH • BATTERIE 18V 3AH • AKKU 18V 3AH



Ref.	Kg
26BMKRAL2	0,600

CAJA METÁLICA + PINZAS 42-54 + ADAPTADOR • METAL BOX + PLIERS 42-54 + ADAPTER • BOÎTE MÉTALLIQUE + PINCES 42-54 + ADAPTATEUR • METALLKOFFER + PRESSBACKEN 42-54 + ADAPTERBACKE



Ref.	Kg
26CMM42M54Z3	7,000

**GRUPO PROPULSOR AHP700LS • PRESSURE GENERATOR AHP700LS • GÉNÉRATEUR DE PRESSION AHP700LS •  
AKKUBETRIEBENES ANTRIEBSAGGREGAT AHP700LS**



Ref.	Ø	Mod.	Kg
26AHP700LS	15 - 108,0	KLAUKE AHP700LS	6,400



Cabezal de prensado no incluido • Pressing head not included •  
Non inclus pressage tête • Nicht inbegriffen presskopf

**ADAPTADOR Y CABEZAL DE PRENSADO** • ADAPTER AND PRESSING HEAD • ADAPTATEUR ET PRESSAGE TÊTE • ADAPTERBACKE UND PRESSKOPF



Ø	Máquina · Press Machine · Machine Presser · Pressmaschinen	Adaptador / Adapter / Adaptateur / Adapterbacke	Cabezal de prensado / Pressing head / Pressage tête / Presskopf
15 - 54	UAP3L	26AUAP3	26PKUAP3L
15 - 108,0	UAP4L	26AUAP3 / 26AUAP4	26PKUAP4L
76,1 - 108,0	UAP100L	Ø	26PKUAP100L

**TENAZAS PRENSADORAS FILPRESS / INSTALPRESS** • FILPRESS / INSTALPRESS PLIERS • PINCES FILPRESS / INSTALPRESS • PRESSBACKEN FILPRESS / INSTALPRESS



Ø	Instalpress	Filpress	Instalpress	Filpress	Instalpress
15	27TZ2L1915	26TZK15	27TZ15	26TZK15	27TZ15
18	27TZ2L1918	26TZK18	27TZ18	26TZK18	27TZ18
22	27TZ2L1922	26TZK22	27TZ22	26TZK22	27TZ22
28	27TZ2L1928	26TZK28	27TZ28	26TZK28	27TZ28
35	27TZ2L1935	26TZK35	27TZ35	26TZK35	27TZ35
42	<b>X</b>	26TZ42L			
54	<b>X</b>	26TZ54L			
76,1	<b>X</b>		<b>X</b>		26TZ76L
88,9	<b>X</b>		<b>X</b>		26TZ88L
108,0	<b>X</b>		<b>X</b>		26TZ108L



**MÁQUINA DE PRENSAR MAP2L19 NG** • PRESS MACHINE MAP2L19 NG • MACHINE PRESSER MAP2L19 NG • PRESSMACHINEN MAP2L19 NG



Ref.	Ø	Mod.	Kg
26MAP2L19NG	15 - 35	MAP2L19CFM	1,600



**MÁQUINA DE PRENSAR UAP3L NG** • PRESS MACHINE UAP3L NG • MACHINE PRESSER UAP3L NG • PRESSMACHINEN UAP3L NG



Ref.	Ø	Mod.	Kg
26UAP3LNG	15 - 54	UAP332CFM	3,600



**MÁQUINA DE PRENSAR UAP4L NG** • PRESS MACHINE UAP4L NG • MACHINE PRESSER UAP4L NG • PRESSMACHINEN UAP4L NG



Ref.	Ø	Mod.	Kg
26UAP4LNG	15 - 108,0	UAP432CFM	4,400



**SIMPLE** • SINGLE WOOD-SCREW • SIMPLE VIS À BOIS • EINFACH MIT SCHRAUBE

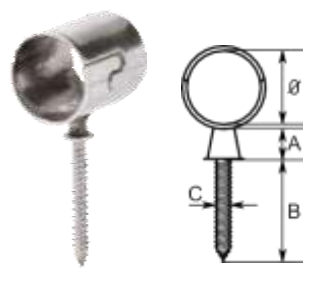

Ref.	Ø	A	B	C	Kg	U./□
40AS10	10	7	25	3,9	0,005	150
40AS12	12	7	25	3,9	0,006	150
40AS15	15	7	35	4,8	0,011	90
40AS18	18	7	35	4,8	0,014	60
40AS22	22	7	35	4,8	0,022	40
40AS28	28	7	35	4,8	0,032	20
40AS35	35	9	45	6,3	0,065	10
40AS42	42	9	45	6,3	0,088	7

**DOBLE** • DOUBLE WOOD-SCREW • DOUBLE VIS À BOIS • DOPPELT MIT SCHRAUBE



Ref.	Ø	A	B	C	Kg	U./□
40AD12	12	8	25	3,9	0,016	50
40AD15	15	8	35	4,8	0,026	30
40AD18	18	8	35	4,8	0,032	25
40AD22	22	8	35	4,8	0,050	15

**PLUS** • PLUS WOOD-SCREW • PLUS VIS À BOIS • EINFACH MIT ABSTANDHALTER

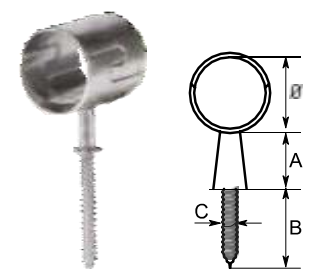

Ref.	Ø	A	B	C	Kg	U./□
40AP15	15	13	35	4,8	0,014	75
40AP18	18	13	35	4,8	0,017	50
40AP28	28	13	35	4,8	0,045	15
40AP35	35	13	45	6,3	0,073	8
40AP42	42	13	45	6,3	0,096	5

**MACHO** • METRIC MALE • MÉTRIC MÁLE • EINFACH MIT METRISCHER SCHRAUBE

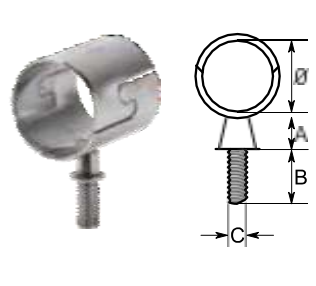

Ref.	Ø	A	B	C	Kg	U./□
40AM10	10	5	12	7	0,005	150
40AM12	12	5	12	7	0,006	150
40AM15	15	6	12	6	0,011	90
40AM18	18	6	12	6	0,014	60
40AM22	22	6	12	6	0,022	40
40AM28	28	6	12	6	0,032	20
40AM35	35	8	16	10	0,042	10
40AM42	42	8	16	10	0,086	7

**HEMBRA** • METRIC FEMALE • MÉTRIC FEMELLE • EINFACH MIT EINFACH MIT METRISCHER SCHRAUBE

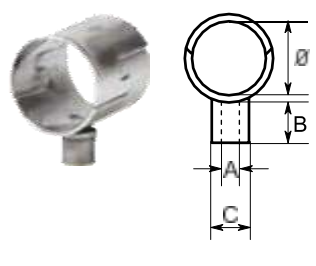

Ref.	Ø	A	B	C	Kg	U./□
40AH10	10	5	9	10	0,006	150
40AH12	12	5	9	10	0,006	150
40AH15	15	6	10	12	0,011	90
40AH18	18	6	10	12	0,015	60
40AH22	22	6	10	12	0,022	40
40AH28	28	6	10	12	0,032	20
40AH35	35	8	12	15	0,061	10
40AH42	42	8	12	15	0,082	7



**ABARCÓN AISI-304 • U-SHAPED STAPLE AISI-304 • ETRIERS EN U AISI-304 • RUNDSTAHLBÜGEL EDELSTAHL 1.4301**

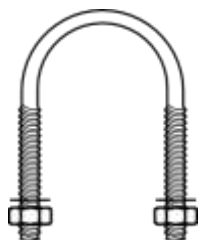

Ref.	Ø	Ø ISO	Métrica	Kg	U./□
41A3/8	18	1/4"	M6	0,023	100
41A12	22	1/2"	M6	0,026	100
41A34	28	3/4"	M6	0,029	100
41A1	34	1"	M6	0,032	100
41A38	39	39mm	M6	0,033	120
41A114	43	1 1/4"	M6	0,034	100
41A112	49	1 1/2"	M8	0,069	100
41A53	54	53mm	M8	0,074	100
41A54	55	54mm	M8	0,077	170
41A2	61	2"	M8	0,081	100
41A65	66	66mm	M8	0,084	100
41A212	77	2 1/2"	M8	0,094	100
41A84	85	85mm	M8	0,099	50
41A3	90	3"	M8	0,101	50
41A104	105	105mm	M10	0,198	50
41A4	115	4"	M10	0,211	50
41A129	130	130mm	M10	0,227	50
41A5	144	5"	M10	0,252	50
41A154	155	155mm	M10	0,284	30
41A6	170	6"	M10	0,282	25
41A204	206	206mm	M10	0,323	25

**ABRAZADERA ALIMENTARIA (AISI-304L) • HOOD CLAMPS (AISI-304L) • COLLIER ALIMENTER (AISI-304L) • COLLIER ALIMENTER (AISI-304L)**

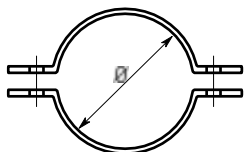

Ref.	Ø	Kg	U./□
41AA15	12	0,027	100
41AA18	18	0,036	100
41AA22	22	0,056	50
41AA28	28	0,062	50
41AA34	34	0,069	50
41AA40	40	0,073	50
41AA52	52	0,141	25
41AA63	63	0,163	25
41AA70	70	0,171	25
41AA85	85	0,221	20
41AA104	104	0,115	15
41AA129	129	0,498	8
41AA154	154	0,754	5

**ABRAZADERAS ELÉCTRICAS GRAPA DOBLE (AISI-304) • PAIR CONDUIT CLIP (AISI-304) • COLLIER ELÉCTRIQUE DOUBLE (AISI-304) • DOPPELT ELEKTRISCHE ROHRSCHELLEN EDELSTAHL 1.4301**



Ref.	Ø	Kg	U./□
41AGD15	15	0,014	100
41AGD18	18	0,015	100
41AGD22	22	0,018	100
41AGD28	28	0,020	100
41AGD35	35	0,028	50
41AGD42	42	0,032	50

**ABRAZADERAS ELÉCTRICAS GRAPA SIMPLE (AISI-304) • CONDUIT CLIP (AISI-304) •**  
**COLLIER ÉLECTRIQUE SIMPLE (AISI-304) • ELEKTRISCHE ROHRSCHELLEN MIT SCHLICHT EDELSTAHL 1.4301**



Ref.	Ø	Kg	U./□
41AGS15	15	0,007	100
41AGS18	18	0,009	100
41AGS22	22	0,010	100
41AGS28	28	0,013	100
41AGS35	35	0,016	100
41AGS42	42	0,018	50

**DOBLE ROSCA M8-M10 AISI-316 • DOUBLE NUT M8-M10 AISI-316 • COLLIERS AVEC ÉCROU M8-M10 AISI-316 •**  
**ROHRSCHELLEN MIT SCHALLDÄMMEINLAGE MUTTER M8-M10 EDELSTAHL 1.4401**

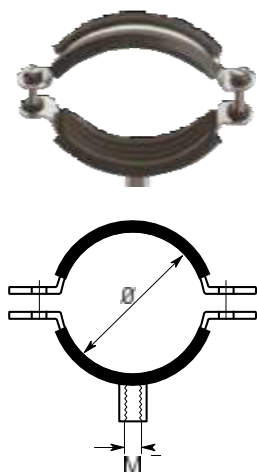

Ref.	Ø	Ø ISO	Métrica	Kg	U./□
41AIDR12	21-26	1/2"	M8	0,037	50
41AIDR34	26-31	3/4"	M8	0,079	50
41AIDR1	33-38	1"	M8	0,092	50
41AIDR114	40-45	1 1/4"	M8	0,097	25
41AIDR112	47-52	1 1/2"	M8	0,100	25
41AIDR54	52-57	54 mm.	M8	0,120	25
41AIDR2	60-65	2"	M8	0,131	25
41AIDR212	72-77	2 1/2"	M8	0,155	25
41AIDR3	87-94	3"	M8	0,176	10
41AIDR110	107-114	110 mm.	M8	0,187	25
41AIDR4	111-118	4"	M8	0,210	10
41AIDR125	121-128	125 mm.	M10	0,217	10
41AIDR5	133-140	5"	M10	0,250	10
41AIDR154	147-155	154 mm.	M10	0,291	10
41AIDR6	158-170	6"	M10	0,273	5

**SINFÍN AISI-304 • JUBILEE CLIPS AISI-304 • COLLIER DE SERRAGE AISI-304 •**  
**SCHNECKENGEWINDESCHELLEN EDELSTAHL 1.4301**



Ref.	Ø	Kg	U./□
41ASF10X16	10-16	0,012	100
41ASF16X27	16-27	0,018	50
41ASF25X40	25-40	0,020	100
41ASF32X50	32-50	0,024	50
41ASF50X70	50-70	0,027	50
41ASF70X90	70-90	0,036	25
41ASF90X110	90-110	0,039	25
41ASF110X130	110-130	0,045	25
41ASF130X150	130-150	0,048	25

**TIPO "F" AISI-316 • TYPE "F" AISI-316 • TYPE "F" AISI-316 • ROHRSCHELLEN F-AUSFÜHRUNG EDELSTAHL 1.4401**

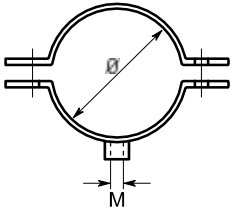

Ref.	Ø	Ø ISO	Métrica	Kg	U./□
41ATF38	16-20	3/8"	M8	0,049	50
41ATF12	21-26	1/2"	M8	0,053	50
41ATF34	26-31	3/4"	M8	0,059	50
41ATF1	33-38	1"	M8	0,065	50
41ATF114	40-45	1 1/4"	M8	0,072	50
41ATF112	47-52	1 1/2"	M8	0,077	50
41ATF54	52-57	54mm	M8	0,083	50
41ATF2	60-65	2"	M8	0,091	50
41ATF212	72-77	2 1/2"	M8-M10	0,108	50
41ATF3	87-94	3"	M8-M10	0,127	25
41ATF100	98-105	100mm	M8-M10	0,143	10
41ATF110	107-114	110mm	M8-M10	0,152	25
41ATF4	111-118	4"	M8-M10	0,155	25
41ATF125	121-128	125mm	M8-M10	0,167	25
41ATF5	133-140	5"	M8-M10	0,186	10
41ATF154	147-155	154mm	M8-M10	0,192	10
41ATF6	158-170	6"	M8-M10	0,216	25
41ATF204	198-210	204mm	M8-M10	0,272	5

**ABRAZADERA TIPO PERA (AISI-304L) • PEAR CLAMP (AISI-304L) • COLLIER TYPE POIRE (AISI-304L) • BIRNE TYP ROHRSCHELLEN (EDELSTAHL 1.4307)**



Ref.	Ø	Métrica	Kg	U./□
41ATP22	22 - 3/4"	M8	0,035	50
41ATP28	28 - 1"	M8	0,042	50
41ATP35	35 - 1 1/4"	M8	0,057	50
41ATP42	42 - 1 1/2"	M8	0,063	50
41ATP54	54 - 2"	M8	0,075	50
41ATP76	76,1 - 2 1/2"	M10	0,085	25
41ATP88	88,9 - 3"	M10	0,110	25
41ATP108	108,0 - 4"	M10	0,137	20

**ABRAZADERA TIPO PERA ISOFÓNICA (AISI-304L) • ISOPHONIC PEAR CLAMP (AISI-304L) • COLLIER ISOPHONIQUE TYPE POIRE (AISI-304L) • BIRNE TYP ROHRSCHELLEN MIT GUMMISCHTUZ (EDELSTAHL 1.4307)**

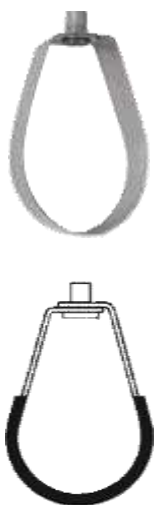

Ref.	Ø	Métrica	Kg	U./□
41ATPI22	22 - 3/4"	M8	0,041	50
41ATPI28	28 - 1"	M8	0,051	50
41ATPI35	35 - 1 1/4"	M8	0,067	50
41ATPI42	42 - 1 1/2"	M8	0,077	50
41ATPI54	54 - 2"	M8	0,088	50
41ATPI76	76,1 - 2 1/2"	M10	0,101	20
41ATPI88	88,9 - 3"	M10	0,131	25
41ATPI108	108,0 - 4"	M10	0,162	20

**ESPÁRRAGOS DOBLE ROSCA AISI-304 • STUT BOLT AISI-304 • STOCKSCHRAUBEN EDELSTAHL 1.4301**

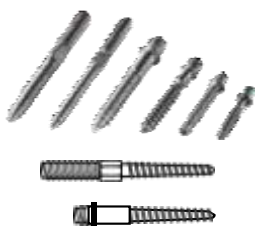

Ref.	Ø	Métrica	Kg	U./□
41EM630X10	06 x 30 x 10	M6	0,006	100
41EM850X10	08 x 50 x 10	M8	0,016	100
41EM860X30	08 x 60 x 30	M8	0,021	100
41EM1060X10	10 x 60 x 10	M10	0,027	100

**CON TUERCA AISI-316 • PIPE CLAMPS WITH PLUGS AISI-316 • COLLIERS AVEC ÉCROU AISI-316**

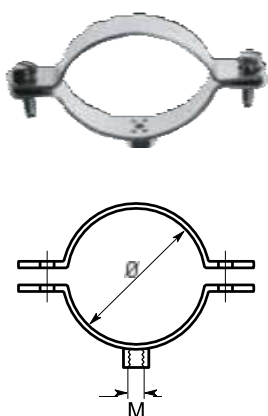

Ref.	Ø	Métrica	Kg	U./□
414ACTU12	12	M6	0,016	50
414ACTU15	15	M6	0,029	50
414ACTU18	18	M6	0,031	50
414ACTU20	20	M6	0,033	50
414ACTU22	22	M6	0,032	50
414ACTU25	25	M6	0,032	50
414ACTU28	28	M6	0,035	50
414ACTU32	32	M6	0,037	50
414ACTU35	35	M6	0,038	25
414ACTU40	40	M8	0,047	25
414ACTU50	50	M8	0,060	25
414ACTU54	54	M8	0,058	25
414ACTU63	63	M8	0,063	25
414ACTU75	75	M8	0,074	10
414ACTU90	90	M8	0,084	10
414ACTU110	110	M8	0,095	10

**SUPER AISI-316 • ADJUSTABLE CLIPS AISI-316 • COLLIERS FLEXIBLES AISI-316 • GELENKROHRSCHELLEN EDELSTAHL 1.4401**

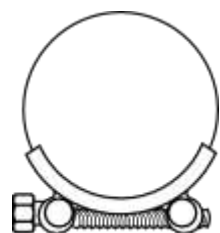

Ref.	Ø	Fleje	Métrica	Kg	U./□
42SU17X19	17-19	18 X 0,8	M5	0,030	100
42SU20X22	20-22	18 X 0,8	M5	0,032	100
42SU23X25	23-25	18 X 0,8	M5	0,031	100
42SU26X28	26-28	18 X 0,8	M5	0,034	100
42SU29X31	29-31	18 X 0,8	M5	0,035	100
42SU32X35	32-35	18 X 0,8	M5	0,037	100
42SU36X39	36-39	20 X 1,0	M6	0,075	90
42SU40X43	40-43	20 X 1,0	M6	0,081	75
42SU44X47	44-47	20 X 1,0	M6	0,082	75
42SU48X51	48-51	20 X 1,0	M6	0,083	70
42SU52X55	52-55	20 X 1,0	M6	0,085	60
42SU56X59	56-59	20 X 1,0	M6	0,091	50
42SU60X63	60-63	20 X 1,0	M6	0,093	40
42SU64X67	64-67	25 X 1,5	M8	0,160	60
42SU68X73	68-73	25 X 1,5	M8	0,168	52
42SU74X79	74-79	25 X 1,5	M8	0,173	48
42SU80X85	80-85	25 X 1,5	M8	0,180	44
42SU86X91	86-91	25 X 1,5	M8	0,185	36
42SU92X97	92-97	25 X 1,5	M8	0,184	32
42SU98X103	98-103	25 X 1,5	M8	0,190	24
42SU104X112	104-112	25 X 1,5	M8	0,199	24
42SU113X121	113-121	25 X 1,5	M8	0,207	20
42SU122X130	122-130	25 X 1,5	M8	0,221	20
42SU131X139	131-139	25 X 1,8	M8	0,233	16
42SU140X148	140-148	25 X 1,8	M8	0,238	12
42SU149X161	149-161	25 X 1,8	M8	0,286	8
42SU162X174	162-174	25 X 1,8	M8	0,304	8
42SU175X187	175-187	25 X 1,8	M8	0,324	8
42SU188X200	188-200	25 X 1,8	M8	0,341	8
42SU201X213	201-213	25 X 1,8	M8	0,368	5
42SU214X226	214-226	25 X 1,8	M8	0,388	4
42SU227X239	227-239	25 X 1,8	M8	0,290	1

**CURVA 90° HH • 90° ELBOW FF • COUDE 90° FF • BOGEN 90° II**

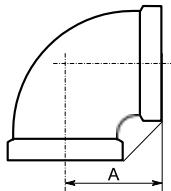

FIG. 90

Ref.	Ø	A	Kg	U./□
224F9018	1/8"	16	0,020	1
224F9014	1/4"	20	0,031	1
224F9038	3/8"	24	0,054	1
224F9012	1/2"	28	0,065	1
224F9034	3/4"	33	0,115	1
224F901	1"	38	0,175	1
224F90114	1 1/4"	45	0,265	1
224F90112	1 1/2"	49	0,320	1
224F902	2"	57	0,570	1
224F90212	2 1/2"	69	0,975	1
224F903	3"	78	1,585	1

**CODO 90° HM • ELBOW 90° FM • COUDE 90° FM • BOGEN 90° I/A**

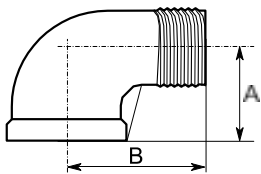

FIG. 92

Ref.	Ø	A	B	Kg	U./□
224F9218	1/8"	16	26	0,020	1
224F9214	1/4"	20	30	0,035	1
224F9238	3/8"	24	36	0,045	1
224F9212	1/2"	28	41	0,075	1
224F9234	3/4"	33	48	0,105	1
224F921	1"	38	54	0,185	1
224F92114	1 1/4"	45	62	0,295	1
224F92112	1 1/2"	49	68	0,360	1
224F922	2"	57	80	0,560	1
224F92212	2 1/2"	69	92	1,180	1
224F923	3"	78	104	1,615	1

**CODO 45° HH • ELBOW 45° FF • COUDE 45° FF • BOGEN 45° I/I**

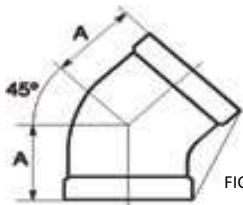

FIG. 120

Ref.	Ø	A	Kg	U./□
224F12018	1/8"	19	0,024	1
224F12014	1/4"	19	0,040	1
224F12038	3/8"	21	0,050	1
224F12012	1/2"	22	0,060	1
224F12034	3/4"	25	0,085	1
224F1201	1"	29	0,155	1
224F120114	1 1/4"	33	0,230	1
224F120112	1 1/2"	36	0,340	1
224F1202	2"	43	0,460	1
224F120212	2 1/2"	49	0,830	1
224F1203	3"	54	1,280	1

**MANGUITO HH • SOCKET (COUPLING) PLAIN • MANCHON • MUFFE**

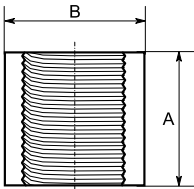

FIG. 270

Ref.	Ø	A	B	Kg	U./□
224F27018	1/8"	17	15	0,019	1
224F27014	1/4"	25	18	0,029	1
224F27038	3/8"	26	22	0,034	1
224F27012	1/2"	34	27	0,064	1
224F27034	3/4"	36	33	0,084	1
224F2701	1"	43	40	0,140	1
224F270114	1 1/4"	48	49	0,202	1
224F270112	1 1/2"	50	55	0,237	1
224F2702	2"	56	67	0,328	1
224F270212	2 1/2"	65	83	0,514	1
224F2703	3"	71	96	0,674	1

**MANGUITO REDUCIDO • SOCKET (COUPLING) BANDED REDUCING • MANCHON DE RÉDUCTION • REDUZIERMUFFE**

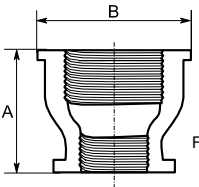

FIG. 240

Ref.	Ø	A	B	Kg	U./□
224F24014	1/4" x 1/8"	27	21	0,025	1
224F24038	3/8" x 1/4"	28	26	0,037	1
224F24012	1/2" x 3/8"	34	30	0,060	1
224F24034	3/4" x 1/2"	38	36	0,090	1
224F2401	1" x 3/4"	42	44	0,136	1
224F240114	1 1/4" x 1"	48	53	0,210	1
224F240112X12	1 1/2" x 1/2"	35	50	0,220	1
224F240112x1	1 1/2" x 1"	35	50	0,275	1
224F240112	1 1/2" x 1 1/4"	52	60	0,280	1
224F2402	2" x 1 1/2"	52	60	0,435	1
224F240212	2 1/2" x 2"	58	73	0,666	1
224F2403	3" x 2 1/2"	65	91	1,080	1

**MACHÓN • HEXAGON NIPPLE • MAMELON HEXAGONAL • SECHSKANTNIPPEL**

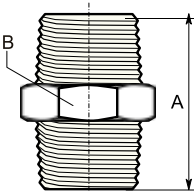

FIG. 280

Ref.	Ø	A	B	Kg	U./□
224F28018	1/8"	25	12	0,010	1
224F28014	1/4"	33	16	0,022	1
224F28038	3/8"	35	20	0,030	1
224F28012	1/2"	42	24	0,055	1
224F28034	3/4"	47	30	0,075	1
224F2801	1"	52	37	0,135	1
224F280114	1 1/4"	56	46	0,190	1
224F280112	1 1/2"	59	52	0,245	1
224F2802	2"	66	64	0,405	1
224F280212	2 1/2"	72	80	0,615	1
224F2803	3"	80	94	0,857	1
224F2804	4"	91	120	1,510	1

**MACHÓN REDUCIDO • HEXAGON NIPPLE REDUCING • RÉDUCTION MM HEXAGONAL • SECHSKANTREDUZIERSTÜCK A/A**

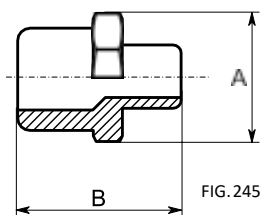

FIG. 245

Ref.	Ø	A	B	Kg	U./□
224F24514	1/4 x 1/8"	16	34	0,015	1
224F24538	3/8" x 1/4"	19	35	0,030	1
224F24512X14	1/2" x 1/4"	23	38	0,040	1
224F24512	1/2" x 3/8"	23	38	0,040	1
224F24534X38	3/4" x 3/8"	29	41	0,080	1
224F24534X12	3/4" x 1/2"	29	41	0,084	1
224F2451X12	1" x 1/2"	36	46	0,115	1
224F2451X34	1" x 3/4"	36	47	0,115	1
224F245114X12	1 1/4" x 1/2"	46	48	0,155	1
224F245114X34	1 1/4" x 3/4"	46	51	0,155	1
224F245114X1	1 1/4" x 1"	46	53	0,175	1
224F245112X34	1 1/2" x 3/4"	53	50	0,259	1
224F245112X1	1 1/2" x 1"	53	55	0,210	1
224F245112X114	1 1/2" x 1 1/4"	53	56	0,220	1
224F2452X1	2" x 1"	65	60	0,410	1
224F2452X114	2" x 1 1/4"	65	63	0,340	1
224F2452	2" x 1 1/2"	65	64	0,353	1
224F245212	2 1/2" x 2"	80	74	0,560	1
224F2453	3" x 2 1/2"	92	81	0,800	1

**TE IGUAL • TEE BANDED • TÉ FEMELLE • T-STÜCK I/I/I**

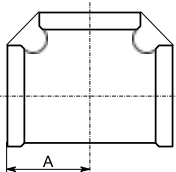

FIG. 130

Ref.	Ø	A	Kg	U./□
224F13018	1/8"	19	0,030	1
224F13014	1/4"	20	0,053	1
224F13038	3/8"	24	0,070	1
224F13012	1/2"	28	0,090	1
224F13034	3/4"	33	0,135	1
224F1301	1"	38	0,245	1
224F130114	1 1/4"	45	0,365	1
224F130112	1 1/2"	49	0,470	1
224F1302	2"	57	0,735	1
224F130212	2 1/2"	69	1,335	1
224F1303	3"	78	2,095	1
224F1304	4"	96	3,485	1

**TUERCA REDUCIDA HM • HEXAGON BUSHING FM • RÉDUCTION FM HEXAGONAL • SECHSKANTREDUZIERSTÜCK I/A**

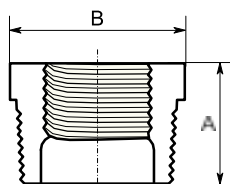

FIG. 241

Ref.	Ø	A	B	Kg	U./□
224F24114	1/4" x 1/8"	19	16	0,015	1
224F24138	3/8" x 1/4"	18	20	0,030	1
224F24112X14	1/2" x 1/4"	22	24	0,035	1
224F24112	1/2" x 3/8"	22	24	0,034	1
224F24134X38	3/4" x 3/8"	24	30	0,056	1
224F24134	3/4" x 1/2"	24	30	0,055	1
224F2411X12	1" x 1/2"	27	37	0,095	1
224F2411X34	1" x 3/4"	27	37	0,090	1
224F241114X12	1 1/4" x 1/2"	31	46	0,187	1
224F241114X34	1 1/4" x 3/4"	31	46	0,185	1
224F241114X1	1 1/4" x 1"	31	46	0,140	1
224F241112X34	1 1/2" x 3/4"	32	52	0,253	1
224F241112X1	1 1/2" x 1"	32	52	0,210	1
224F241112X114	1 1/2" x 1 1/4"	32	52	0,140	1
224F2412X1	2" x 1"	37	64	0,338	1
224F2412X114	2" x 1 1/4"	37	64	0,321	1
224F2412X112	2" x 1 1/2"	37	64	0,278	1
224F241212	2 1/2" x 2"	40	80	0,440	1
224F2413	3" x 2 1/2"	44	94	0,635	1



**ENLACE 3 PIEZAS HH • UNION CONICAL JOINT FF • RACCORD ÉTANCHÉITÉ CONIQUE FEMELLE •  
VERSCHRAUBUNG, KONISCH DICHTEND INNEN**

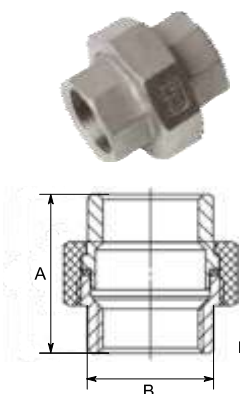

FIG. 330

Ref.	Ø	A	B	Kg	U./□
224F33018	1/8"	40	29	0,076	1
224F33014	1/4"	34	31	0,106	1
224F33038	3/8"	38	37	0,138	1
224F33012	1/2"	41	42	0,172	1
224F33034	3/4"	49	49	0,267	1
224F3301	1"	55	59	0,362	1
224F330114	1 1/4"	60	69	0,533	1
224F330112	1 1/2"	66	78	0,636	1
224F3302	2"	74	93	0,990	1
224F330212	2 1/2"	85	112	1,620	1
224F3303	3"	94	127	2,200	1
224F3304	4"	115	158	3,435	1

**ENLACE 3 PIEZAS HM • UNION CONICAL JOINT FM • RACCORD ÉTANCHÉITÉ CONIQUE FM •  
VERSCHRAUBUNG, KONISCH DICHTEND I/A**

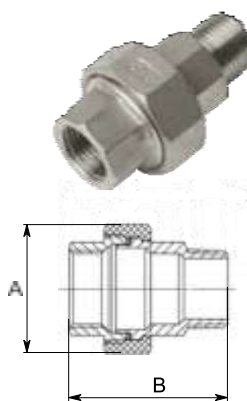

FIG. 331

Ref.	Ø	A	B	Kg	U./□
224F33118	1/8"	29	51	0,099	1
224F33114	1/4"	31	54	0,138	1
224F33138	3/8"	37	58	0,179	1
224F33112	1/2"	42	65	0,224	1
224F33134	3/4"	49	70	0,347	1
224F3311	1"	59	79	0,471	1
224F331114	1 1/4"	69	89	0,693	1
224F331112	1 1/2"	78	94	0,827	1
224F3312	2"	93	106	1,287	1
224F331212	2 1/2"	112	117	2,106	1
224F3313	3"	127	130	2,738	1
224F3314	4"	158	115	4,466	1

**TAPÓN MACHO • HEXAGON PLUG, TAPER CONICAL THREAD • BOUCHON MÂLE CONIQUE • VERSCHLUSSSCHRAUBE**

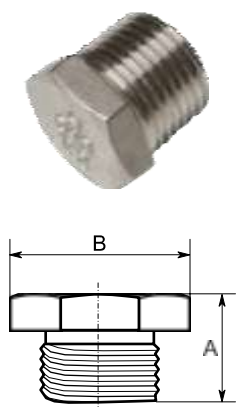
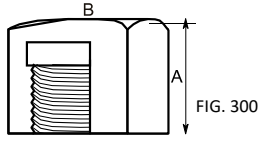

FIG. 290

Ref.	Ø	A	B	Kg	U./□
224F29018	1/8"	19	12	0,010	1
224F29014	1/4"	19	16	0,015	1
224F29038	3/8"	22	20	0,020	1
224F29012	1/2"	24	24	0,035	1
224F29034	3/4"	27	30	0,050	1
224F2901	1"	30	37	0,085	1
224F290114	1 1/4"	37	46	0,130	1
224F290112	1 1/2"	38	52	0,165	1
224F2902	2"	41	64	0,285	1
224F290212	2 1/2"	51	80	0,440	1
224F2903	3"	54	94	0,655	1

**TAPÓN HEMBRA • HEXAGON CAP • BOUCHON FEMELLE HEXAGONAL • SECHSKANTHAPPE**



Ref.	Ø	A	B	Kg	U./□
224F30018	1/8"	14	16	0,010	1
224F30014	1/4"	15	18	0,020	1
224F30038	3/8"	17	22	0,021	1
224F30012	1/2"	20	27	0,050	1
224F30034	3/4"	24	33	0,070	1
224F3001	1"	28	40	0,110	1
224F300114	1 1/4"	30	49	0,175	1
224F300112	1 1/2"	32	55	0,215	1
224F3002	2"	36	68	0,370	1
224F300212	2 1/2"	42	85	0,600	1
224F3003	3"	45	98	0,920	1

**CONTRATUERCA • BACKNUT • ÉCROU HEXAGONAL • RUNDE MUTTER**

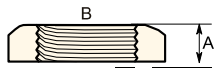

FIG. 312

Ref.	Ø	A	B	Kg	U./□
224F31218	1/8"	6	19	0,007	1
224F31214	1/4"	6	22	0,014	1
224F31238	3/8"	7	27	0,016	1
224F31212	1/2"	8	32	0,032	1
224F31234	3/4"	9	37	0,051	1
224F3121	1"	10	46	0,040	1
224F312114	1 1/4"	11	55	0,060	1
224F312112	1 1/2"	12	62	0,075	1
224F3122	2"	13	76	0,135	1

**ENTRONQUE SOLDAR • WELDING NIPPLE FROM PIPE • MAMELON É SOUDER • SCHWEISSNIPPEL**

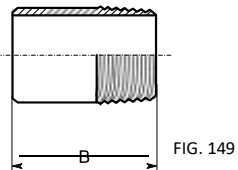

FIG. 149

Ref.	Ø	B	Kg	U./□
224F14918	1/8"	30	0,009	1
224F14914	1/4"	30	0,016	1
224F14938	3/8"	30	0,020	1
224F14912	1/2"	35	0,036	1
224F14934	3/4"	40	0,053	1
224F1491	1"	40	0,080	1
224F149114	1 1/4"	50	0,130	1
224F149112	1 1/2"	50	0,165	1
224F1492	2"	50	0,206	1
224F149212	2 1/2"	60	0,423	1
224F1493	3"	70	0,625	1
224F1494	4"	125	1,170	1

**ENTRONQUE MANGUERA • HOSE NIPPLE • ADAPTEUR MÂLE CANNELÉ HEXAGONAL • SCHLAUCHTÜLLE**

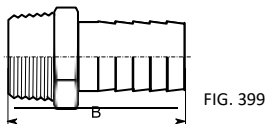
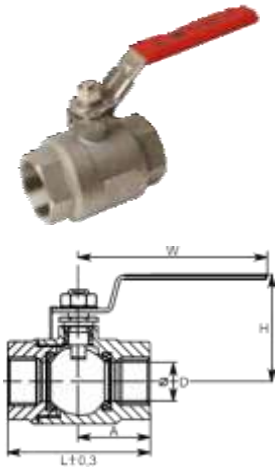

FIG. 399

Ref.	Ø	B	Kg	U./□
224F39918	1/8"	40	0,015	1
224F39914	1/4"	41	0,025	1
224F39938	3/8"	45	0,040	1
224F39912	1/2"	50	0,070	1
224F39934	3/4"	65	0,105	1
224F3991	1"	70	0,175	1
224F399114	1 1/4"	82	0,272	1
224F399112	1 1/2"	95	0,427	1
224F3992	2"	100	0,575	1
224F399212	2 1/2"	107	0,840	1

**VÁLVULA DE BOLA PASO TOTAL DOS PIEZAS, ROSCA DIN-2999 PN 64 (1000 PSI WOG) • FULL PORT BALL VALVE, 2 PC BODY SCREWED END DIN-2999 PN 64 (1000 PSI WOG) • ROBINET 2 PIÈCES FEMELLE-FEMELLE PASSAGE INTEGRAL DIN-2999 PN 64 (1000 PSI WOG) • KUGELHAHN 2-TEILING DIN-2999 PN 64 (1000 PSI WOG) INOX 316 INNENGEWINDE**



Ref.	Ø	D	L	A	H	W	Kg	U./□
60V2C14	1/4"	11,6	55	27,5	50	96	0,162	1
60V2C38	3/8"	12,7	55	27,5	50	96	0,164	1
60V2C12	1/2"	15	65	32,5	53	96	0,225	1
60V2C34	3/4"	20	77	38,5	64	125	0,343	1
60V2C1	1"	25	90	45	66	125	0,522	1
60V2C114	1 1/4"	32	102	51	79	170	0,883	1
60V2C112	1 1/2"	38	108	54	83	170	1,243	1
60V2C2	2"	50,8	125	62,5	94	190	1,920	1
60V2C212	2 1/2"	65	167	83,5	136	250	3,580	1
60V2C3	3"	77	181	90,5	149	250	5,420	1

**GRIFO JARDÍN • GARDEN BALL VALVE • ROBINET SPHÉRIQUE DE JARDIN • KUGELHAHN GARDEN E PN25**

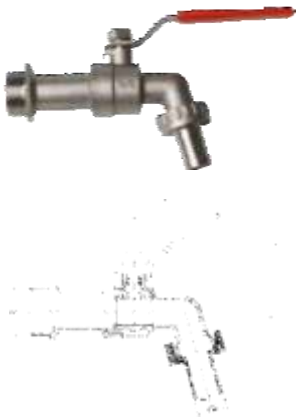

Ref.	Ø	D	L	A	H	W	Kg	U./□
63GMI12	1/2"	87	13	145	92	G 1/2"	0,220	1
63GMI34	3/4"	87	16	155	92	G 3/4"	0,280	1
63GMI1	1"	120	27,5	185	115	G 1"	0,450	1

written notice to FILINOX, S.A.

FILINOX, S.A. is not obliged to accept any return of material, except in cases of defective or faulty products, which must be notified to our Quality Department for approval. In cases of erroneous delivery, FILINOX, S.A. will not accept any returns more than 15 days after the date of delivery.

In cases where FILINOX, S.A. accepts the return and payment of material for causes other than those listed in the previous section, the return freight shall be paid by the customer.

As regards the amount of payment, FILINOX, S.A. will add the reception and handling costs, which, in no case shall be greater than 30% of the sale price of the product.

FILINOX, S.A. checks all its products before their dispatch. However, any in which a defect is observed, or which do not conform to the purchase order, will be replaced free of charge provided notice of return is received within 15 days of the delivery of such goods.

**CERTIFICATES ON RAW MATERIALS**

The quality certificates of the raw materials used will not be

delivered, unless expressly requested by the buyer, according to its specifications and at its expense.

**RESERVATION OF OWNERSHIP**

According to the laws, the transfer of ownership of the goods delivered will not be effective until the day of full payment of the total price of the goods at any time during that period, it may be partial or totally withdrawn from the address thereof.

In any case not covered by these general conditions, FILINOX, S.A. is covered by the existing legal provisions governing this type of commercial transactions.

**LIABILITY**

FILINOX, S.A. guarantees its installation systems, provided all the materials used for installation (pipes and fittings) are supplied by FILINOX, S.A.

All transactions are guaranteed by CESCE.

**[Firepress]**  
Instalpress

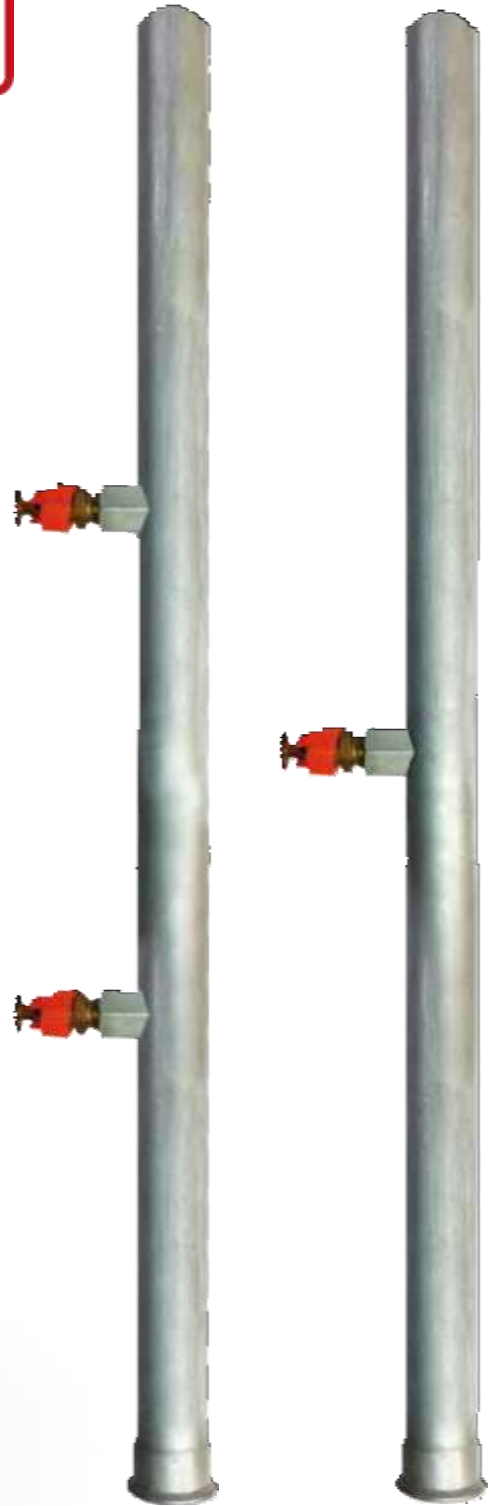

COD. 99000002 · Ed. Mar 2018

EL CONTENIDO PUEDE SUFRIR MODIFICACIONES SIN PREVIO AVISO. PUEDE MANTENERSE INFORMADO EN NUESTRA WEB. · THE CONTENT MAY CHANGE WITHOUT NOTICE. YOU CAN KEEP INFORMED ON OUR WEB SITE.  
· LE CONTENU PEUT CHANGER SANS PRÉAVIS. VOUS POUVEZ RESTER INFORMÉ SUR NOTRE SITE WEB. · DIE INHALTE KANN OHNE ANKÜNDIGUNG GEÄNDERT WERDEN. SIE KÖNNEN AUF UNSERER WEBSITE INFORMIEREN.



**filinox**

C/ Sant Adrià, 76  
08030 Barcelona  
(SPAIN)

Tel.: +34 932 232 662

Fax: +34 932 232 667

e mail: [customer@inoxidables.com](mailto:customer@inoxidables.com)

Visítenos en / Visit us in: [www.inoxidables.com](http://www.inoxidables.com)



Pol. Ind. Tambre - Faraday, 35  
15890 Santiago de Compostela  
(A CORUÑA - SPAIN)

Tel.: +34 981 586 433

Fax: +34 981 582 391

e mail: [redinox@redinox.com](mailto:redinox@redinox.com)

Visítenos en / Visit us in: [www.redinox.com](http://www.redinox.com)

