

AL-00	A	B	C	L
	21	23	9	20

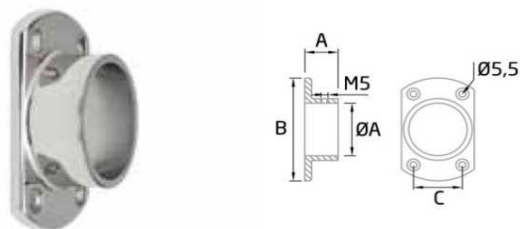

AL-01	A	B	C
	12	16	24



AV-600	ØA	A	B	C
BA4A60143P	43	35	85	34
BA4A60150P	50,8	36	96	39

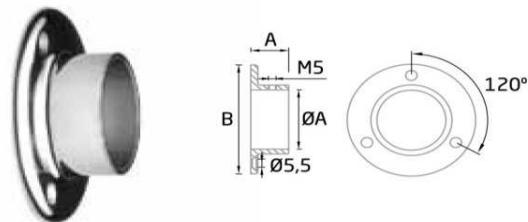

AV-601	ØA	A	B
BA4A60243P	43	25	80
BA4A60250P	50,8	31	102

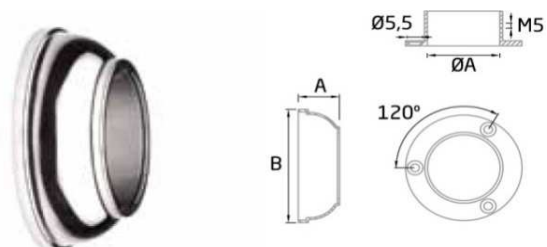

AV-602	ØA	A	B
BA4A60343P	43	26	82
BA4A60350P	50,8	29	85



AV-610	□L	A	□B	D
BA4A61640P	40x40	35	90	70

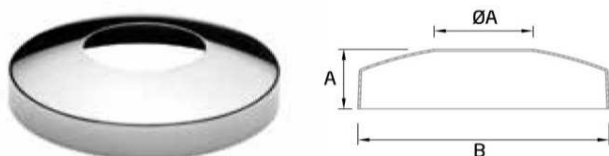

AV-650	ØA	A	B
BA4VD76320P	20	11,5	55
BA4VD76343P	43	22,5	99
BA4VD76350P	50,8	22,5	99



AV-651	ØA	A	B
BA4VD76312P	12	6	66

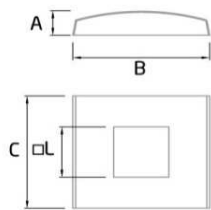

AV-660	□L	A	B	C
BA4VD787C40P	40x40	18	100	90
BA4VD787C50P	50x50	18	100	90

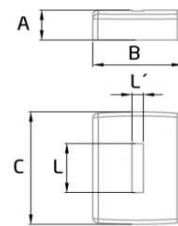

AV-670	L	L'	A	B	C
	50	10	30	84	115

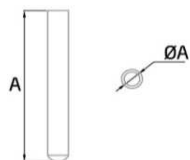

BF-00	ØA	A
	12	96

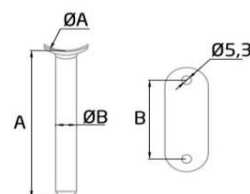

BF-R	ØA	ØB	A	B
	43	12	96	51,5
	50,8	12	96	61,5

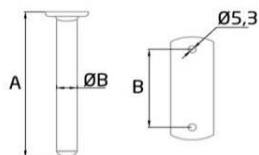

BF-FLAT	ØB	A	B
	12	96	51,5

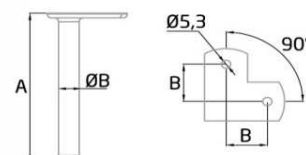

BFC-FLAT90	ØB	A	B
	12	96	24

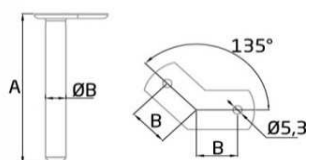

BFC-FLAT135	ØB	A	B
	12	96	24

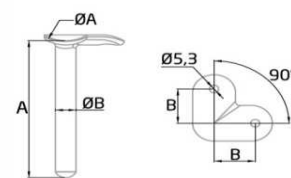

BFC-R90	ØA	ØB	A	B
	43	12	96	24
	50,8	12	96	24

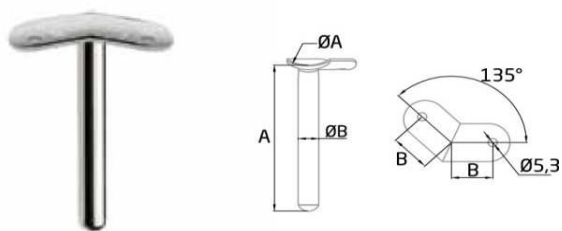

BFC-R135	ØA	ØB	A	B
	43	12	96	24
	50,8	12	96	24

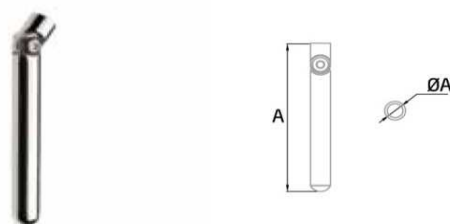

BG-00	ØA	A
	12	100,5

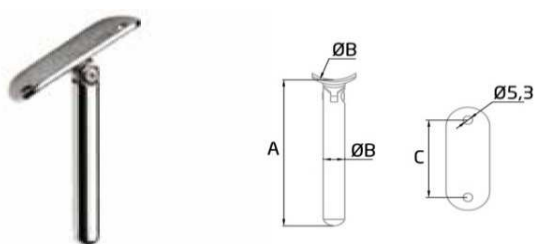

BG-R	ØA	ØB	A	B
	43	12	97	51,5
	50,8	12	97	61,5

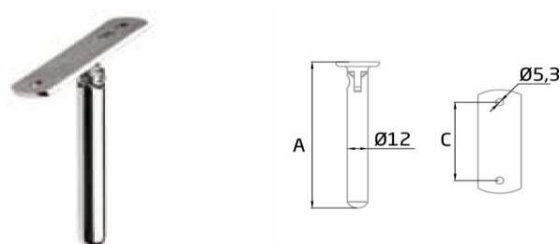

BG-FLAT	ØB	A	C
	12	96	51,5

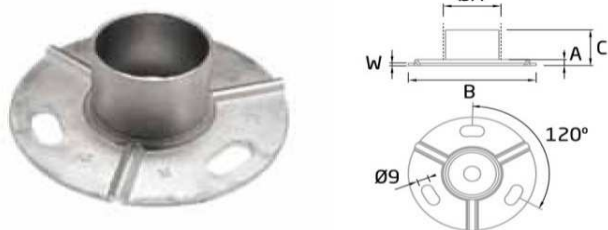

BS-00	ØA	A	B	C	W
BA4A60643P	43	5	95	35	4
BA4A60650P	50,8	5	95	35	4



BS-10	□L	A	B	C
BA4A61140P	40x40	6	88	69

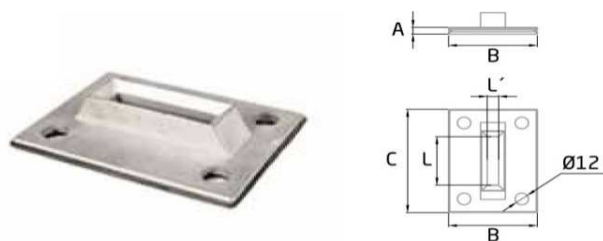

BS-20	L	L'	A	B	C
	50	10	7	80	106

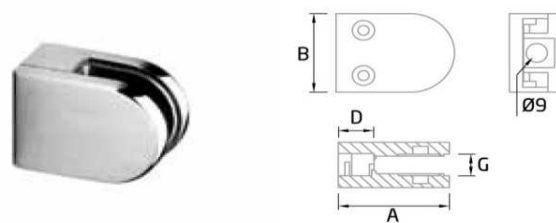

CC-700	A	B	D	G
BA4P802CUP	50	40	16	6-8
BA4P804CUP	50	40	16	8-10
BA4P806CUP	50	40	16	10-12

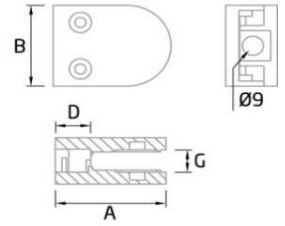
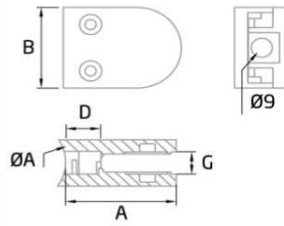

CC-701	Ø A	A	B	D	G
BA4P85243P	43	50	40	16	6-8
BA4P85250P	50,8	50	40	16	6-8
BA4P85443P	43	50	40	16	8-10
BA4P85450P	50,8	50	40	16	8-10
BA4P85643P	43	50	40	16	10-12
BA4P85650P	50,8	50	40	16	10-12

CC-702	A	B	D	G
	60	55	15,5	12-16,76

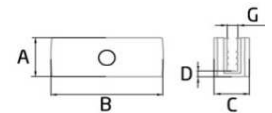
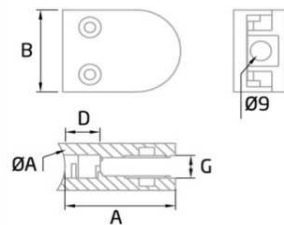

CC-703	Ø A	A	B	D	G
	43	60	55	15,5	12-16,76
	50,8	60	55	15,5	12-16,76

CC-710	A	B	C	D	G
BA4P820AP	36	92	29	5	8-10,76
	36	92	29	5	11,52-13,52

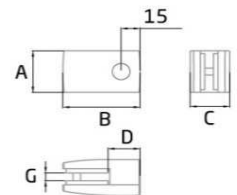
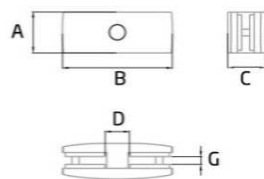

CC-711	A	B	C	D	G
BA4P821AP	36	92	31	20	8-10,76
	36	92	31	20	11,52-13,52

CC-712	A	B	C	D	G
	36	61	31	25	8-10,76
	36	61	31	25	11,52-13,52

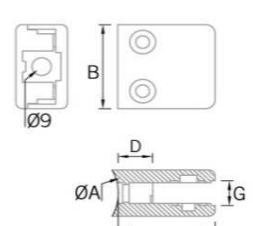
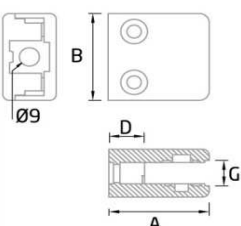

CC-720	A	B	D	G
BA4P814CUP	44	44	16	8-10

CC-721	ØA	A	B	D	G
BA4P86443P	43	44	44	16	8-10
BA4P86450P	50,8	44	44	16	8-10

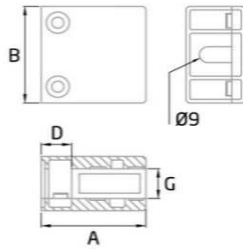

CC-724	A	B	D	G
	45	45	16	6-10,76

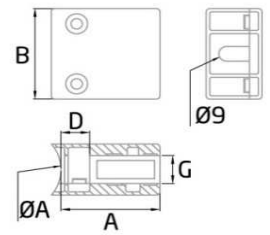

CC-725	øA	A	B	D	G
	43	45	45	16	6-10,76

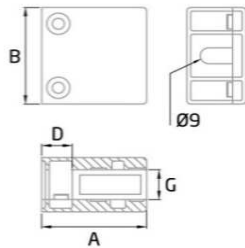

CC-726	A	B	D	G
BA4P816CUP	55	55	16	12-16,76

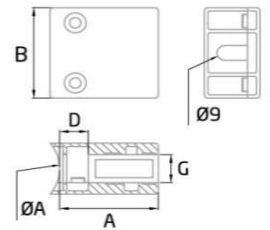

CC-727	øA	A	B	D	G
	50,8	55	55	12	12-16,76

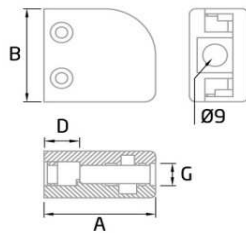

CC-750	A	B	D	G
BA4P834CUP	50	40	16	8-10

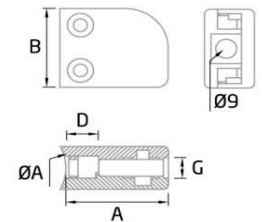

CC-751	øA	A	B	D	G
BA4P88443P	43	50	40	16	8-10
BA4P88450P	50,8	50	40	16	8-10

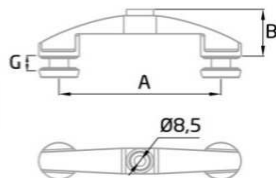

CC-759	A	B	G
	120	38	6-17,52

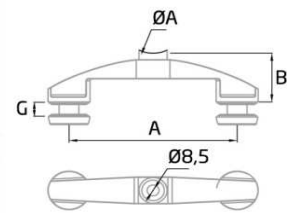

CC-760	øA	A	B	G
	43	120	38	6-17,52

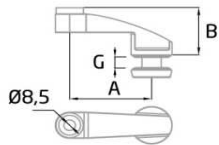

CC-761	A	B	G
	60	38	6-17,52

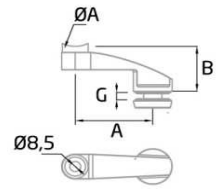

CC-762	ØA	A	B	G
	43	60	38	6-17,52

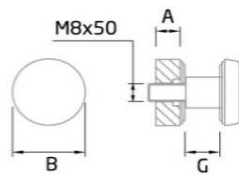

CC-768	A	B	G
	10	30	6-17,52

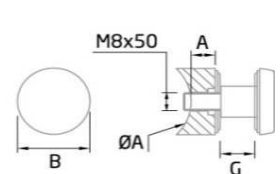

CC-769	ØA	A	B	G
	43	10	30	6-17,52

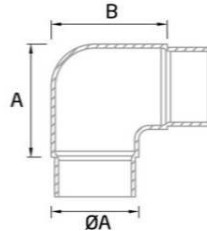

CT-200	ØA	A	B
BA4C00243P	43	55	55
BA4C00250P	50,8	60	60

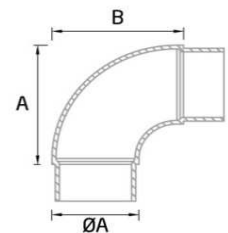

CT-201	ØA	A	B
BA4C00120P	20	30	30
BA4C00143P	43	55	55
BA4C00150P	50,8	60	60

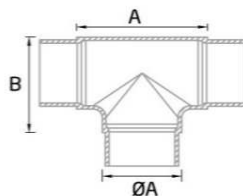

CT-202	ØA	A	B
BA4T10143P	43	71	57
BA4T10150P	50,8	69	60

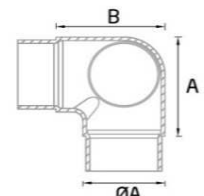

CT-205	ØA	A	B
BA4T10243P	43	55	55
BA4T10250P	50,8	60	60

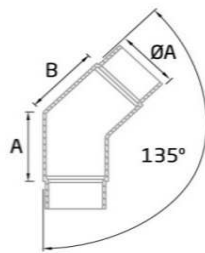

CT-206	ØA	A	B
BA4C01243P	43	50	50
BA4C01250P	50,8	50	50

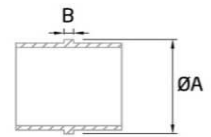

CT-207	ØA	A
BA4M30112P	12	2
BA4M30120P	20	4
BA4M30143P	43	4
BA4M30150P	50,8	4

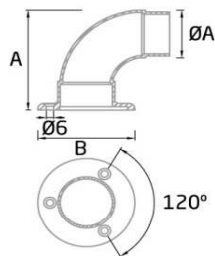

CT-208	ØA	A	B
BA4A62143P	43	90	80
BA4A62150P	50,8	95	102

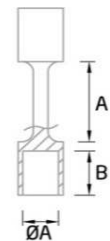

CT-209	ØA	A	B
BA4C00512P	12	30	16,5

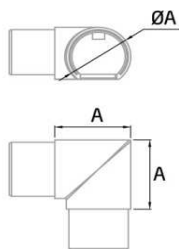

CT-211	ØA	A
	42,4	50



CT-212	ØA	A
	42,4	4

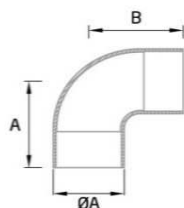

CT-215	ØA	A	B
BA4CM00145P	45	60	60

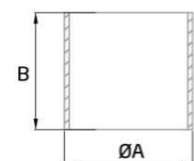

CT-216	ØA	B
	45	45

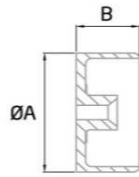

CT-217	$\varnothing A$	A
	45	20

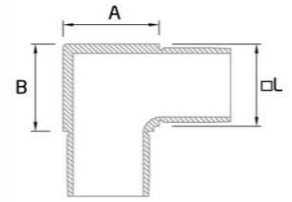

CT-220	$\square L$	A	B
BA4C00740P	40x40	43	43

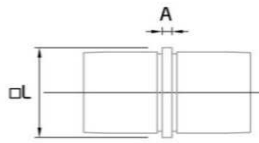

CT-221	$\square L$	A
BA4M30640P	40x40	4

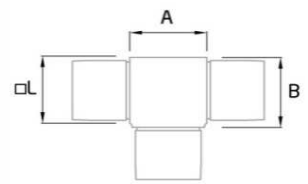

CT-222	$\square L$	A	B
BA4T10740P	40x40	43	43

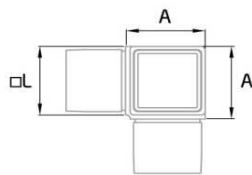

CT-225	$\square L$	A
	40x40	43

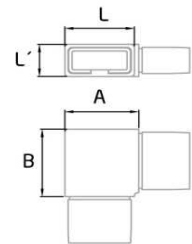

CT-230	L	L'	A	B
	40	20	43	40

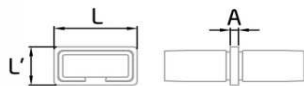

CT-232	L	L'	A
	40	20	4

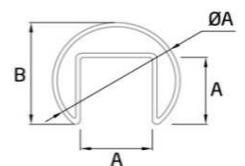

RP-1400	$\varnothing A$	A	B
	42,4	24	37

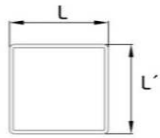

RP-1420	LG	L	L'	E
	6000	40	40	1,5
	6000	20	20	1,5
	6000	40	20	1,5
	6000	20	10	1,5

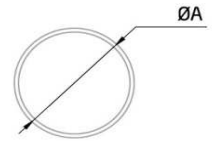

RP-1430	LG	ØA	E
	6000	12	1
	6000	20	1,5
	6000	43	1,5
	6000	50,8	1,5

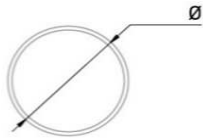

RP-1450	A	Ø
	3000	45



7 + 7 + 0 semi-flexible

RP-1460	ØC
	4
	5

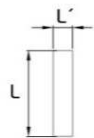

RP-1470	LG	L	L'
	6000	50	10

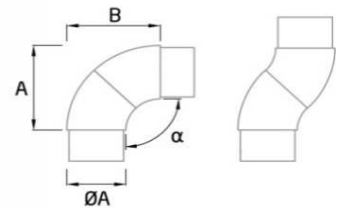

SA-402	ØA	A	B	α
BA4CR05143P	43	55	55	90-180°
BA4CR05150P	50,8	75	75	90-180°

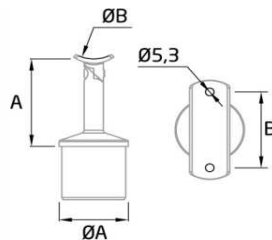

SA-404	ØA	ØB	A	B
BA4SR45143P	43	43	60	52
BA4SR45150P	50,8	50,8	65	60

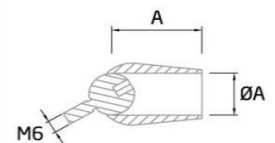

SA-405	ØA	A
	12	31
	20	42

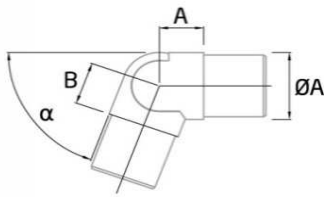

SA-406	ØA	A	B	α
BA4CR05312P	12	8	8	0-90°

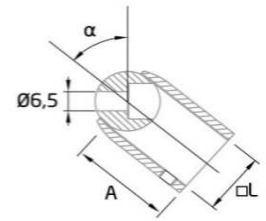

SA-407	□L	A	α
BA4S45420P	20x20	32	50°

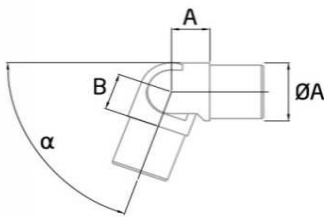

SA-409	ØA	A	B	α
BA4CR05343P	43	26	26	0-90°
BA4CR05350P	50,8	32	32	0-90°

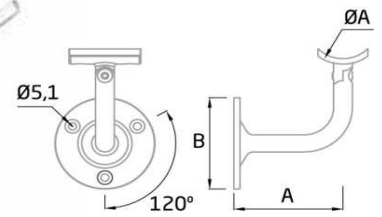

SA-410	ØA	A	B
BA4S51343P	43	70	63
BA4S51350P	50,8	70	63

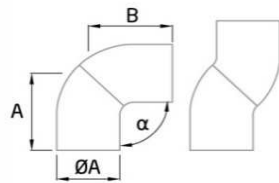

SA-412	ØA	A	B	α
	45	50	45	0-70°

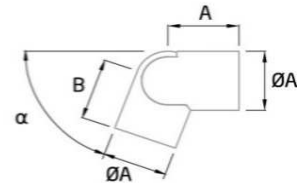

SA-413	ØA	A	B	α
	45	60	60	90-180°

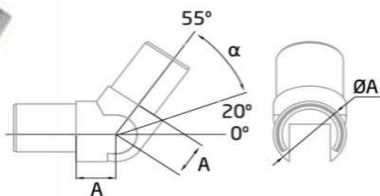

SA-416	ØA	A	α
	42,4	23	20-25°

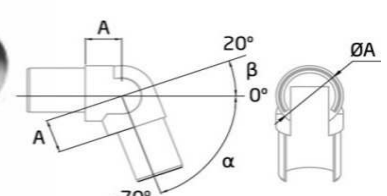

SA-417	ØA	A	α	β
	42,4	23	0-70°	0-20°

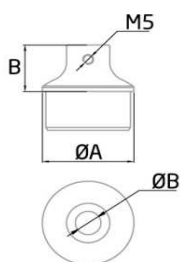

SA-420	ØA	ØB	A
	43	12	24
	50,8	12	25

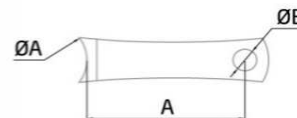

SA-421	ØA	ØB	A
BA4S56143P	43	12	80
BA4S56150P	50,8	12	80

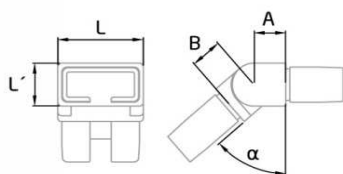

SA-432	L	L'	A	B	α
	40	20	15	15	0-90°

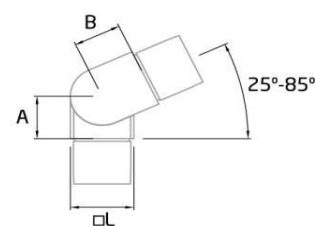

SA-433	□L	A	B
BA4CR05840P	40x40	30	30

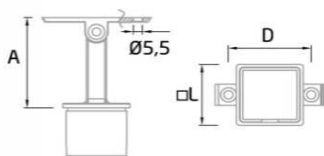

SA-434	□L	A	D
BA4SR49140P	40x40	60	50

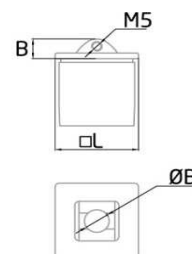

SA-440	□L	ØB	A
	40x40	12	10
	50x50	12	12

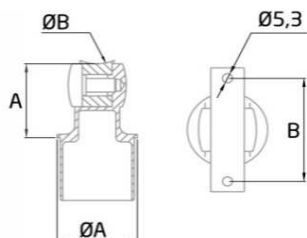

SA-449	ØA	ØB	A	B
BA4SR45243P	43	43	43	60

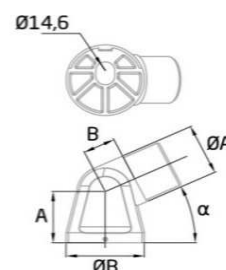

SA-451	ØA	ØB	A	B	α
BA4AR65243P	43	60	43,5	25	26-90
BA4AR65250P	50,8	60	43,5	25	26-90

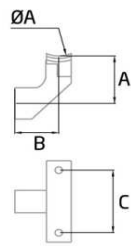

SA-470	øA	A	B	C
BA4S58043P	43	38	32	50



SA-480	øA	B
BA4BA0002P	12	65

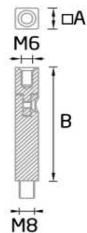

SA-481	□L	B
	12	65

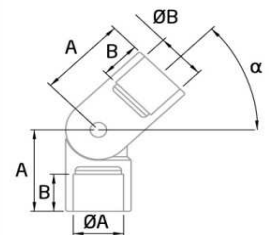

SA-486	øA	øB	A	B	α
	12	12	22	10	0-90

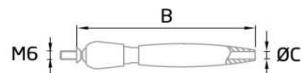

SC-800	øC	B
BA4SCC100P	4-5 mm	112

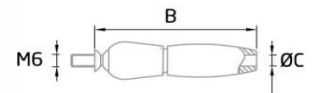

SC-801	øC	B
BA4SCC120P	4-5 mm	71



SC-850	øC	B
BA4SCC130P	4-5 mm	20

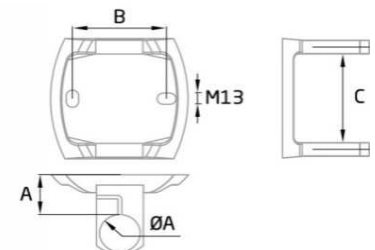

SL-1100	øA	B	C
BA4S57143P	43	100	120
BA4S57150P	50,8	100	120

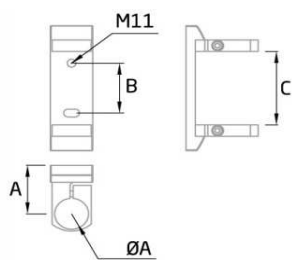

SL-1101	ØA	A	B	C	D
BA4S57343P	43	68	70	100	54
BA4S57350P	50,8	72	70	100	62

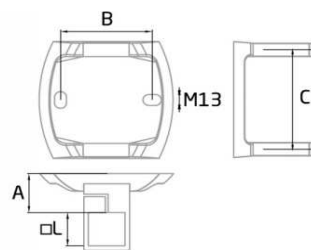

SL-1110	□L	A	B	C
BA4S57640P	40x40	46,5	100	120

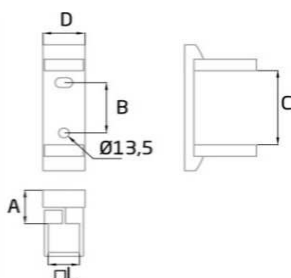

SL-1111	□L	A	B	C	D
BA4S57940P	40x40	46,5	70	103	54

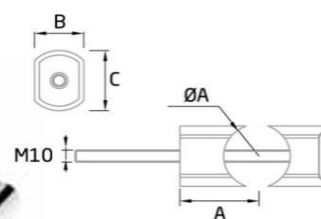

SL-1120	ØA	A	B	C
BA4S57443P	43	53	30	40
BA4S57450P	50,8	57	30	40

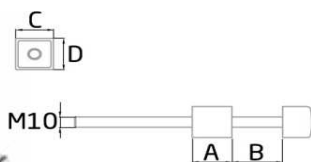

SL-1130	A	B	C	D
BA4S57840P	31,5	40	30	30

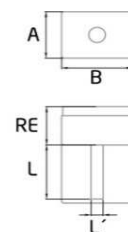

SL-1140	L	L'	A	B	RE
BA4S57050P	50	10	42	60	28-33

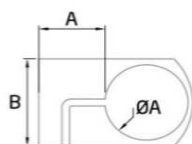

SL-1180	ØA	A	B
BA4S57243P	43	34,5	50

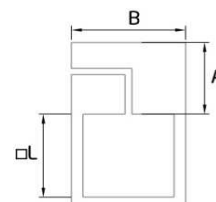

SL-1181	□L	A	B
BA4S57740P	40x40	34,5	50

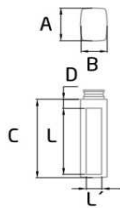

SP-00	L	L'	A	B	C	D
	50	10	25	18	60	7

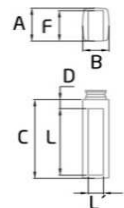

SP-01	L	L'	A	B	C	D
BA4S581P	50	10	25	18	60	7

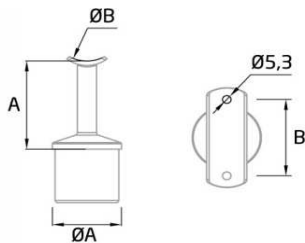

ST-302	ØA	ØB	A	B
BA4S40143P	43	43	60	52
BA4S40150P	50,8	50,8	65	60

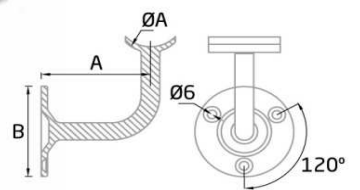

ST-303	ØA	A	B
BA4S50143P	43	70	63
BA4S50150P	50,8	70	63

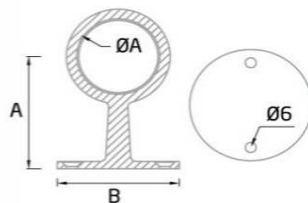

ST-304	ØA	A	B
BA4S51143P	43	68	67
BA4S51150P	50,8	78	80

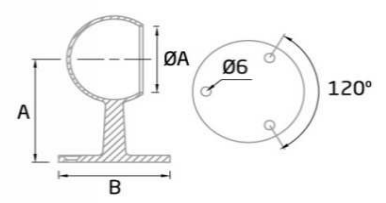

ST-305	ØA	A	B
BA4S51243P	43	68	67
BA4S51250P	50,8	78	80

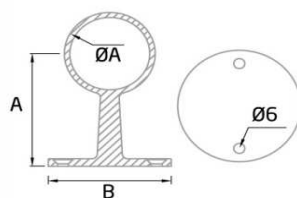

ST-306	ØA	A	B
BA4S52143P	43	72	69
BA4S52150P	50,8	83	63

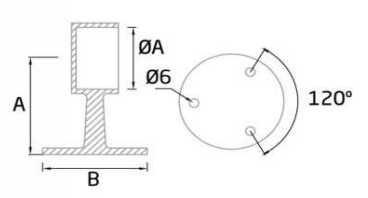

ST-307	ØA	A	B
BA4S52243P	43	72	69
BA4S52250P	50,8	83	63

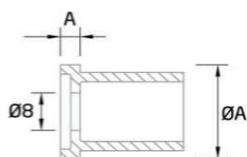

ST-308	ØA	A	
BA4S422CU20P	20	4	
BA4S422CU43P	43	4	
BA4S422CU50P	50,8	4	

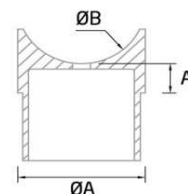

ST-309	ØA	A	A
BA4S50243AP	20	43	4
BA4S40250AP	20	50,8	4
BA4S40243P	43	43	12
BA4S40250P	50,8	50,8	9

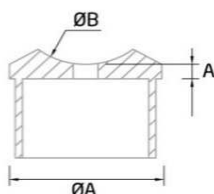

ST-310	ØA	ØB	A
	43	43	5
	50,8	50,8	5

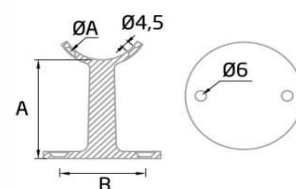

ST-311	ØA	A	B
BA4S50243P	43	57	62,5
BA4S50250P	50,8	57	62,5

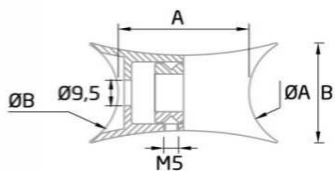

ST-312	ØA	ØB	A	B
	43	43	44	37
	50,8	50,8	44	37

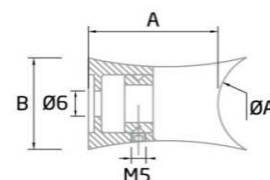

ST-313	ØA	A	B
BA4S56240P	40	44	34

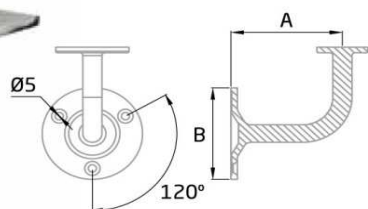

ST-316	A	B
BA4S503P	70	63

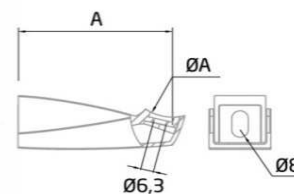

ST-317	ØA	A
BA4S53643P	43	75
BA4S53650P	50,8	75

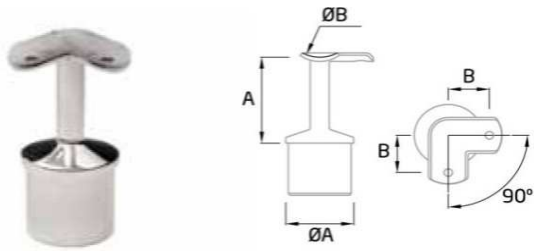

ST-319	øA	øB	A	B
BA4S41943P	43	43	60	24
BA4S41950P	50,8	50,8	65	30

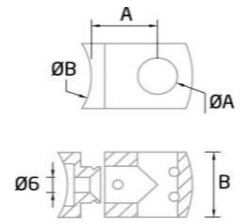

ST-320	øA	øB	A	B
BA4S41143AP	12	43	20	21
BA4S41150AP	12	50,8	20	21
BA4S41143BP	20	43	25	30
BA4S41150BP	20	50,8	25	30

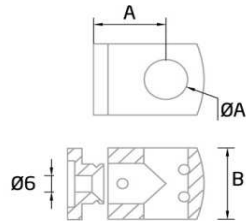

ST-321	øA	A	B
BA4S412AP	12	20	21
BA4S412BP	20	25	30

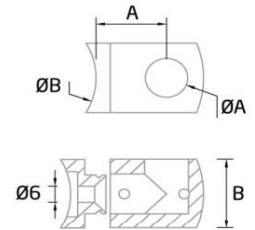

ST-322	øA	øB	A	B
BA4S41343AP	12	43	20	21
BA4S41343BP	20	43	25	30

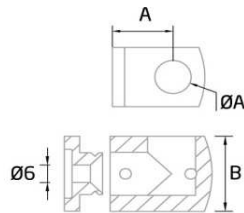

ST-323	øA	A	B
BA4S414AP	12	20	21
BA4S414BP	20	25	30

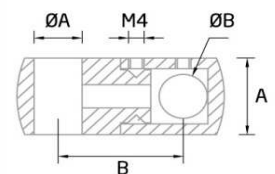

ST-324	øA	øB	A	B
BA4S42112P	12	12	21	25

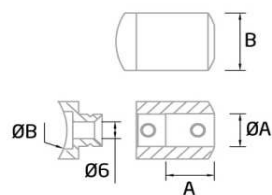

ST-325	øA	øB	A	B
	12	43	16	21

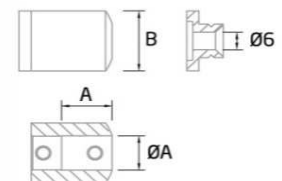

ST-326	øA	A	B
BA4S418CU12P	12	16	21

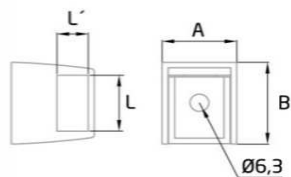

ST-328	L	L'	A	B
	20	10	25	28

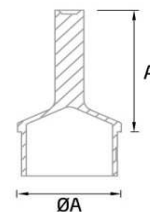

ST-330	ØA	A
BA4S40443P	43	55
BA4S40450P	50,8	55

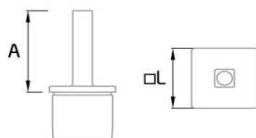

ST-331	□L	A
BA4S46440P	40x40	55

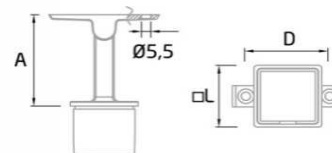

ST-332	□L	A	D
BA4S46140P	40x40	60	50

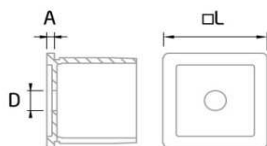

ST-333	□L	A	D
BA4S426CU40P	40x40	3	8,5

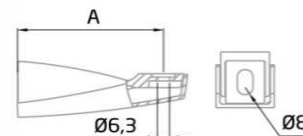

ST-334	A
	75

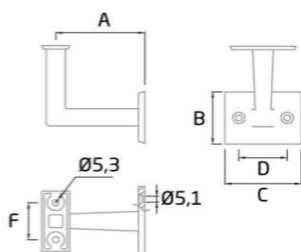

ST-335	A	B	C	D	F
BA4S537P	70	45	60	38	32

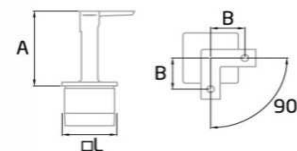

ST-339	□L	A	B
BA4S47940P	40x40	60	25

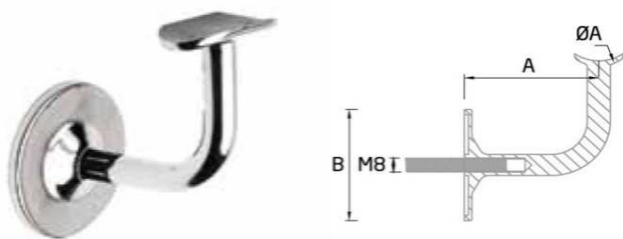

ST-340	øA	A	B	D
BA4S50443P	43	70	63	16
BA4S50450P	50,8	70	63	16

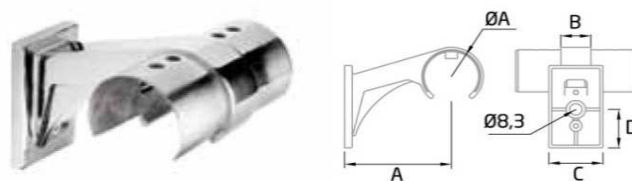

ST-345	øA	A	B	C	D
	42,4	71	20	36	28

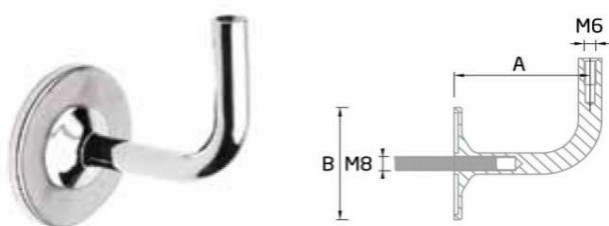

ST-350	A	B
BA4S505P	70	63

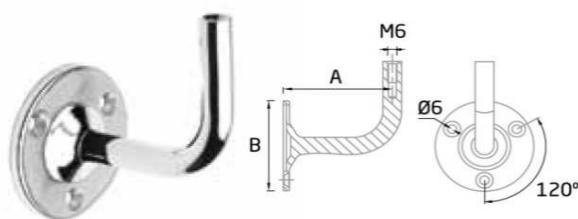

ST-351	A	B
BA4S506P	70	63

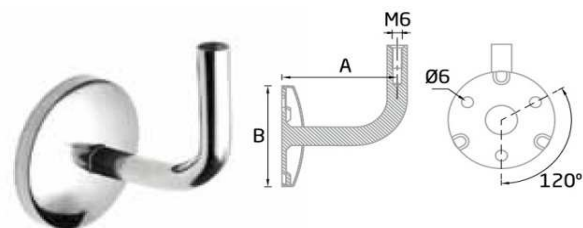

ST-352	A	B
BA4S507P	69	66

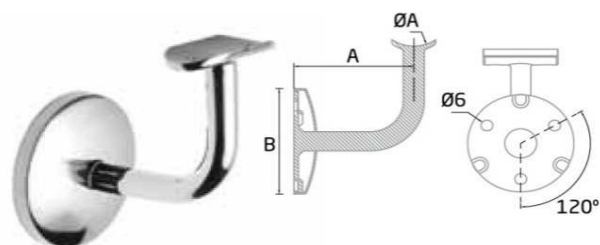

ST-353	øA	A	B
BA4S50843P	43	69	66
BA4S50850P	50,8	69	66



ST-370	øA	øB	A	α
	12	43	28	90

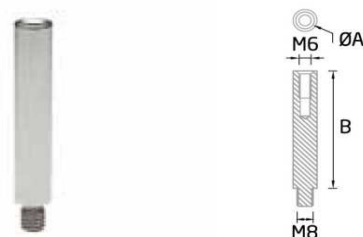

ST-380	øA	B
BA4BA0001P	12	65

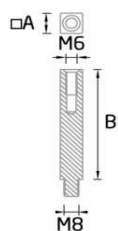

ST-381	□L	B
BA4BA0006P	12	65

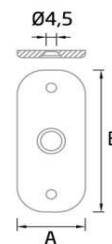

ST-390	A	B
BA4PA102CUP	30	68,5

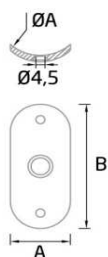

ST-391	ØA	A	B
BA4PA10143P	43	30	68,5
BA4PA10150P	50,8	30	78,5

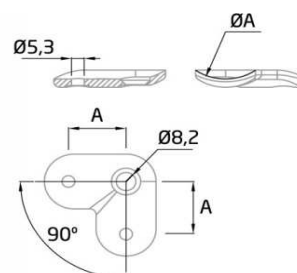

ST-392	ØA	A
BA4PA10343P	43	24
BA4PA10350P	50,8	24

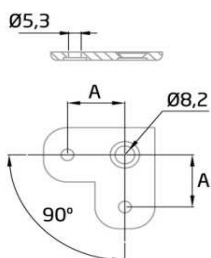

ST-393	A
	24

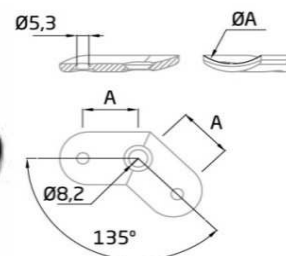

ST-394	ØA	A
	43	24
	50,8	24

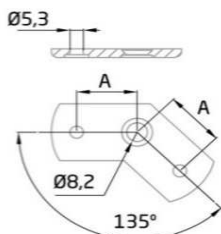

ST-395	A
	24

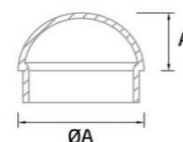

TF-501	ØA	A
BA4TD70243P	43	21,5
BA4TD70250P	50,8	25

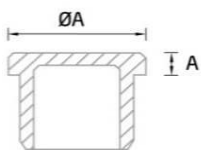

TF-502	$\varnothing A$	A
BA4TD70312P	12	2
BA4TD70315P	15	2
BA4TD70318P	18	2
BA4TD70320P	20	2
BA4TD70325P	25	2
BA4TD70330P	30	2
BA4TD70333P	33	2
BA4TD70340P	40	2
BA4TD70343P	43	2
BA4TD70350P	50,8	2
BA4TD70363P	63,5	2

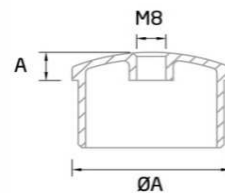

TF-503	$\varnothing A$	A
BA4TD70443P	43	8,4
BA4TD70450P	50,8	8,4

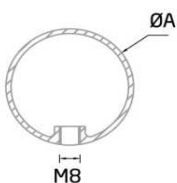

TF-504	$\varnothing A$
BA4BD73150P	50
BA4BD73170P	70

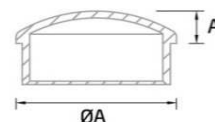

TF-505	$\varnothing A$	A
BA4TD70543P	43	9,5
BA4TD70550P	50,8	12

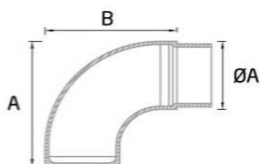

TF-506	$\varnothing A$	A	B
BA4TD70650P	50,8	83	80

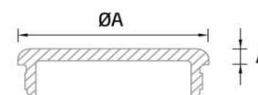

TF-507	$\varnothing A$	A
BA4TD70743P	43	4
BA4TD70750P	50,8	4

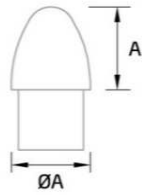

TF-508	ØA	A	
BA4TD70812P	12	14	

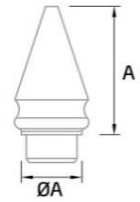

TF-509	ØA	A	
BA4TD70920P	20	46	

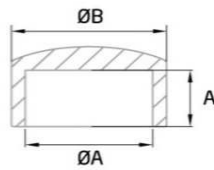

TF-510	ØA	A	
	12	6	

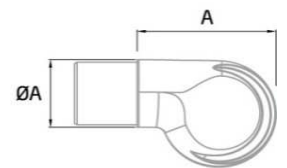

TF-511	ØA	A	
BA4TD70143P	43	81	

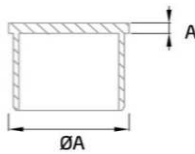

TF-512	ØA	A	
	42,4	3	

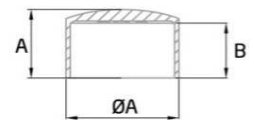

TF-513	ØA	A	
BA4TM70345P	45	30	

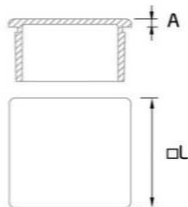

TF-530	□L	A	
BA4TD71120P	20x20	3	
BA4TD71130P	30x30	3	
BA4TD71140P	40x40	3	
BA4TD71150P	50x50	3	

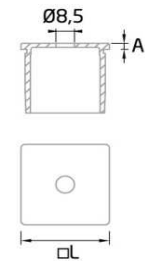

TF-533	□L	A	
BA4TD71440P	40x40	3	
BA4TD71450P	50x50	3	

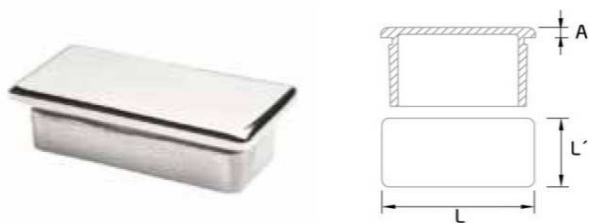

TF-535	L	L'	A
BA4TD71220P	20	10	3
BA4TD71240P	40	20	3

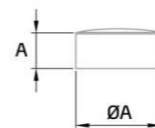

TF-590	ØA	A
	18	11
	21,5	12

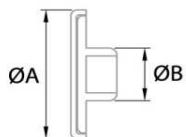

TF-595	ØA	ØB
	13	5